

607

007

Jackson County.

Township 38 S, Range 1 W.

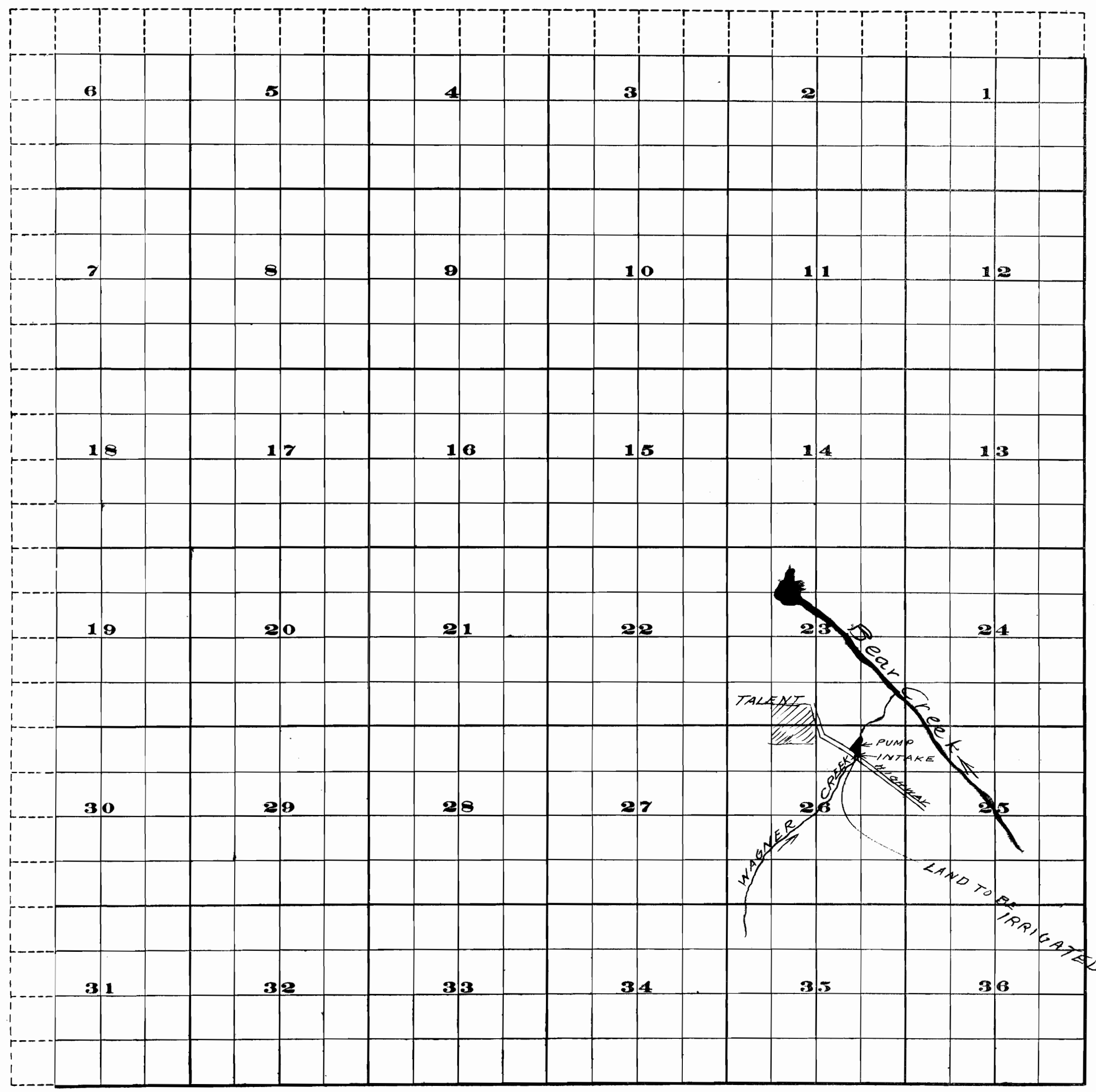

1760

0
1
2

FROM OFFICE OF THE STATE ENGINEER, SALEM, OREGON

OFFICE OF STATE ENGINEER
 RECEIVED
 OCT 26 1912
 SALEM, OREG.

Application No. 1760
 Permit No. 887

To accompany Application
 permit # 1760 by
 Elizabeth Breese.