

# CLAIM OF BENEFICIAL USE MAP

SECTION 24, T3S, R5W, WM, TAXLOT 104  
YAMHILL COUNTY, OREGON

APPLICATION # R-86049 (pond H)  
PERMIT # R-14077

PREPARED FOR:  
**Carlton Hills Vineyards, LLC**

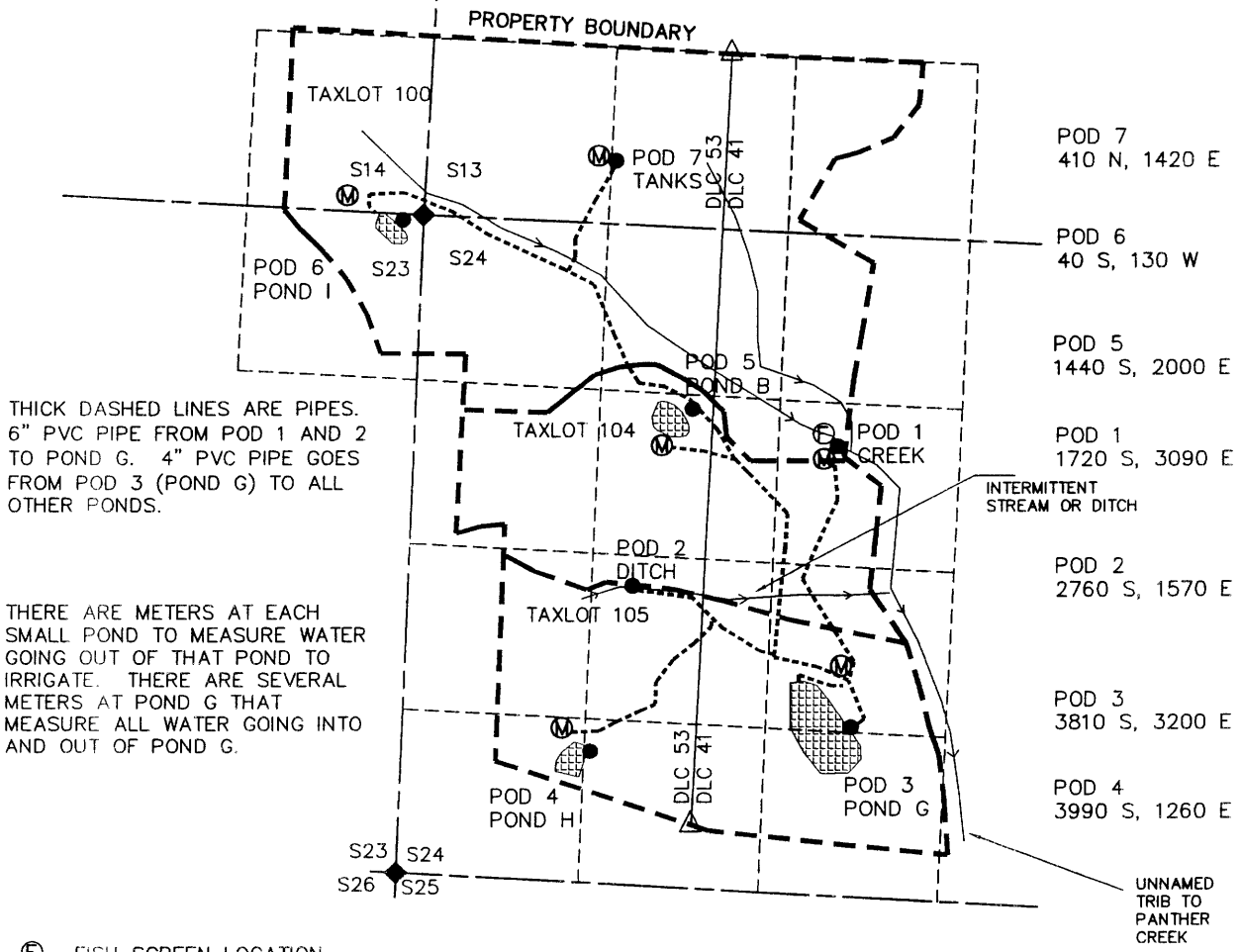

THICK DASHED LINES ARE PIPES.  
6" PVC PIPE FROM POD 1 AND 2  
TO POND G. 4" PVC PIPE GOES  
FROM POD 3 (POND G) TO ALL  
OTHER PONDS.

THERE ARE METERS AT EACH  
SMALL POND TO MEASURE WATER  
GOING OUT OF THAT POND TO  
IRRIGATE. THERE ARE SEVERAL  
METERS AT POND G THAT  
MEASURE ALL WATER GOING INTO  
AND OUT OF POND G.

- ⊕ FISH SCREEN LOCATION
- Ⓜ METER LOCATION
- ◆ SECTION CORNER
- ◆ POINT OF DIVERSION - POD
- △ DLC CORNER

NOTE: ALL COORDINATES FROM  
NW OF S24.

- POD 7  
410 N, 1420 E
- POD 6  
40 S, 130 W
- POD 5  
1440 S, 2000 E
- POD 1  
1720 S, 3090 E
- POD 2  
2760 S, 1570 E
- POD 3  
3810 S, 3200 E
- POD 4  
3990 S, 1260 E

THIS MAP WAS PREPARED FOR THE PURPOSE  
OF IDENTIFYING THE LOCATION OF A WATER  
RIGHT ONLY AND IS NOT INTENDED TO  
PROVIDE LEGAL DIMENSIONS OR LOCATION OF  
PROPERTY OWNERSHIP LINES.

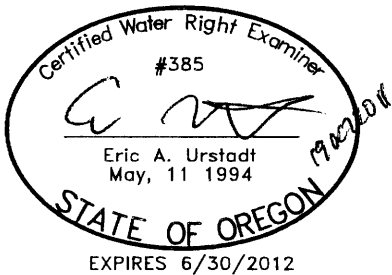
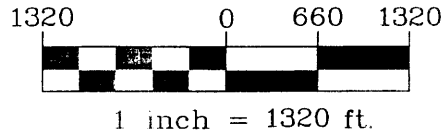

Project: 308-2-015  
Drawing: 3082015J-COBUMaps.dwg  
By: EAU  
Date: 19OCT2011