

# T13S R5W, W.M. FINAL PROOF SURVEY

This map is not intended to provide legal dimensions or locations of property ownership lines.

In the name of

## Gary Stockton

Application #S-84471



Permit #S-54490

Prepared by

Walter L. Trimmer

CWRE #332

*Trimmer Engineering Inc.*

3924 NW Walunt Place

Corvallis, OR 97330

541-754-2819

Scale 1" = 1320'

August 13, 2009

Layout: Stockton

File: Stahlbush.dwg

Based on USGS Peoria Quad

DWG 1 of 1

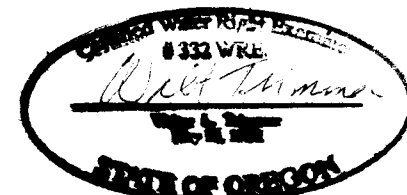

RENEW 6/30/2012

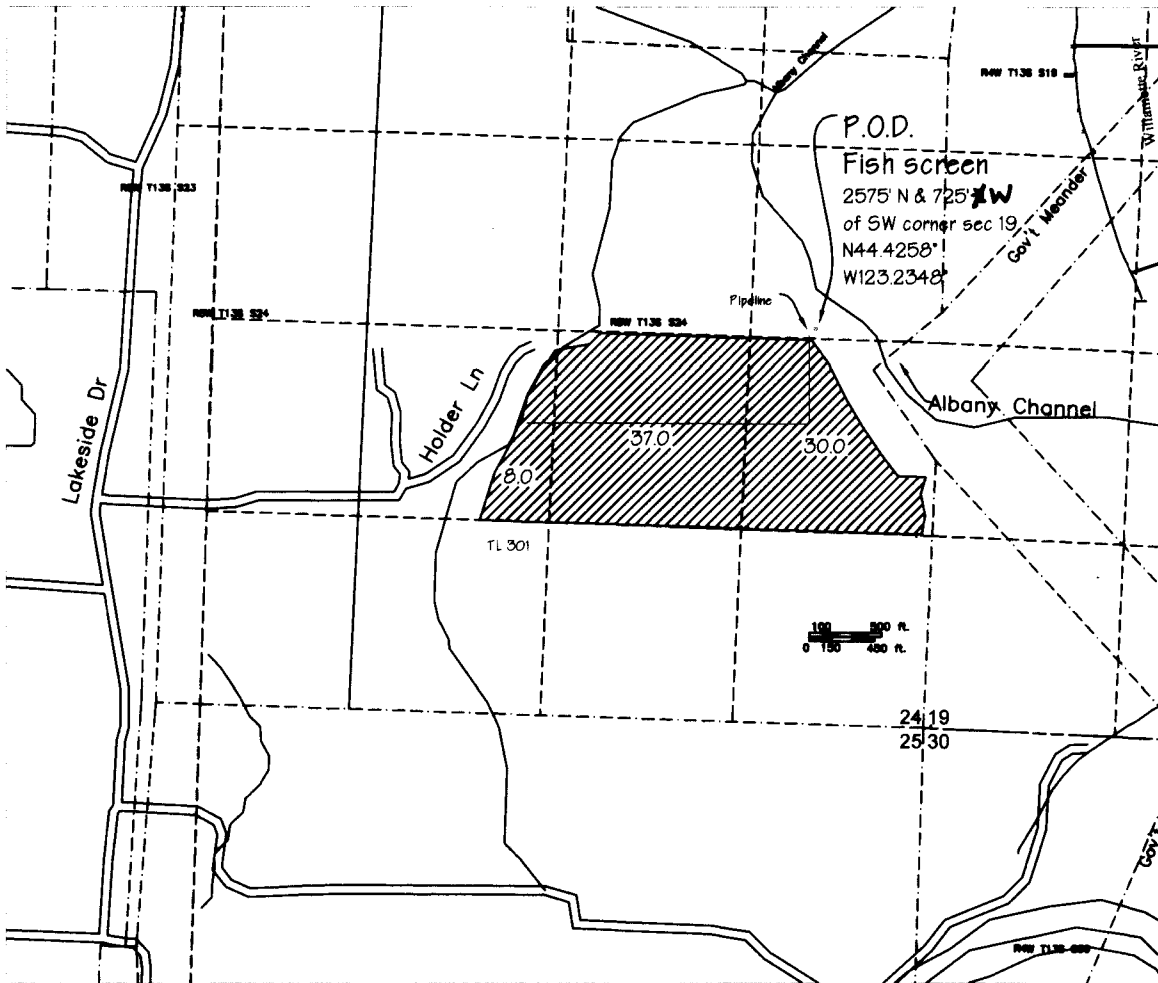

REVISED BY OWNED TO CORRECTLY SHOW  
COORDINATES OF THE POD. CNH 1/24/2017 WRD

WATER RESOURCES DEPT  
SALEM OREGON

WATER RESOURCES DEPT  
SALEM, OREGON

RECEIVED

MAY 01 2012

RECEIVED