

CLAIM OF BENEFICIAL USE MAP

FOR: CHRISTOPHER SCOTT

BY: NATHAN R. REED, P.E., CWRE

T26S, R3W, W.M. SECTION 10

APPLICATION NO. S-87037

PERMIT NO. S-54484

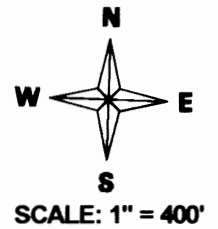

DATE SURVEYED: SEPTEMBER 24, 2016

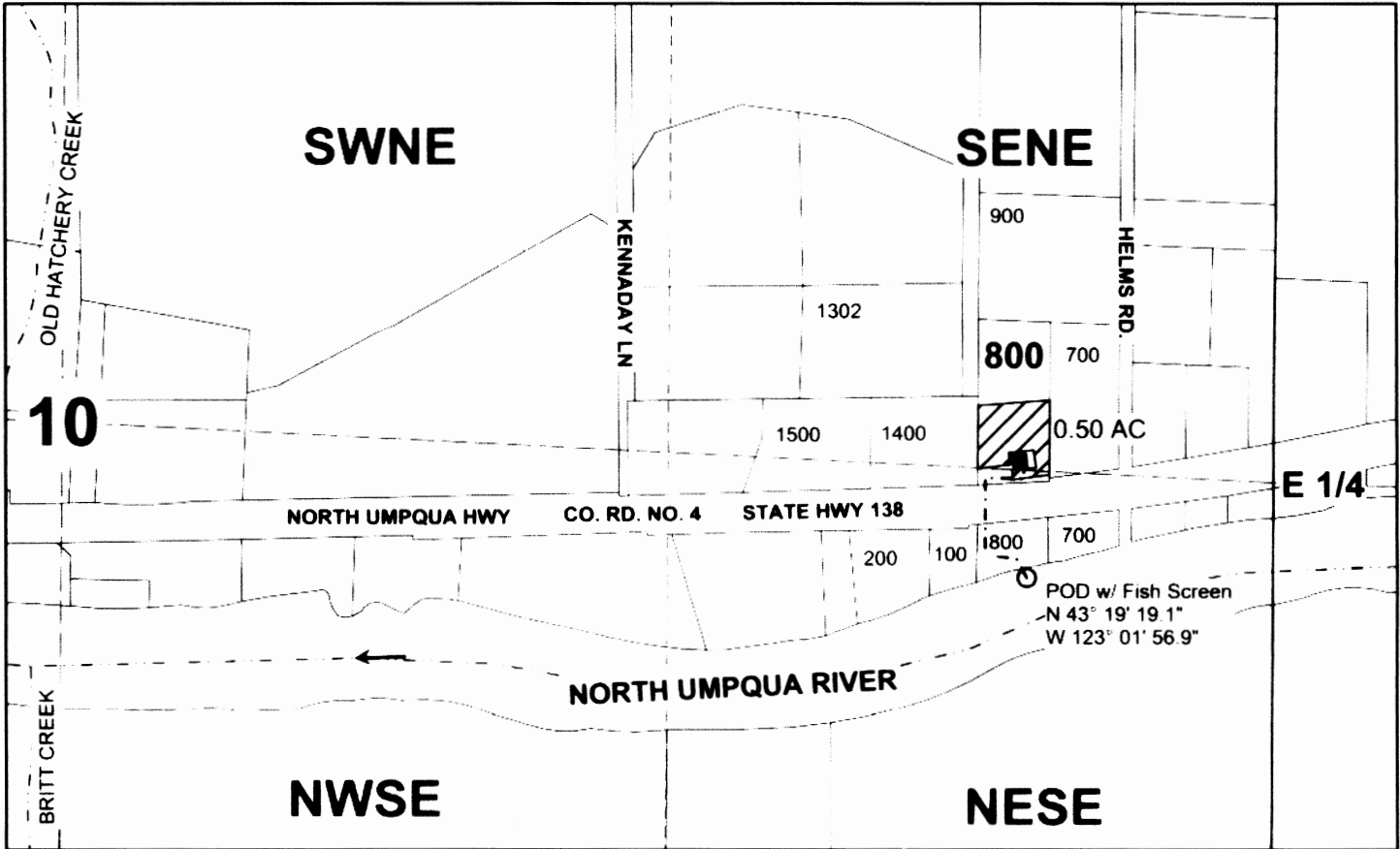

POD IS LOCATED 180 FEET SOUTH AND 530 FEET WEST FROM THE EAST 1/4 CORNER OF SECTION 10.

Legend

- | | | | |
|-------|------------|-----------|-----------|
| ○ | POD | □ | Section |
| ----- | Pipeline | - - - - - | Quarter |
| ■ | Structure | - - - - - | Sixteenth |
| ----- | Stream | □ | Parcels |
| → | Flow arrow | | |

RECEIVED BY OWRD

OCT 11 2016

SALEM, OR

MAP PREPARED FOR:
CHRISTOPHER SCOTT
14827 DOBBS AVE
BAKERSFIELD, OR 93314

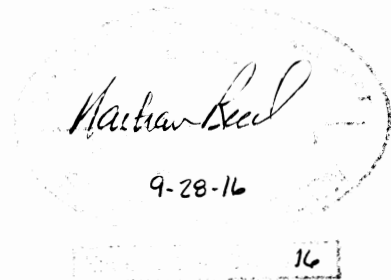

THE PURPOSE OF THIS MAP IS TO IDENTIFY THE LOCATION OF THE WATER RIGHT. IT IS NOT INTENDED TO PROVIDE INFORMATION RELATIVE TO THE LOCATION OF PROPERTY OWNERSHIP BOUNDARY LINES.

MAP PREPARED BY:
NATHAN R. REED, P.E., CWRE
1113 SE CASS AV
ROSEBURG, OR 97470