

T.6S., R.2W., W.M.

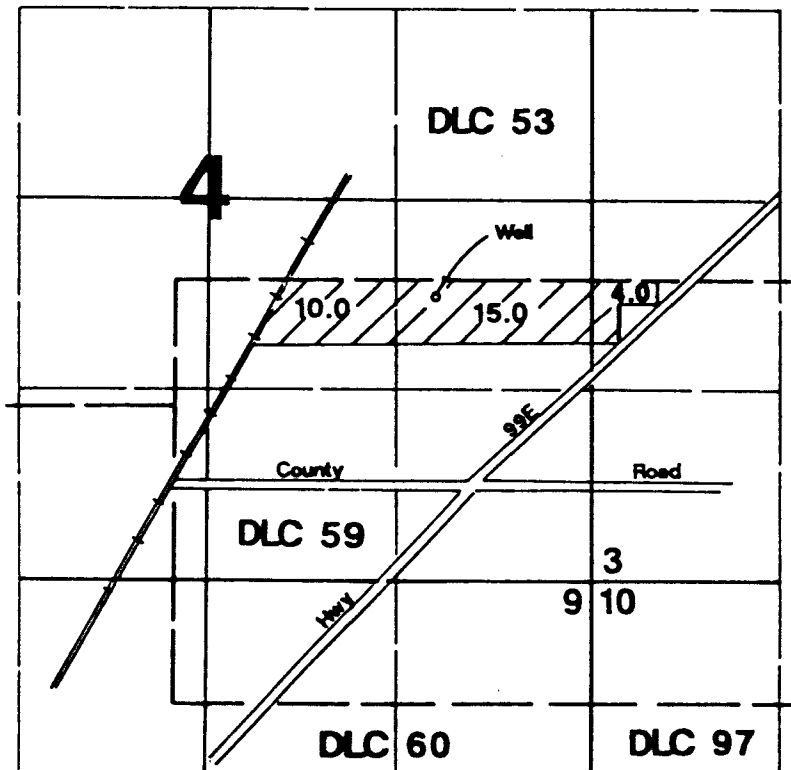

Well located 1960'N & 1060'W from SE corner Section 4.

Final Proof Survey

Application #: G-12787 Permit #: G-11512

RECEIVED

In Name Of

JUL 1 1996

Julian Ruiz

WATER RESOURCES DEPT.
SALEM, OREGON

Surveyed on March 21, 1996 by JM Schuette

THIS MAP WAS PREPARED FOR THE PURPOSE OF IDENTIFYING THE LOCATION OF A WATER RIGHT ONLY AND IS NOT INTENDED TO PROVIDE LEGAL DIMENSIONS OR LOCATION OF PROPERTY OWNERSHIP LINES.

