

T.7S. R.4W. W.M.  
POLK COUNTY

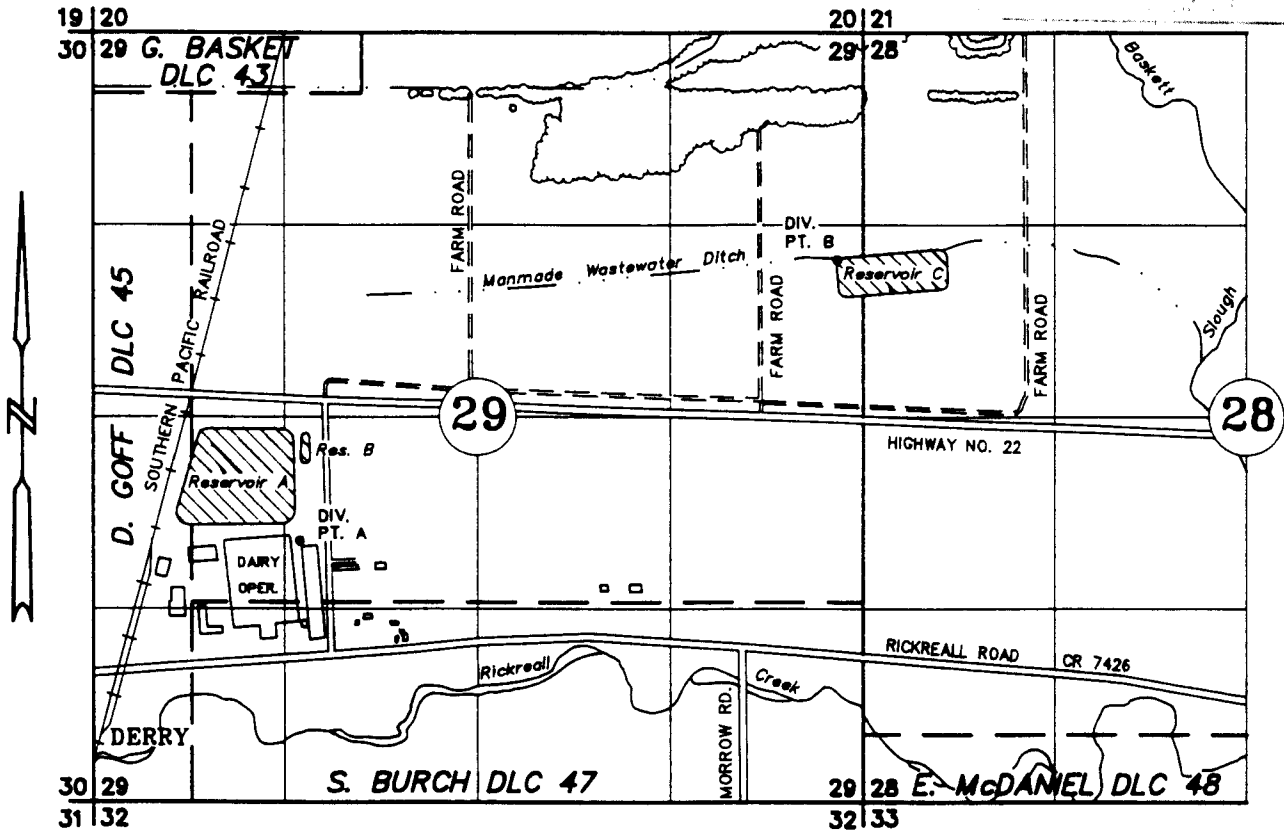
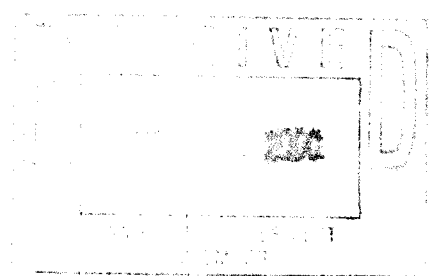

DIV. PT. A: 425' NORTH AND 745' EAST FROM NW COR OF S. BURCH DLC NO. 47  
 DIV. PT. B: 2350' NORTH AND 1805' WEST FROM NE COR OF S. BURCH DLC NO. 47  
 175'

Secondary Use Application No. S-80537, Permit no. S-53034

**FINAL PROOF SURVEY**  
UNDER

Application No. R-80536 Permit No. R-12122

IN THE NAME OF

**RICKREALL DAIRY, L.L.C.**

SEPTEMBER 13, 1999  
SCALE 1" = 1320'

NOTE: This map is for the purpose of identifying the location of water rights and has no intent to dimension or locate property ownership lines.



*This map has been revised by OWRD to reflect the measured distance for DIV PT B as 175' West. 1-20-15*