

39 E  
T.8S., R. ~~38~~E., W.M.

RECEIVED

AUG - 5 1996  
WATER RESOURCES DEPT.  
SALEM, OREGON

SCALE 1" = 1320'

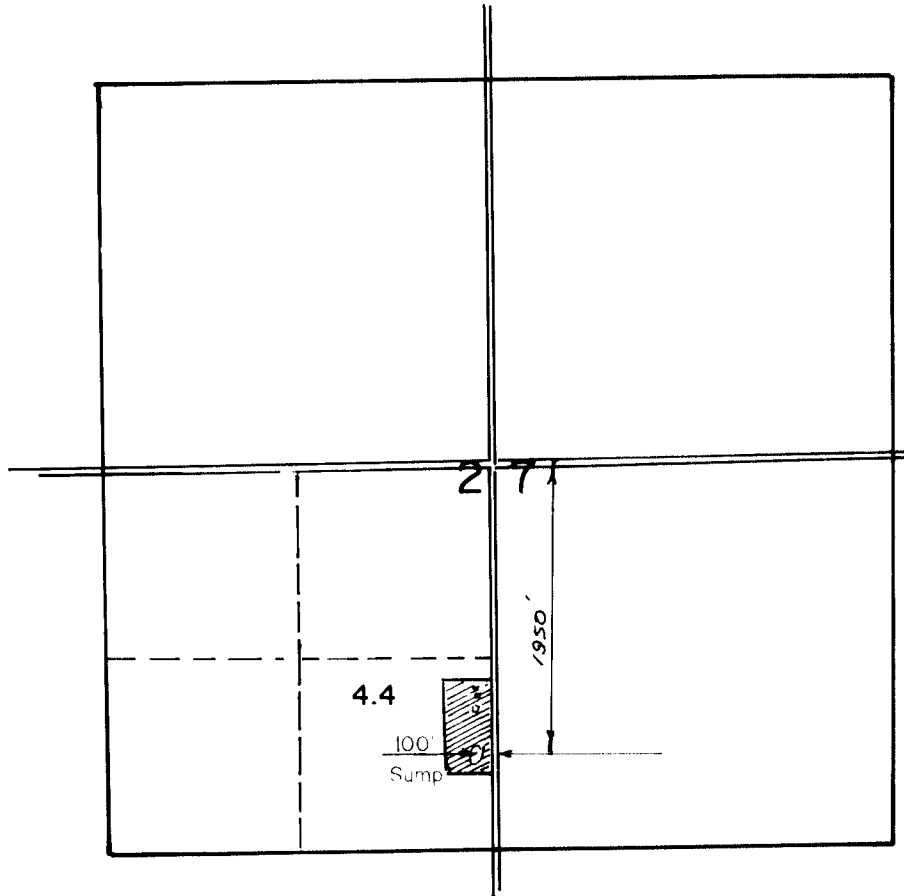

THE PURPOSE OF THIS MAP IS FOR IDENTIFYING THE LOCATION OF THE WATER RIGHT ONLY AND IS NOT INTENDED TO PROVIDE LEGAL DIMENSIONS OF PROPERTY OWNERSHIP LINES.

FINAL PROOF SURVEY  
UNDER

Application No. G-11890 . . . Permit No. G-11040 . . .  
IN NAME OF

..... GLENABELL M. LEWIS .....

Surveyed JULY 2, 1994

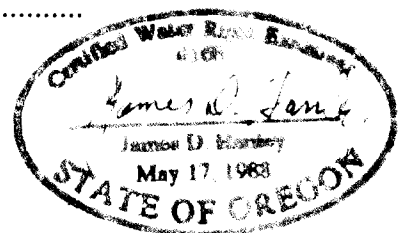

Map Revised to reflect Range 39 E. MfB/wrd 10-28-16