

# TRANSFER APPLICATION MAP MAP 1 OF 2 TRANSFER FROM

CERTIFICATES: 35454, 43742, 49118, 49020, 61946 & 91507  
Township 26 & 27 South, Range 6 West, W.M.  
Douglas County, Oregon

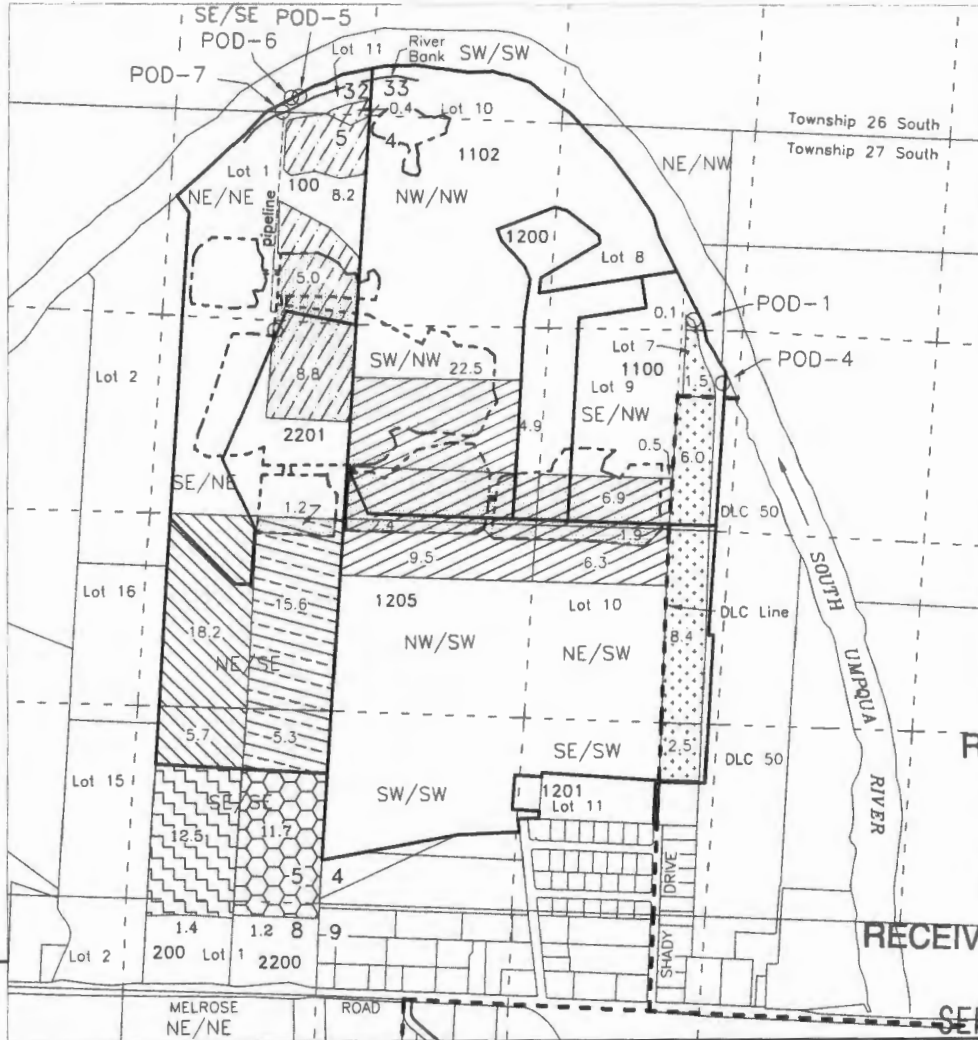

RECEIVED BY OWRD

SEP 19 2016

SALEM, OR

RECEIVED BY OWRD

Scale

SEP 30 2016 1:320'

For purpose of locating POD's, Cardinal directions are in reference from point of beginning extending along section or DLC boundary lines

APPLICANT

GUIDO LAND & EQUIPMENT CO., LLC  
640 SHADY DRIVE  
ROSEBURG, OR 97471

CALLAHAN RIDGE, LLC  
& 640 SHADY DRIVE  
ROSEBURG, OR 97471

SALEM, OR

AUTHORIZED POD

TL-200 & 2200 { Guido Rentals, LLC  
3077 Garden Valley Road  
Roseburg, OR 97471

POD #	TRANSFER		
	Use PI Use (A)POD	Rem. Right	APOD Only
○ 4	18.5		
○ 1	21.2	33.7	
○ 5	8.6	13.8	
○ 6	20.9	1.2	12.9
○ 7	23.9		13.9

POD-4 - Lot 7 (SE/NW) Section 4, 4330 ft. N. & 300 ft. E. from Interior corner on west boundary of McKinney DLC 50 (C-35454, C-91507)

POD-1 - Lot 7 (NE/NW) Section 4, 1300 ft. S & 2380 ft. E. from the NW corner Section 4 (C-43742)

POD-5 - SE/SE Section 32, 110 ft. N. & 490 ft. W. from the SE corner of Section 32 (C-49118)

POD-6 - SE/SE Section 32, 100 ft. N. & 540 ft. W. from the SE corner of Section 32 (C-49020)

POD-7 - Lot 1 (NE/NE) Section 5, 600 ft. W. from the NE corner Section 5 (C-61946)

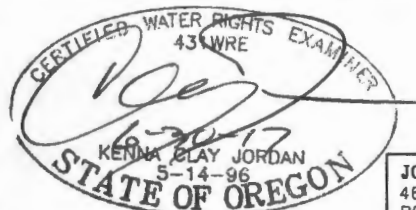

JORDAN ENGINEERING  
460 JORDAN LANE  
ROSEBURG, OR 97471  
(541) 673-1931

Rev. 8/26/2014 n.e.d.  
Rev. 4/8/2015 n.e.d.  
Rev. 5/28/2015 n.e.d.  
Rev. 8/11/2015 n.e.d.  
Rev. 8/29/2016 n.e.d.  
Rev. 8/3/2016 n.e.d.

This map is not intended to provide legal dimensions or locations of property ownership lines

Base Map: Douglas County GIS data with May 2014 Oregon Map aerial photo overlay for assumed best fit

T 12496

Revised map T-12496  
11/17/2016

# TRANSFER APPLICATION MAP MAP 1 OF 2 TRANSFER FROM

*FR*

CERTIFICATES: 35454, 43742, 49118, 49020, 61946 & 91507  
Township 26 & 27 South, Range 6 West, W.M.  
Douglas County, Oregon

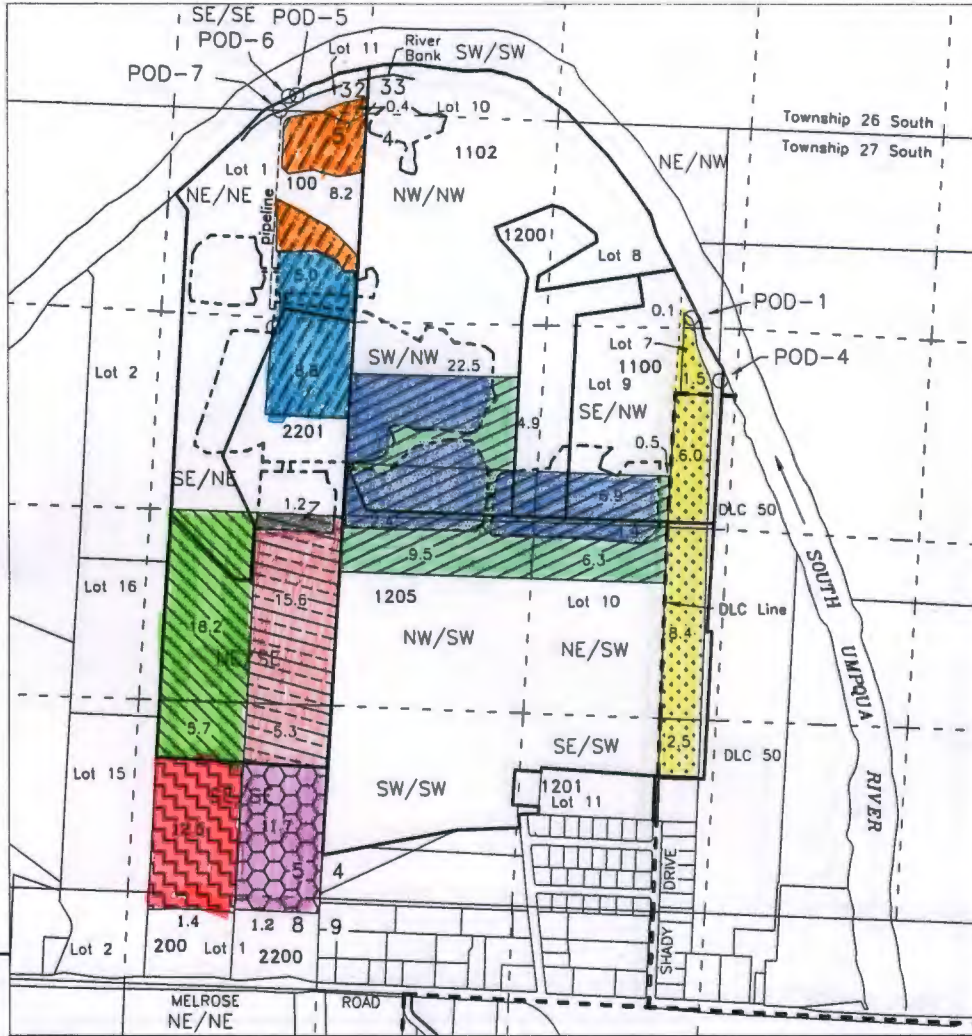

RECEIVED  
NOV 28 2016  
CWRD  
SALEM, OREGON

For purpose of locating POD's, Cardinal directions are in reference from point of beginning extending along section or DLC boundary lines

Scale  
1" = 1320'

POD #	TRANSFER			APOD Only	AUTHORIZED POD	TL-200 & 2200 { Guido Rentals, LLC 3077 Garden Valley Road Roseburg, OR 97471	
	Use PI Use (A)POD	Rem. Right	APOD Only				
04	18.5				POD-4 - Lot 7 (SE/NW) Section 4, 4330 ft. N. & 300 ft. E. from interior corner on west boundary of McKinney DLC 50 (C-35454, C-91507)	CALLAHAN RIDGE, LLC & 640 SHADY DRIVE ROSEBURG, OR 97471	
01	21.2	33.7			POD-1 - Lot 7 (NE/NW) Section 4, 1315 ft. S & 2315 ft. E. from the NW corner Section 4 (C-43742)		
05	8.6	13.8			POD-5 - SE/SE Section 32, 110 ft. N. & 490 ft. W. from the SE corner of Section 32 (C-49118)		
06	20.9	12.2	12.9		POD-6 - SE/SE Section 32, 100 ft. N. & 540 ft. W. from the SE corner of Section 32 (C-49020)		
07	23.9		11.1		POD-7 - Lot 1 (NE/NE) Section 5, 600 ft. W. from the NE corner Section 5 (C-61946)		
APPLICANT GUIDO LAND & EQUIPMENT CO., LLC 640 SHADY DRIVE ROSEBURG, OR 97471					CALLAHAN RIDGE, LLC & 640 SHADY DRIVE ROSEBURG, OR 97471		
This map is not intended to provide legal dimensions or locations of property ownership lines					Base Map: Douglas County GIS data with May 2014 Oregon Map aerial photo overlay for assumed best fit		

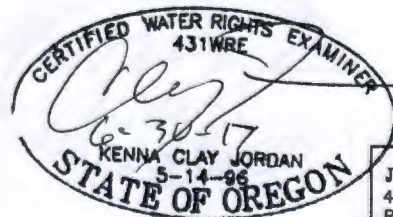

JORDAN ENGINEERING  
460 JORDAN LANE  
ROSEBURG, OR 97471  
(541) 673-1931  
Rev. 8/26/2014 n.e.d.  
Rev. 4/6/2015 n.e.d.  
Rev. 5/26/2015 n.e.d.  
Rev. 8/11/2015 n.e.d.  
Rev. 6/29/2016 n.e.d.  
Rev. 8/3/2016 n.e.d.  
Rev. 11/17/2016 n.e.d.