

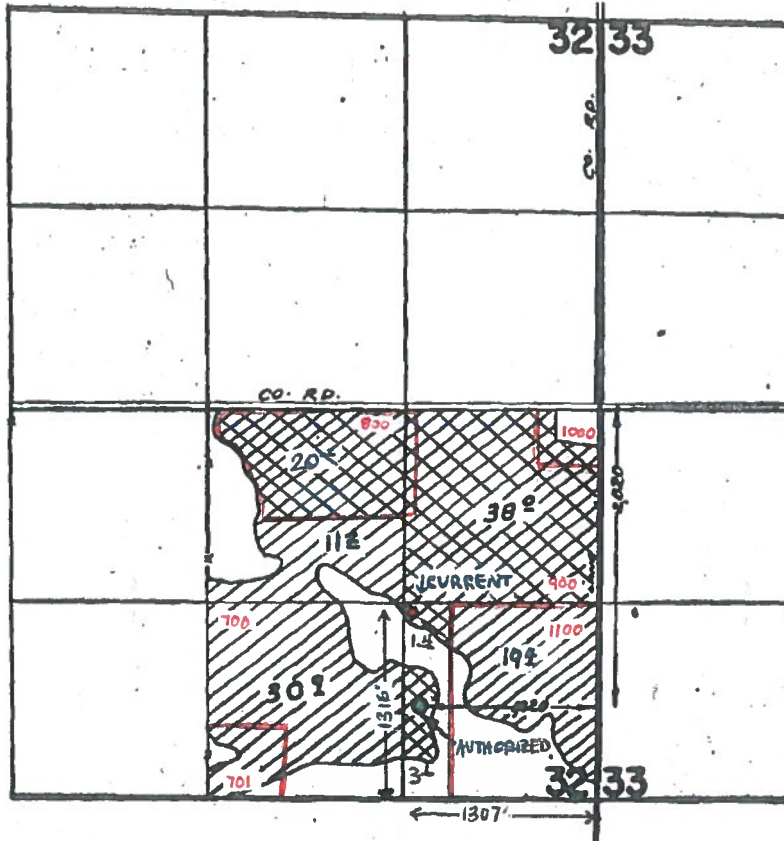



Q 3465  
C-38346 11

# T. 40S.R.10E.W.M.

East River Wells



-  T-12504 (62 1/2)
-  REMAINING (61 1/2)
-  TAX LOT

1" = 1320'

- AUTHORIZED: 2020' S AND 1220' W FROM E 1/4 CORNER, SECTION 32
- CURRENT: 1316' N AND 1307' W FROM SE CORNER, SECTION 32

## FINAL PROOF SURVEY UNDER

Application No. G-2271 Permit No. G-3465  
IN NAME OF

VERNON M. GEARHARD

Surveyed SEPT. 12 1971 by R. MUCKEN