

T. 37 S., R. 10 E., W. M.

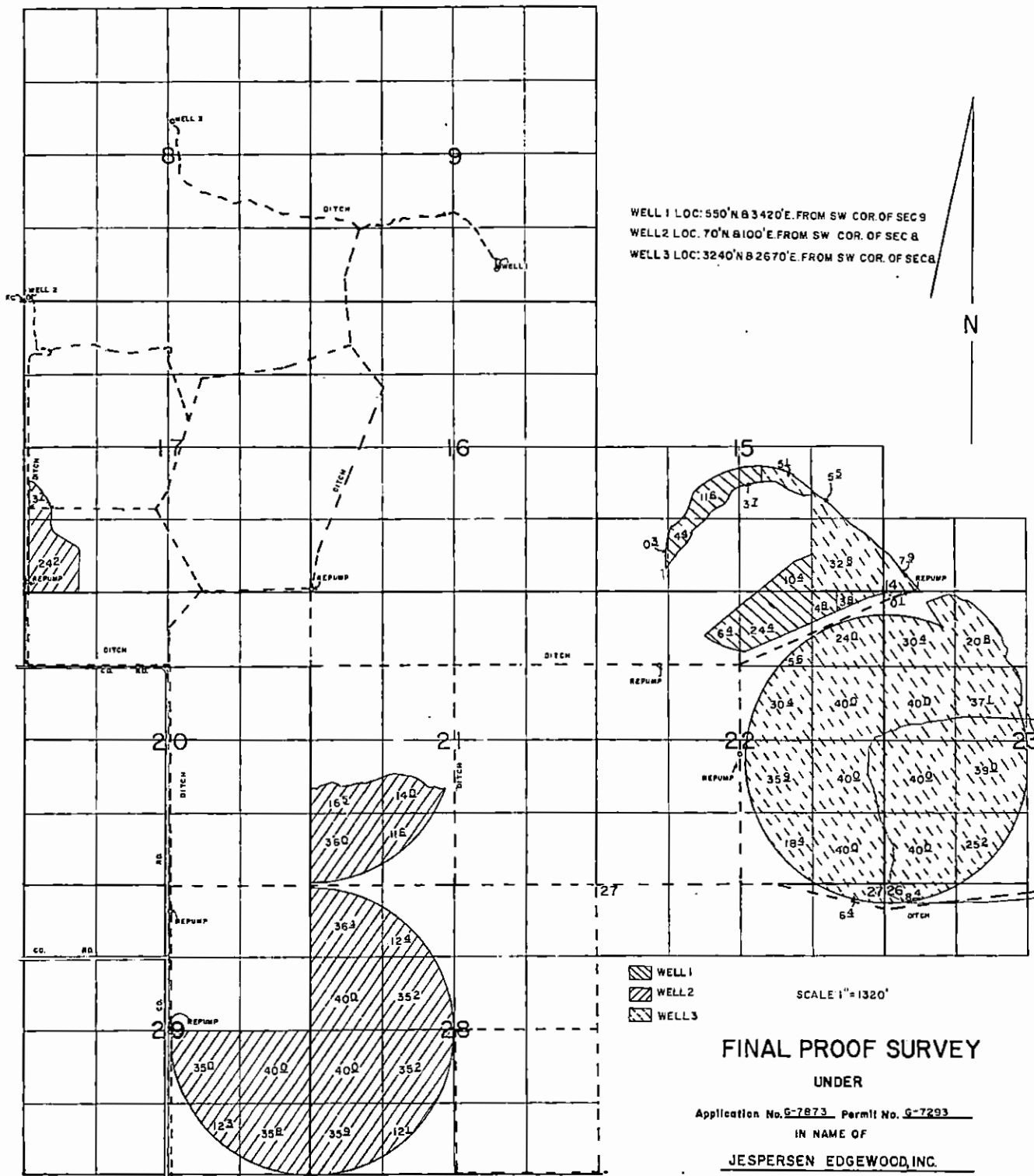

WELL 1 LOC: 550' N 83420' E. FROM SW COR. OF SEC 9
 WELL 2 LOC: 70' N 8100' E. FROM SW COR. OF SEC 8
 WELL 3 LOC: 3240' N 2670' E. FROM SW COR. OF SEC 8

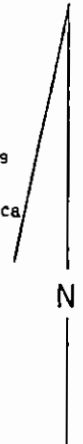

- WELL 1
- WELL 2
- WELL 3

SCALE 1" = 1320'

FINAL PROOF SURVEY
 UNDER

Application No. 9-7873 Permit No. 5-7293
 IN NAME OF
JESPERSEN EDGEWOOD, INC.

Surveyed, MAY 21, 22 19 91, by B. W. BISHOP

#122

0114