

# Walla Walla River Irrigation District

## 3201 Water Rights Map

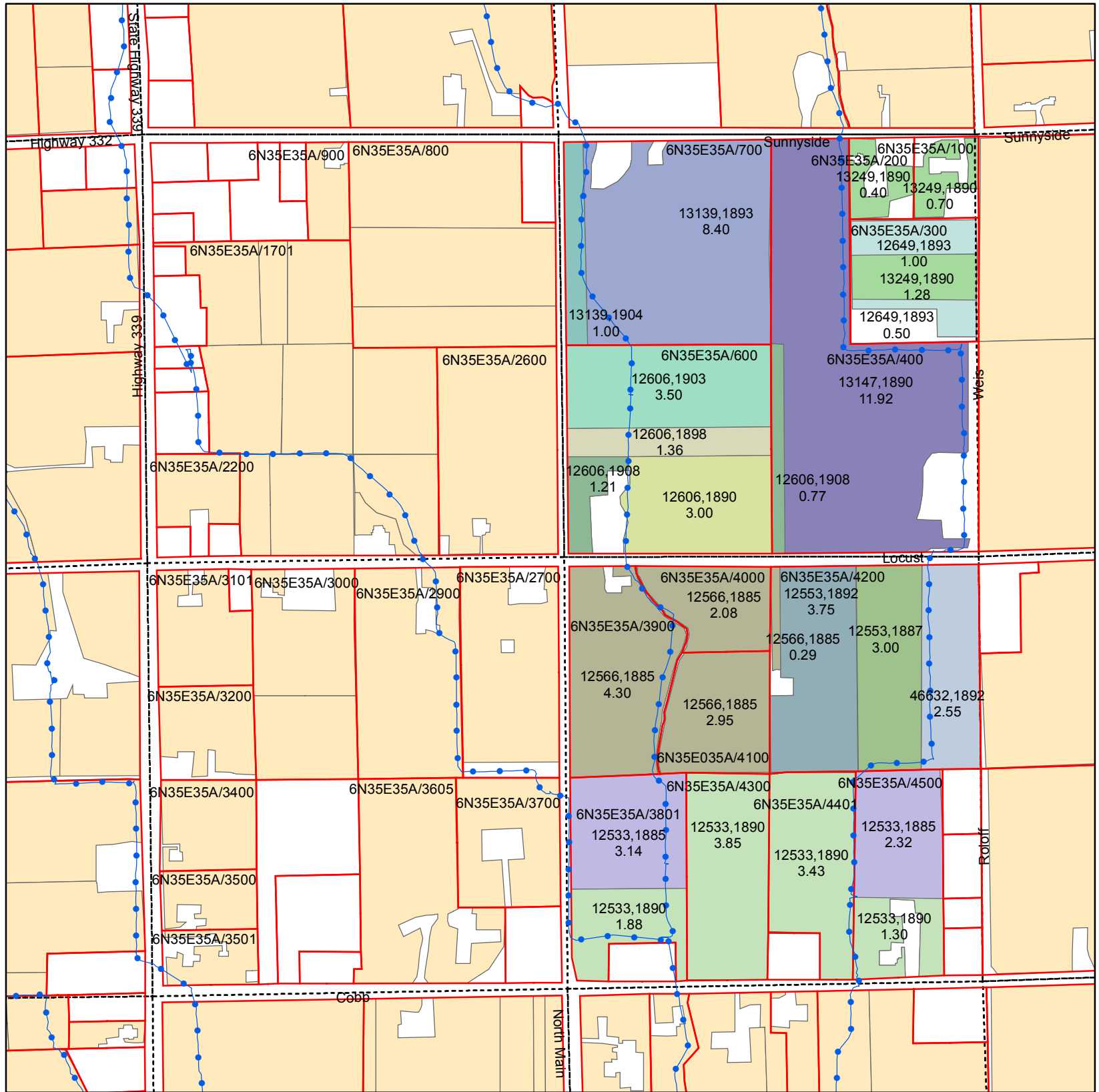

### T6N R35E WM Section 35 E1/2 NE Quarter



#### Primary Certificates

#### CERTIFICATE, PRIORITY

- 12533, 1885
- 12533, 1890
- 12553, 1887
- 12553, 1892
- 12566, 1885
- 12606, 1890
- 12606, 1898
- 12606, 1903
- 12606, 1908
- 12649, 1893
- 13139, 1893
- 13139, 1904
- 13147, 1890
- 13249, 1890
- 46632, 1892
- Water Rights Not Within Quarter

ASSESSORMAP	CERTIFICATE	PRIORITY	QQ	WR ACRES
6N35E35A/100	13249	1890	NENE	0.70
6N35E35A/200	13249	1890	NENE	0.40
6N35E35A/300	13249	1890	NENE	1.28
6N35E35A/300	12649	1893	NENE	1.00
6N35E35A/300	12649	1893	NENE	0.50
6N35E35A/3801	12533	1885	SENE	3.14
6N35E35A/3801	12533	1890	SENE	1.88
6N35E35A/3900	12566	1885	SENE	4.30
6N35E35A/400	13147	1890	NENE	11.92
6N35E35A/400	12606	1908	NENE	0.77
6N35E35A/4000	12566	1885	SENE	2.08
6N35E35A/4100	12566	1885	SENE	2.95
6N35E35A/4200	46632	1892	SENE	2.55
6N35E35A/4200	12553	1887	SENE	3.00
6N35E35A/4200	12553	1892	SENE	3.75
6N35E35A/4200	12566	1885	SENE	0.29
6N35E35A/4300	12533	1890	SENE	3.85
6N35E35A/4401	12533	1890	SENE	3.43
6N35E35A/4500	12533	1885	SENE	2.32
6N35E35A/4500	12533	1890	SENE	1.30
6N35E35A/600	12606	1903	NENE	3.50
6N35E35A/600	12606	1898	NENE	1.36
6N35E35A/600	12606	1890	NENE	3.00
6N35E35A/600	12606	1908	NENE	1.21
6N35E35A/700	13139	1893	NENE	8.40
6N35E35A/700	13139	1904	NENE	1.00

#### Legend

- PIPE
- Parcel
- QCDB
- WWRID Boundary

0 400 800 Feet

Date March 2011

# Walla Walla River Irrigation District

## 3201 Water Rights Map

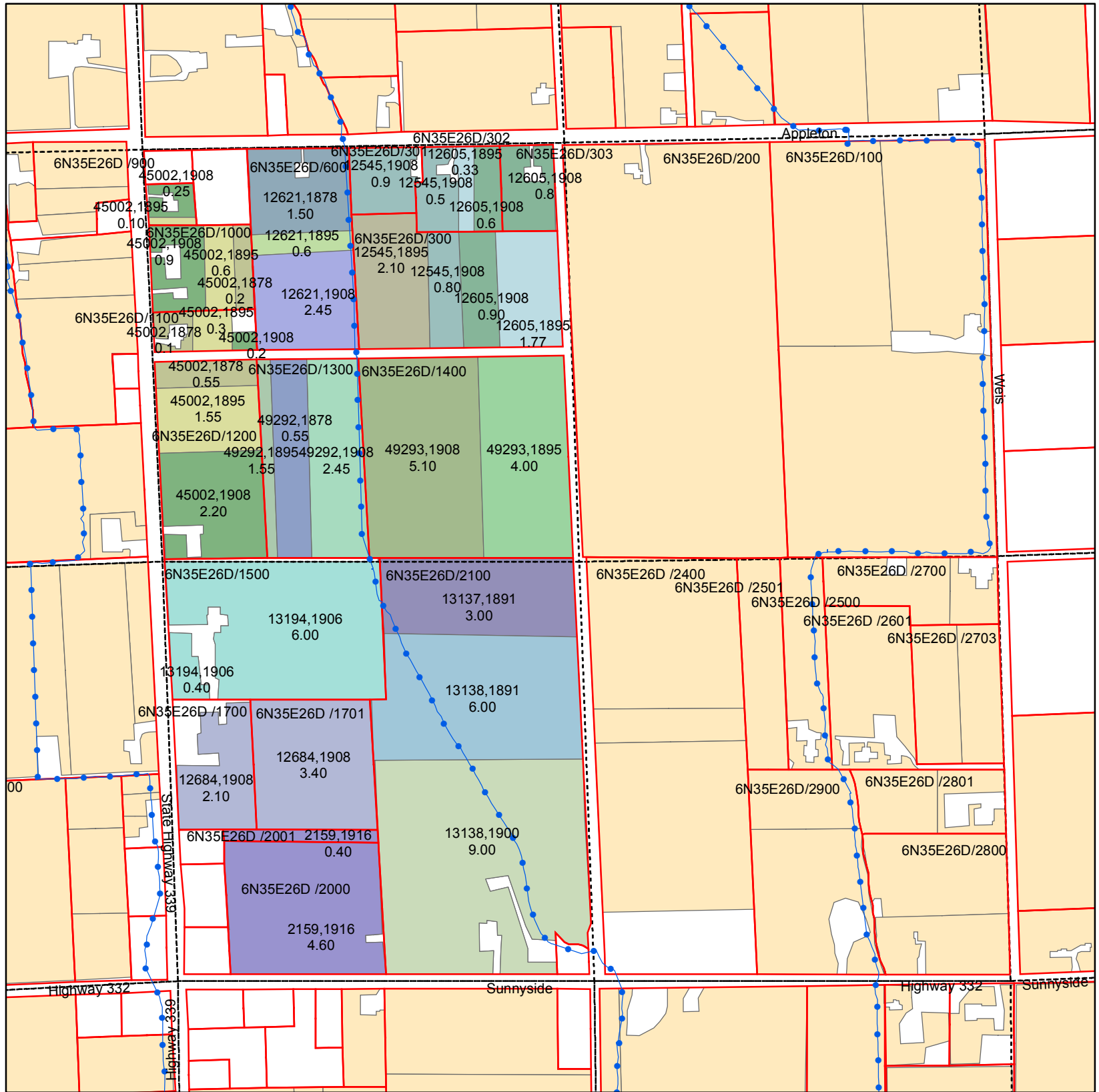

### Primary Certificates T6N R35E WM Section 26 W1/2 SE Quarter

#### CERTIFICATE, PRIORITY

- 12545, 1895
- 12545, 1908
- 12605, 1895
- 12605, 1908
- 12621, 1878
- 12621, 1895
- 12621, 1908
- 12684, 1908
- 13137, 1891
- 13138, 1891
- 13138, 1900
- 13194, 1906
- 2159, 1916
- 45002, 1878
- 45002, 1895
- 45002, 1908
- 49292, 1878
- 49292, 1895
- 49292, 1908
- 49293, 1895
- 49293, 1908
- Water Rights Not Within Quarter

6N35E26D/1000	45002	1878	NWSE	0.20
6N35E26D/1000	45002	1895	NWSE	0.60
6N35E26D/1000	45002	1908	NWSE	0.90
6N35E26D/1100	45002	1895	NWSE	0.30
6N35E26D/1100	45002	1908	NWSE	0.20
6N35E26D/1100	45002	1878	NWSE	0.10
6N35E26D/1200	45002	1878	NWSE	0.55
6N35E26D/1200	45002	1895	NWSE	1.55
6N35E26D/1200	45002	1908	NWSE	2.20
6N35E26D/1300	49292	1878	NWSE	0.55
6N35E26D/1300	49292	1908	NWSE	2.45
6N35E26D/1300	49292	1895	NWSE	1.55
6N35E26D/1400	49293	1908	NWSE	5.10
6N35E26D/1400	49293	1895	NWSE	4.00
6N35E26D/1500	13194	1906	SWSE	0.40
6N35E26D/1500	13194	1906	SWSE	6.00
6N35E26D/1700	12684	1908	SWSE	2.10
6N35E26D/1701	12684	1908	SWSE	3.40
6N35E26D/2000	2159	1916	SWSE	4.60
6N35E26D/2001	2159	1916	SWSE	0.40
6N35E26D/2100	13138	1900	SWSE	9.00
6N35E26D/2100	13137	1891	SWSE	3.00
6N35E26D/2100	13138	1891	SWSE	6.00
6N35E26D/300	12545	1895	NWSE	2.10
6N35E26D/300	12605	1908	NWSE	0.90
6N35E26D/300	12605	1895	NWSE	1.77
6N35E26D/300	12545	1908	NWSE	0.80
6N35E26D/301	12545	1908	NWSE	0.90
6N35E26D/302	12605	1908	NWSE	0.60
6N35E26D/302	12605	1895	NWSE	0.33
6N35E26D/302	12545	1908	NWSE	0.50
6N35E26D/303	12605	1908	NWSE	0.80
6N35E26D/600	12621	1895	NWSE	0.60
6N35E26D/600	12621	1878	NWSE	1.50
6N35E26D/900	45002	1895	NWSE	0.10
6N35E26D/900	45002	1908	NWSE	0.25

#### Legend

- PIPE
- Parcel
- QCDB
- WWRID Boundary



0 400 800 Feet

Date March 2011