

CLAIM OF BENEFICIAL USE MAP UNDER PERMIT S-52941

T 40 S, R 8 W, WM, JOSEPHINE COUNTY

Section 25 - E1/2 SW1/4

July 8, 2011

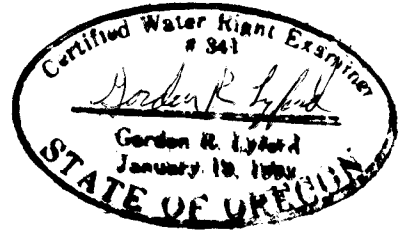
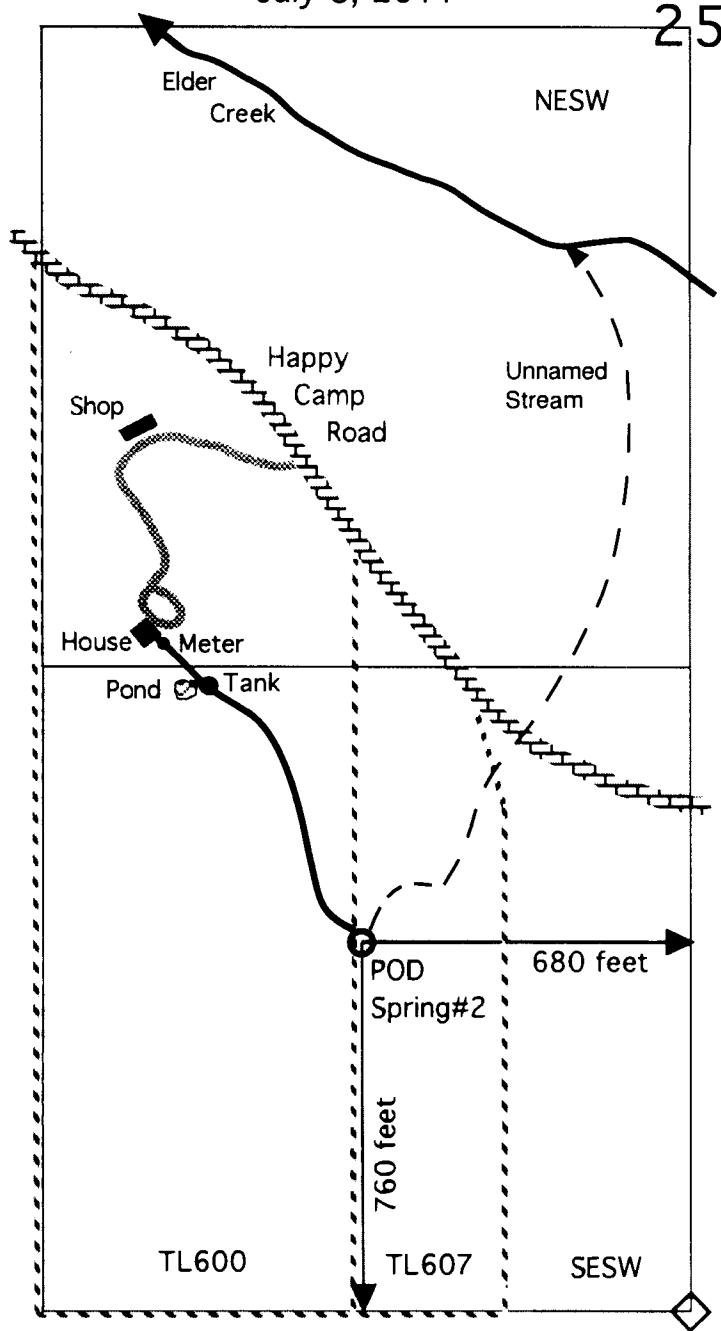

7-8-2011

exp 12-31-2012

Application S-80758 and Permit S-52941 with a priority of December 20, 1995

- Above ground 2500 gallon tank
- ~ Above ground 2 inch, 1 inch, and 1/2 inch diameter PVC pipe from spring #2 to the house
- ◆ Household and place of use
- ~ Driveway
- ☒ Pond P#80689 under HB2376

This map was drawn by Gordon R. Lyford for Katrina Garnier to support her claim of beneficial use of water for domestic use and human consumption from a spring. Katrina Garnier owns tax lot 600.

This map was prepared for the purpose of identifying the location of water rights only and is not intended to provide legal dimensions or the location of property ownership lines.