

979

COBU MAP 979

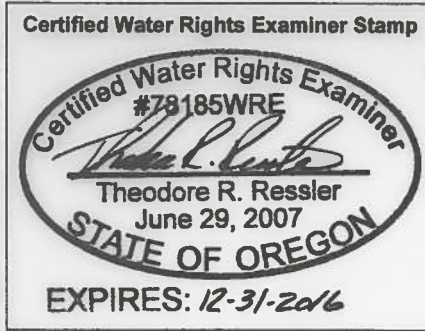

RECEIVED BY OWRD
FEB 1-6 2016
SALEM, OR

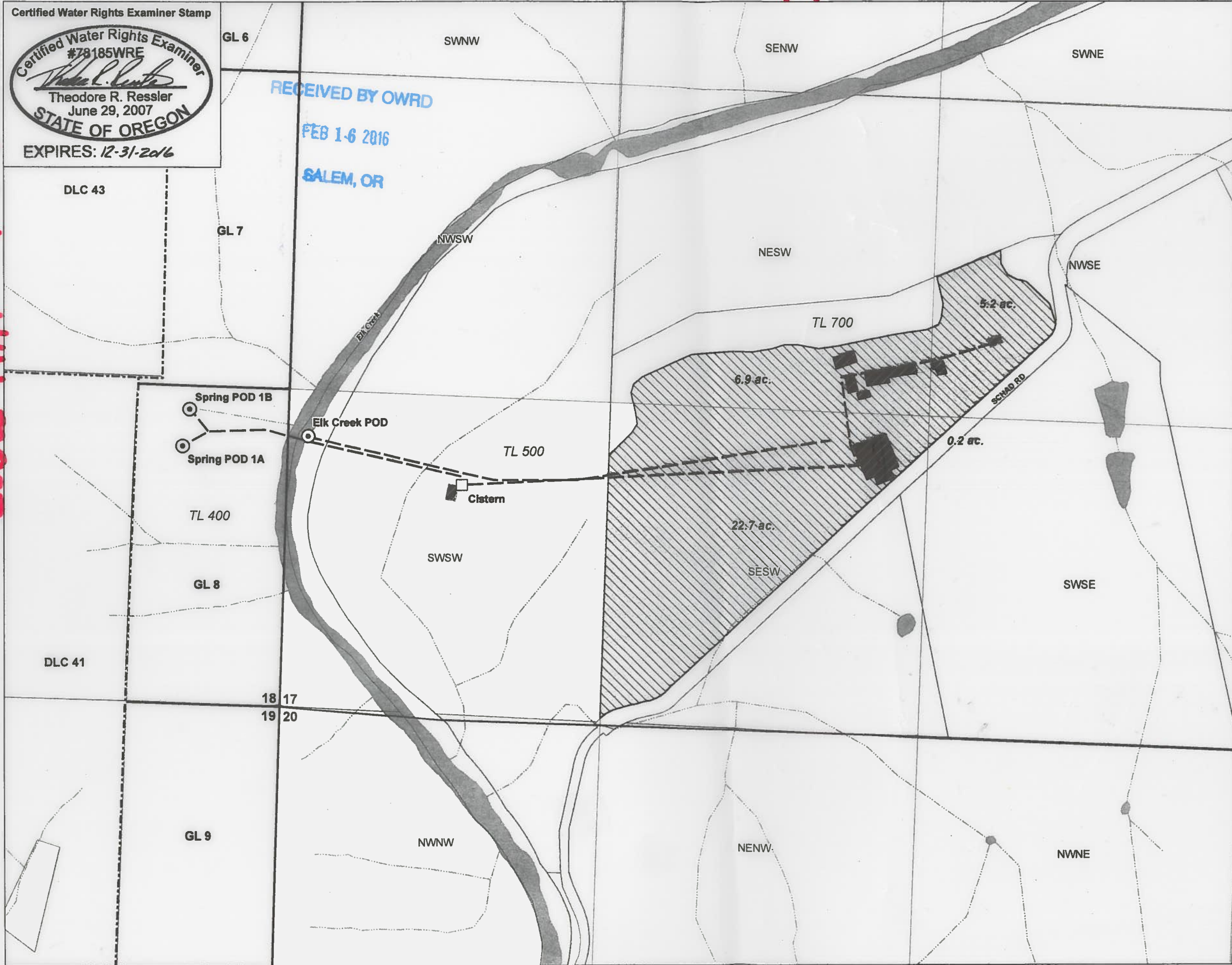

Claim of Beneficial Use
Permit S-44863 (Application S-59559)
Water Right in the Name of
Elk Creek Farms, LLC
Douglas County
Township 22 South, Range 7 West (W.M.)

- LEGEND**
- ⊙ Point of Diversion (POD)
 - Cistern
 - - Mainline
 - Place of Use (POU)**
 - ▨ Creek Source, 35 ac.
 - Spring Source
 - All Other Features**
 - ⊕ Tax Lot
 - ⊞ Donation Land Claim (DLC)
 - ⊞ Government Lot (GL)
 - ☾ Waterbody
 - ~ Watercourse

POD LOCATION DESCRIPTIONS

Spring POD 1A
Located 1,085 feet North and 435 feet West from the SE corner of Section 18, Township 22 South, Range 7 West (W.M.)

Spring POD 1B
Located 1,220 feet North and 410 feet West from the SE corner of Section 18, Township 22 South, Range 7 West (W.M.)

Elk Creek POD
Located 1,120 feet North and 85 feet East from the SW corner of Section 17, Township 22 South, Range 7 West (W.M.)

DISCLAIMER
This map was prepared for the purpose of identifying the location of a water right only and it is not intended to provide legal dimensions or location of property ownership lines.

N

0 200 400 600
1 inch = 400 feet

MAP NOTES:
Date: January 6, 2018
Data Sources: Douglas Co, BLM, USGS

GSI
Water Solutions, Inc.

Application for a Water Right Transfer in the Name of Elk Creek Farm, LLC

Certificate 91522, Permit S-44863, Application S-59559
Douglas County, Oregon
Township 22 South, Range 7 West (W.M.)

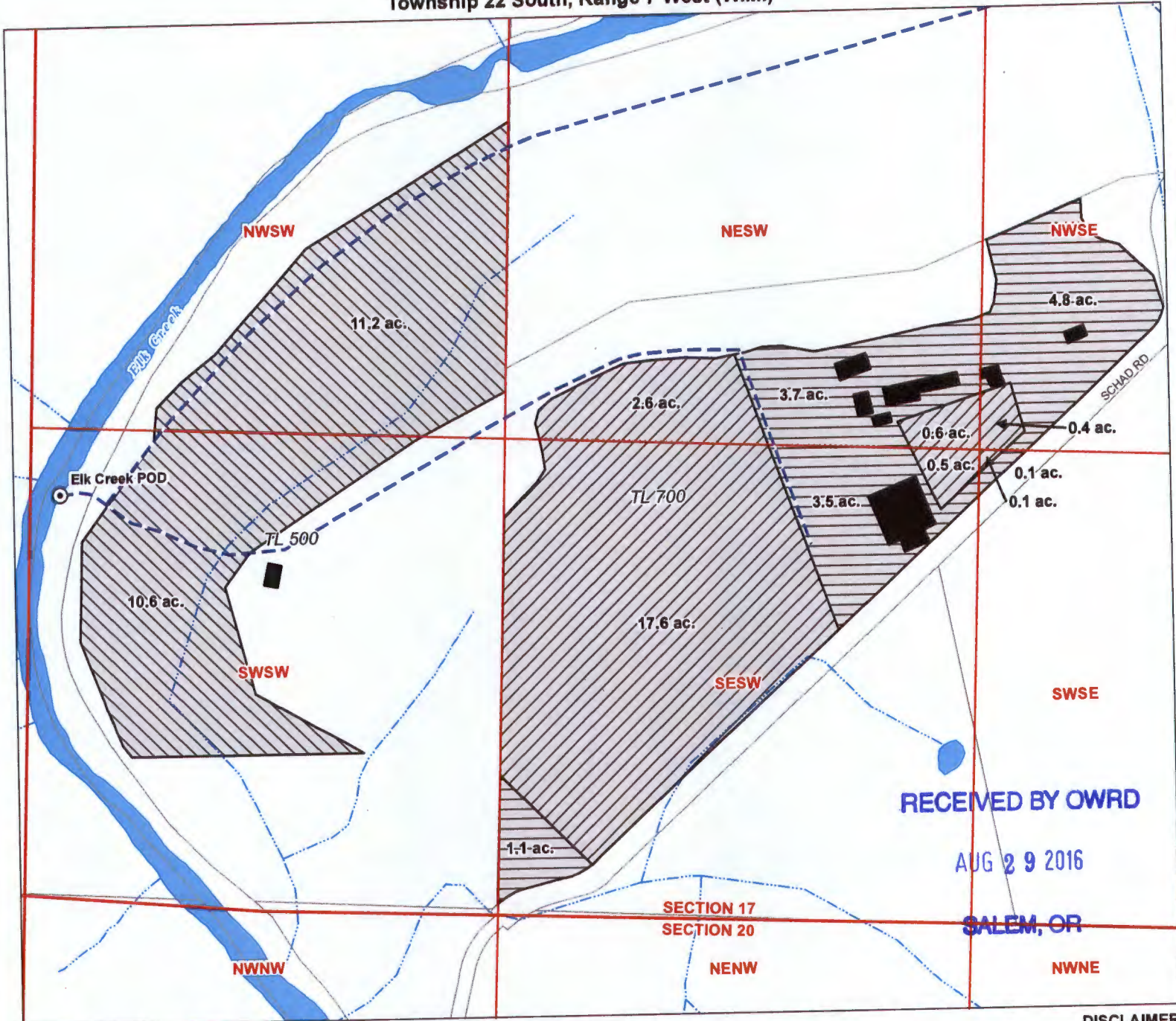

LEGEND

- | | |
|---|--|
| <ul style="list-style-type: none"> ⊙ Authorized Point of Diversion (POD) Place of Use (POU) From Lands To Lands Remaining | <ul style="list-style-type: none"> All Other Features Buildings Water Mainline Tax Lots Waterbodies Watercourses |
|---|--|

POD LOCATION DESCRIPTION

Elk Creek POD
Located 1,120 feet North and 85 feet East from the SW corner of Section 17, Township 22 South, Range 7 West (W.M.)

Certified Water Rights Examiner Stamp

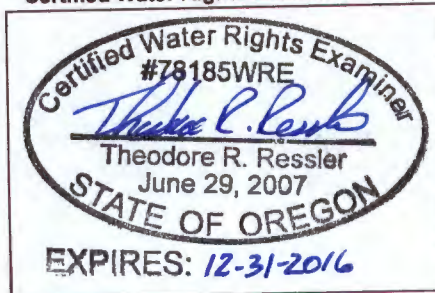

DISCLAIMER
This map was prepared for the purpose of identifying the location of a water right only and it is not intended to provide legal dimensions or location of property ownership lines.

MAP NOTES:
Date: July 21, 2016
Data Sources: OWRD, Douglas Co. GIS, US BLM, USGS, ESRI

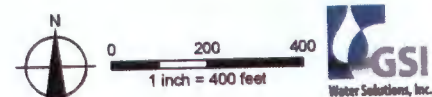

T 12466