

T. 17S, R. 10W, W.M.  
SECTION 34

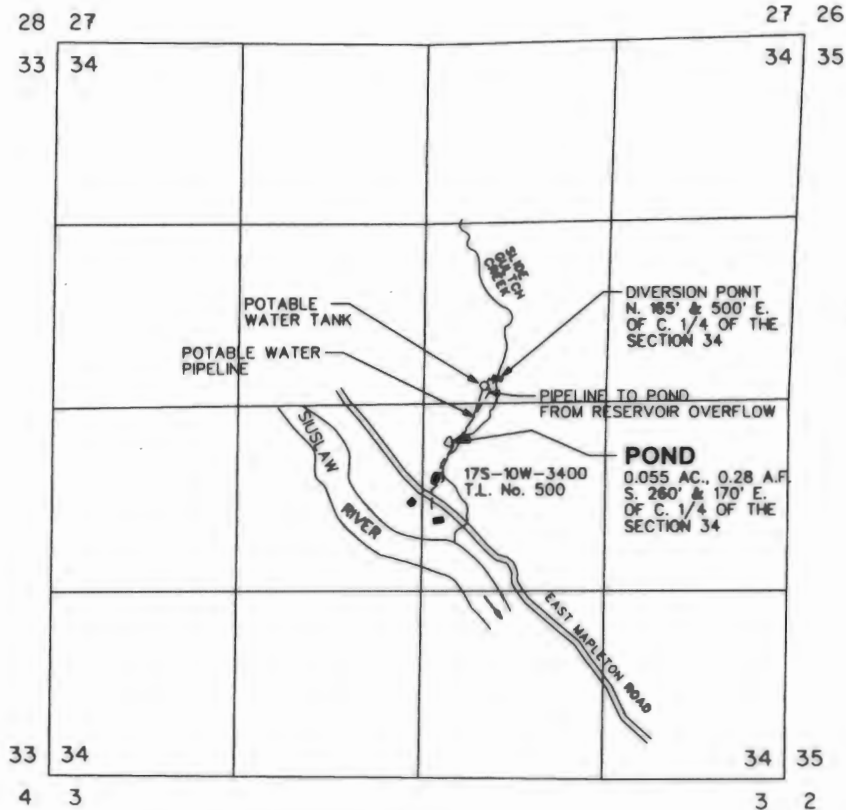

RECEIVED BY OWRI

MAY 09 2016

SALEM, OR

**FINAL PROOF MAP  
FOR STORAGE RESERVOIR**

1" = 1320'

PERMIT No. 13125

IN THE NW 1/4 OF SE 1/4 OF SECTION 34,  
T. 17S., R. 10W., W.M.  
LANE COUNTY, OREGON

ALISON D. HUSS  
& BRANDON W. CAMP

JAN. 12, 2016

BY:

**MIKE McALLISTER ENGINEERING**

11301 E. MAPLETON ROAD  
MAPLETON, OREGON 97453  
PH: 541-268-4326  
FAX: 541-268-4326

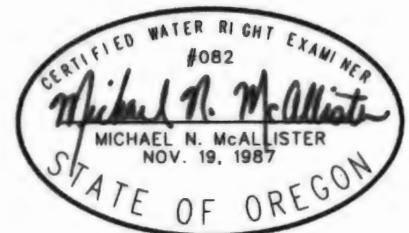

NOTE:  
THIS MAP IDENTIFIES THE LOCATION OF THE  
WATER RIGHT ONLY, AND IS NOT INTENDED TO PROVIDE  
DIMENSIONS OR LOCATE PROPERTY OWNERSHIP LINES.