

# CLAIM OF BENEFICIAL USE MAP

FOR: BRIAN OR ANN LANSING  
 BY: NATHAN R. REED, CWRE  
 T29S, R7W, W.M. SECTION 4 DLC 41  
 APPLICATION NO. S-87730  
 PERMIT NO. S-54735

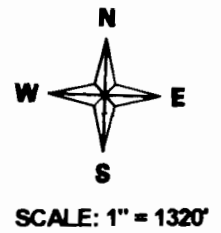

DATE SURVEYED: JUNE 12, 2012

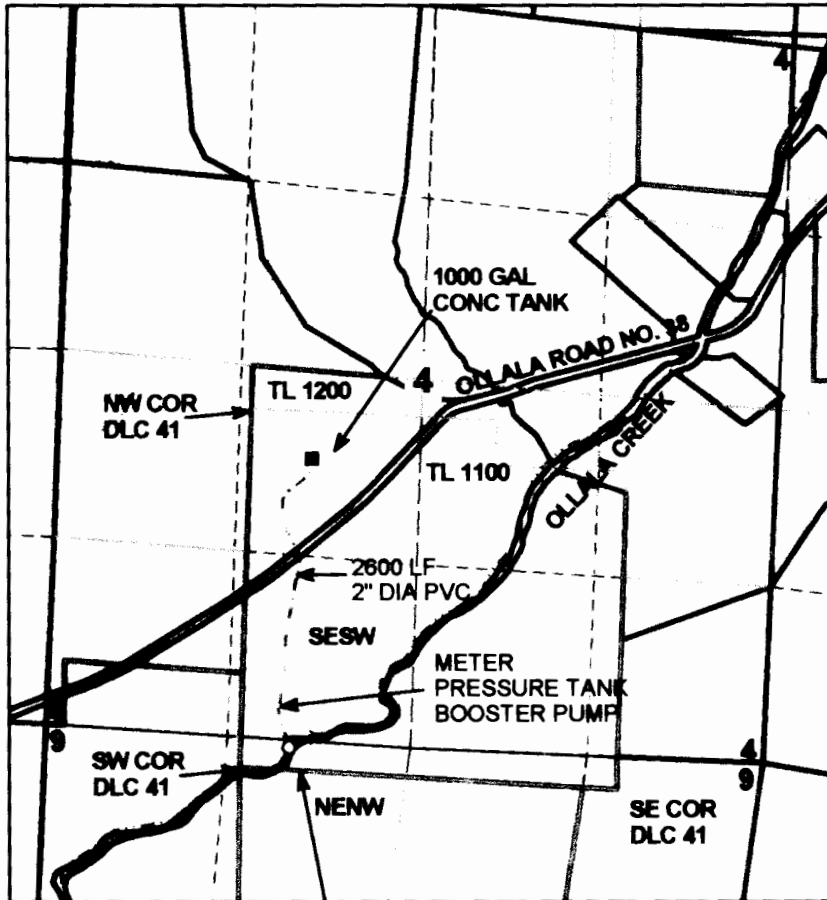

## Legend

- structure
- POD
- Pipeline
- - - Stream
- Flow\_arrow
- ▭ Township
- ▭ DLC
- ▭ Section
- - - Quarter
- - - Sixteenth
- ▭ Parcels

POD IS LOCATED 1750 FEET EAST AND 75 FEET SOUTH OF THE NW CORNER OF SECTION 9.

IRRIGATION AREAS LIMITED TO LAWN AND FLOWER BEDS AROUND THE HOUSE AT LESS THAN 0.5 ACRES TOTAL APPLIED IN ZONES.

RECEIVED

JUN 12 2012

WATER RESOURCES DEPT  
 DEPT OF AGRICULTURE  
 OREGON

MAP PREPARED FOR:  
 BRIAN AND ANN LANSING  
 3791 OLLALA ROAD  
 WINSTON, OR 97496

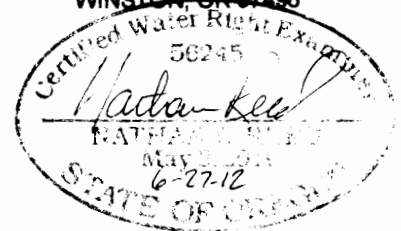

Expires Dec 31, 2012

THE PURPOSE OF THIS MAP IS TO IDENTIFY THE LOCATION OF THE WATER RIGHT. IT IS NOT INTENDED TO PROVIDE INFORMATION RELATIVE TO THE LOCATION OF PROPERTY OWNERSHIP BOUNDARY LINES.

MAP PREPARED BY:  
 NATHAN R. REED, P.E., CWRE  
 1113 SE CASS AV  
 ROSEBURG, OR 97470