

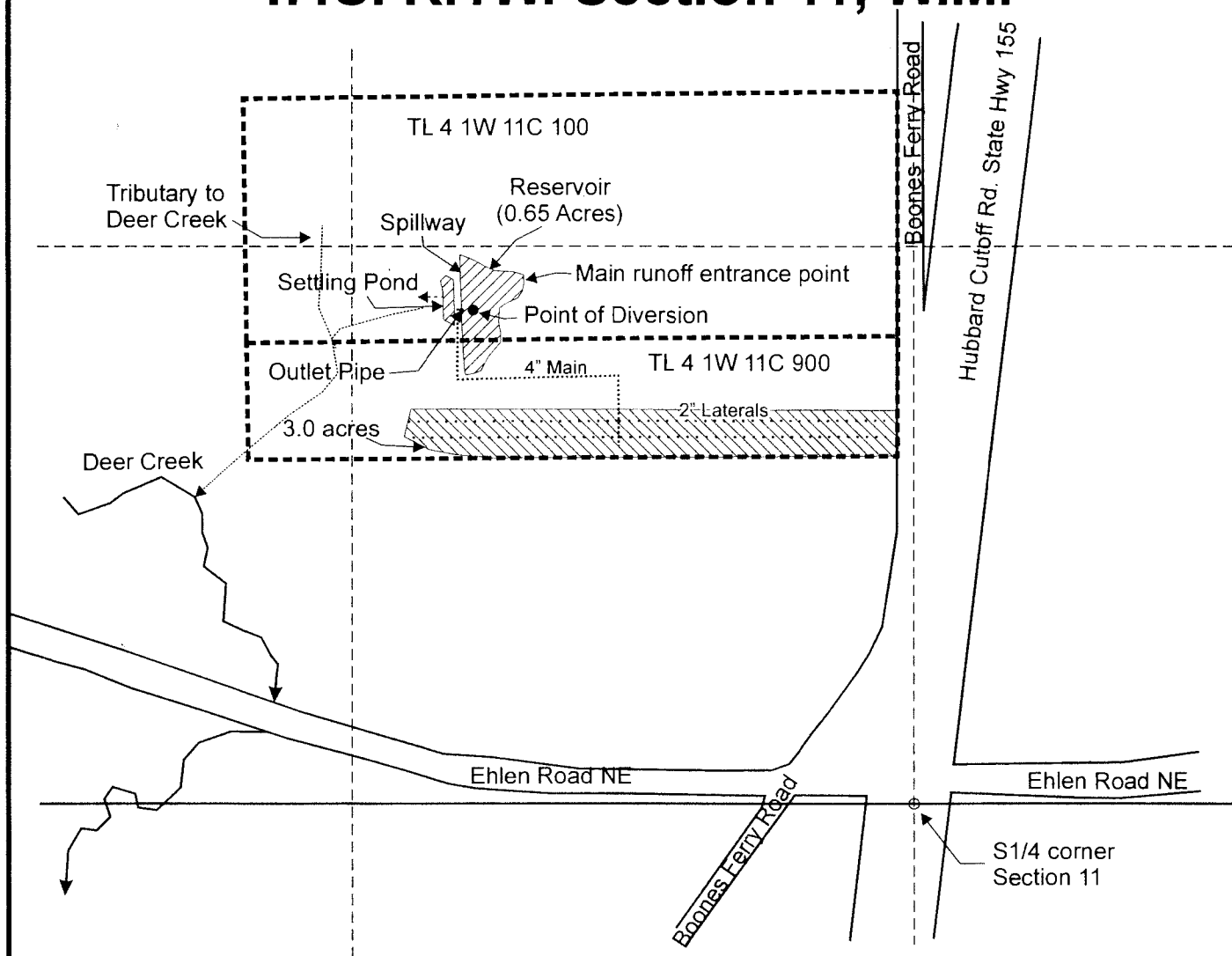



T.4S. R.1W. Section 11, W.M.



Point of diversion is located 1070 feet north and 1040 feet west from the S 1/4 corner, Section 11.

Outlet pipe is located 1070 feet north and 1060 feet west from the S 1/4 corner, Section 11.

-  Reservoir (4.9 acre feet).
-  Area (3.0 Acres) to be irrigated.
-  Tax lot boundary

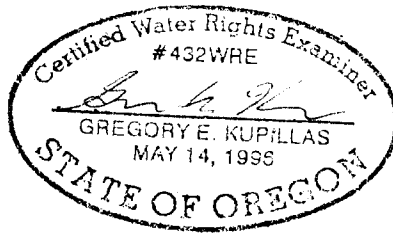

EXPIRATION DATE: 6/30/13

Scale: 1" = 400'

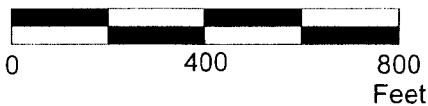

This map was prepared for the purpose of identifying the location of a water right only and is not intended to provide legal dimensions or location of property ownership lines.



Claim of Beneficial Use Map
 Application R-86148, Permit R-14197 and
 Application S-86149, Permit S-54221

Western Sun Landscaping
 T.4S. R.1W. Section 11, W.M.

Pacific Hydro-Geology Inc.

09/2011