

Claim of Beneficial Use Point of Diversion & Place of Use Map

Application G-12033, Permit G-11091; Permit Amendment T-8065

Deschutes County

Township 18 South, Range 11 & 12 East (W.M.)

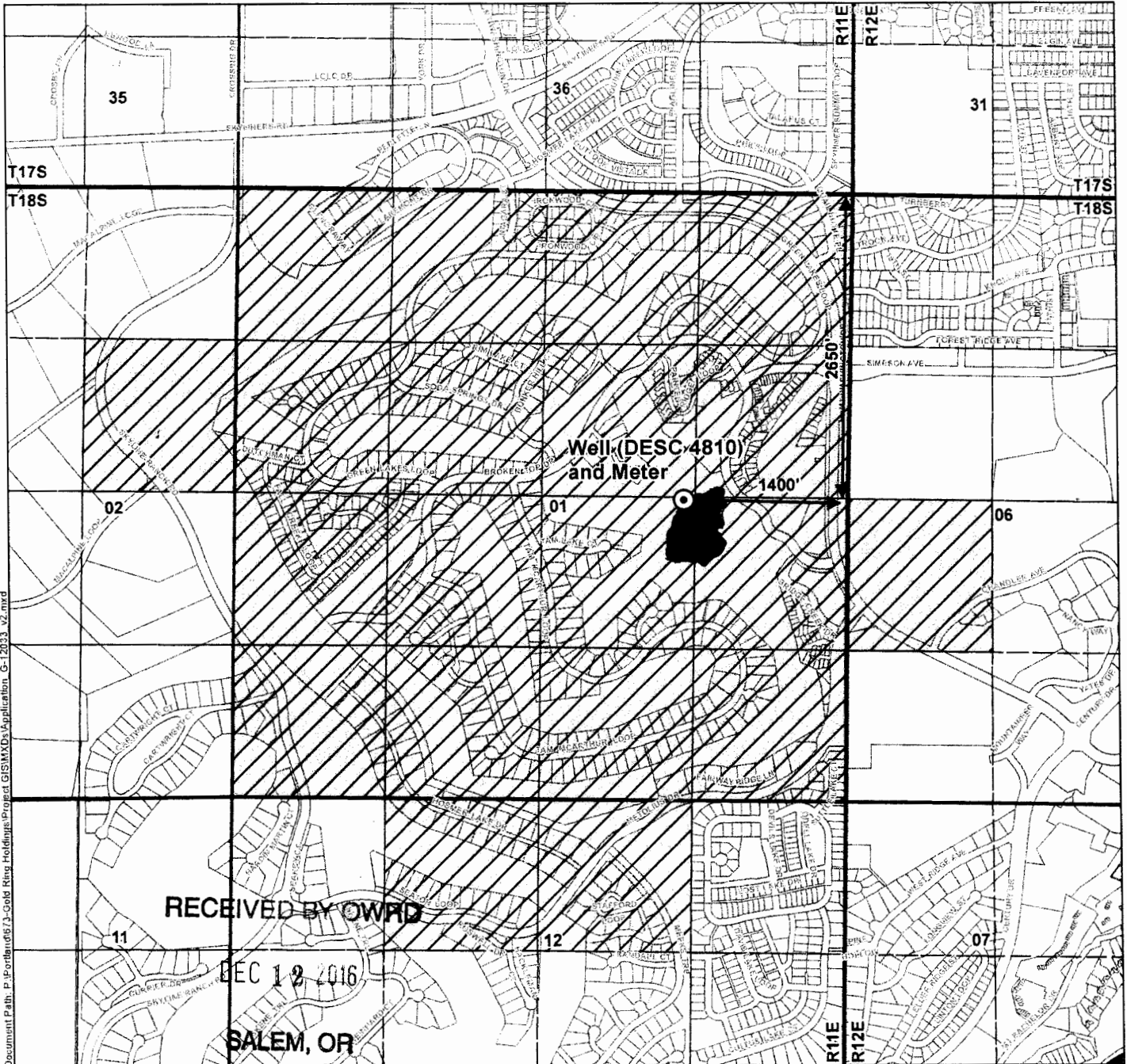

Document Path: P:\Portland\673-Gold-Ring-Holdings-Project-GIS\MapDocs\Application_G-12033_v2.mxd

- LEGEND**
- Well Location
 - Tax Lot
 - Waterbody
 - Place of Use (POU)

POD LOCATION DESCRIPTION
 Point of Diversion
 Proposed Well Located 2,650 feet South and 1400 feet West from the NE corner of Section 1, Township 18 South, Range 11 East (W.M.)
 Meter Location
 Meter Located 4' SW of well inside vault

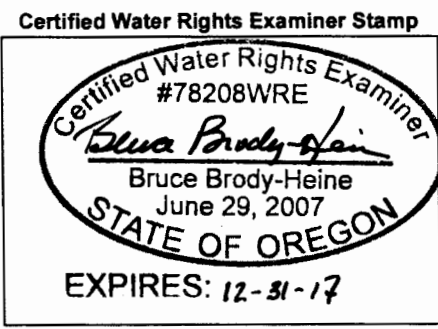

DISCLAIMER
 This map was prepared for the purpose of identifying the location of a water right only and it is not intended to provide legal dimensions or location of property ownership lines.

MAP NOTES
 Date: September 23, 2016
 Data Sources: Deschutes County, BLM, OWRD

