

Claim of Beneficial Use

Permit G-16619, Application G-16865

12/2/2016

Water Right in the Name of City of Walla Walla
Umatilla County
Township 6 North, Range 38 East (W.M.)

SALEM OR

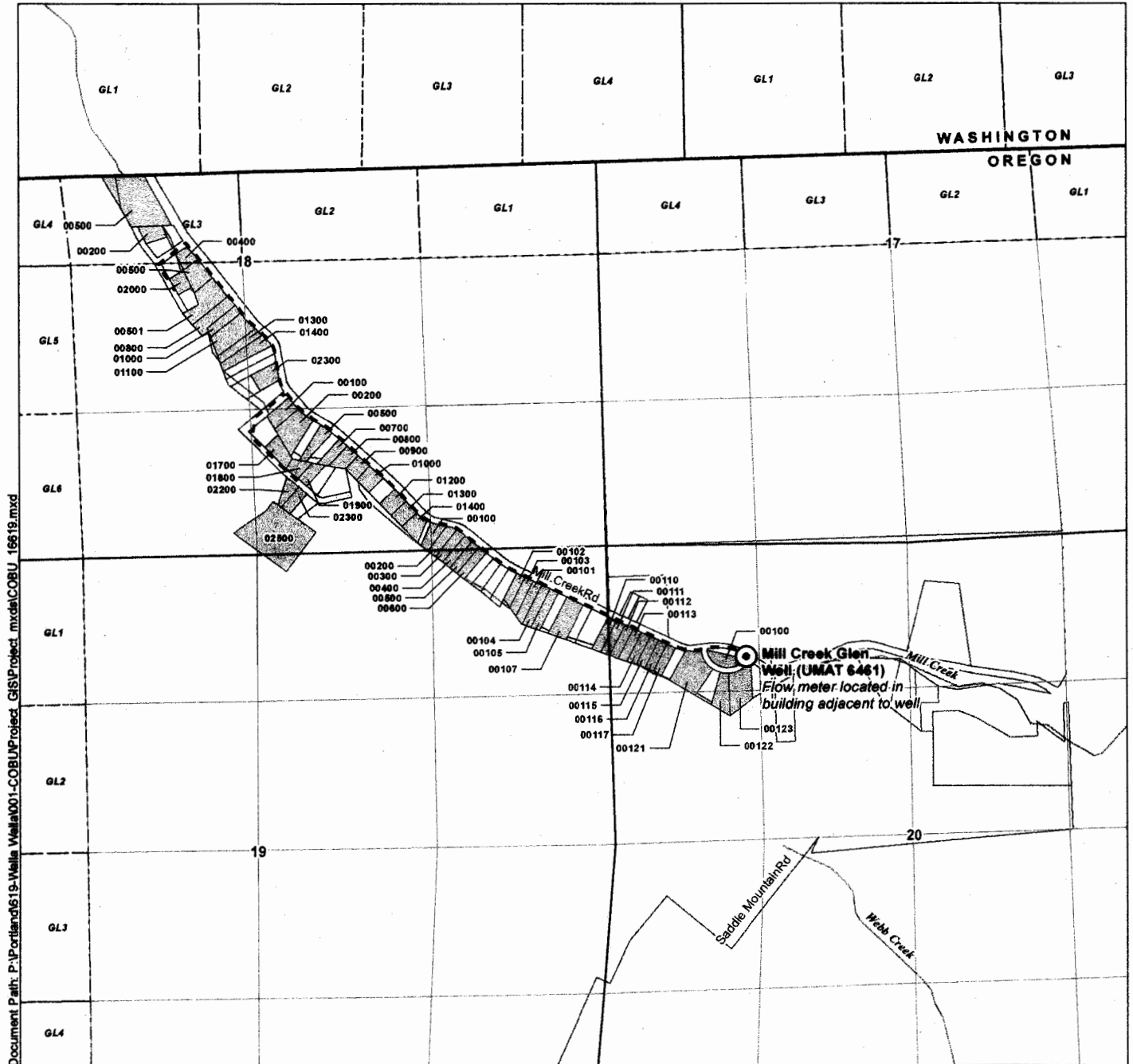

Document Path: P:\Portland\619-Walla Walla\001-COBUP\project_GIS\Project.mxd\COBU_16619.mxd

WASHINGTON
OREGON

Disclaimer

This map was prepared for the purpose of identifying the location of a water right only and it is not intended to provide legal dimensions or location of property ownership lines.

Map Notes

Date: December 8, 2015
Data Sources: BLM, Umatilla Co., Walla Walla Co., USGS
Prepared By: GSI Water Solutions, Inc.

LEGEND

- Point of Appropriation (POA)
- Mainline
- Tax Lots
- Government Lot (GL)
- Watercourse
- Waterbody

POA Location Description

Mill Creek Glen Well
Located 975 feet South and 1,165 feet East from the NW corner of Section 20, Township 6 North, Range 38 East (W.M.)

Certified Water Rights Examiner Stamp

