

CLAIM OF BENEFICIAL USE MAP FOR TRANSFER T-11995
 IN THE NAME OF ANTONIO RUIZ
 SEC 28, T5N & T6N, R35E, W.M., UMATILLA COUNTY
 SHEET 2 OF 2

28

NE1/4SW1/4
 SEC 28
 T6N, R35E,
 W.M.

NW1/4SE1/4
 SEC 28
 T6N, R35E,
 W.M.

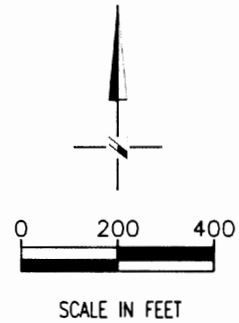

15 hp Centrifugal
 Pump & Flow Meter

Buried 6" Gravity
 PVC Pipeline

200'±

TL 2000

65'±

TL 2100

TL 2200

Buried 4"
 PVC Pipeline

GOODMAN SPRING BRANCH
 (RICHARTZ CANAL)

Intake Structure

175'±

SE1/4SW1/4
 SEC 28
 T6N, R35E,
 W.M.

19.0
 AC

10.0
 AC

SW1/4SE1/4
 SEC 28
 T6N, R35E,
 W.M.

Property
 Boundary

Lateral - Portable
 Alum Hand Line
 (typical)

PLEASANT VIEW ROAD

S1/4 COR
 SEC 28
 T6N, R35E,
 W.M.

LEGEND



AREA IRRIGATED ASSOCIATED WITH
 ORIGINATING CERT 86961 (IRR) &
 ORIGINATING CERT 86964 (SUPP IRR)

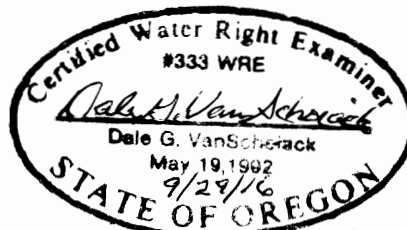

DGV Consulting, PLLC
 PHONE (509) 627-8717
 dalevconsulting@gmail.com
 Date: Sept 20, 2016

NOTE:
 THE PURPOSE OF THIS MAP IS TO IDENTIFY THE APPROXIMATE LOCATION OF THE WATER
 RIGHT. IT IS NOT INTENDED TO PROVIDE INFORMATION RELATIVE TO THE LOCATION OF
 PROPERTY OWNERSHIP BOUNDARY LINES. PIPELINE SIZES AND LOCATIONS WERE
 PROVIDED BY FARM PERSONNEL AND HAVE NOT BEEN VERIFIED.

Renew: 6/30/18

CLAIM OF BENEFICIAL USE MAP FOR TRANSFER T-11995
 IN THE NAME OF ANTONIO RUIZ
 SEC 28, T5N & T6N, R35E, W.M., UMATILLA COUNTY
 SHEET 1 OF 2

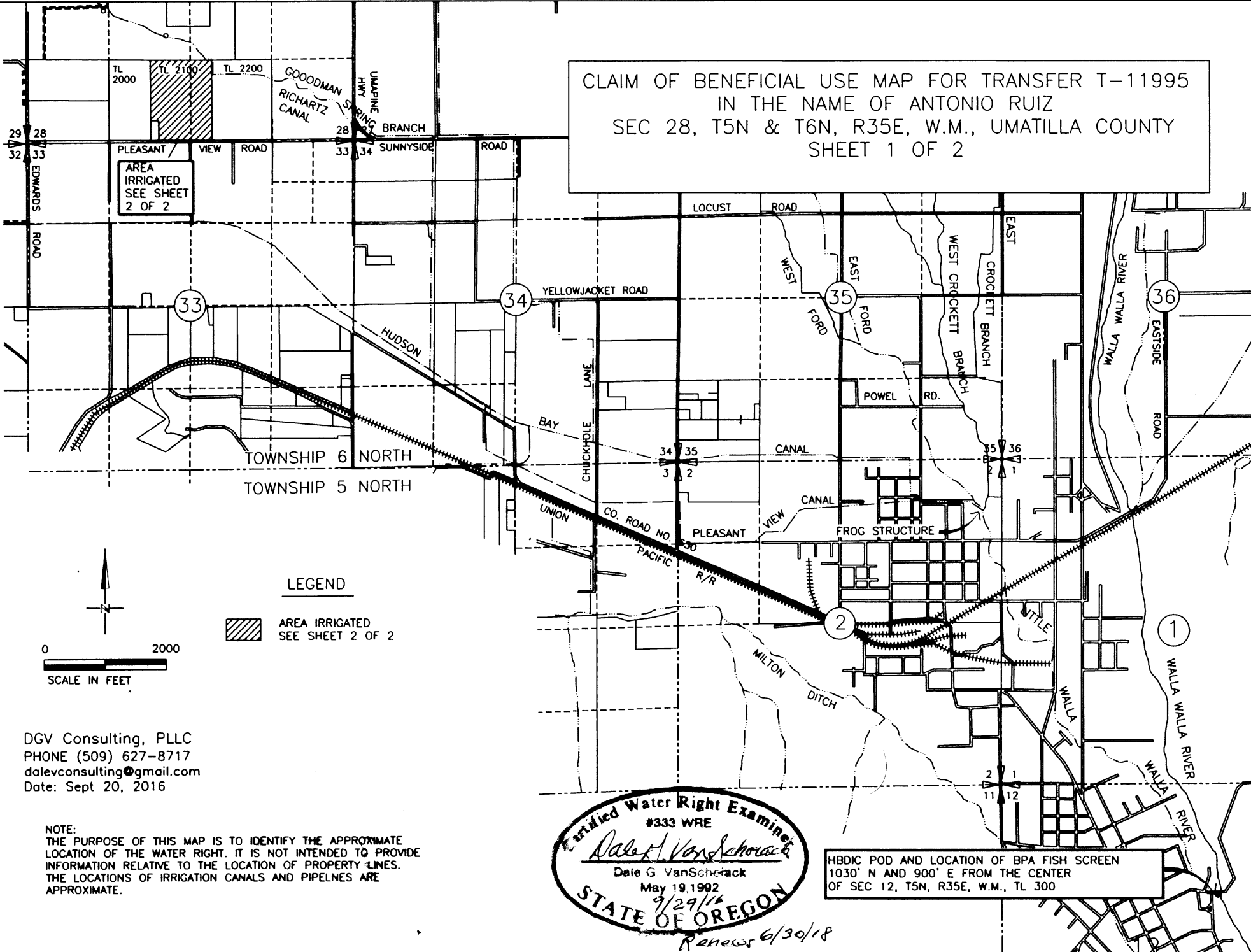

AREA IRRIGATED
 SEE SHEET
 2 OF 2

LEGEND
 AREA IRRIGATED
 SEE SHEET 2 OF 2

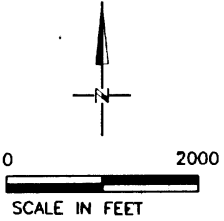

DGV Consulting, PLLC
 PHONE (509) 627-8717
 dalevconsulting@gmail.com
 Date: Sept 20, 2016

NOTE:
 THE PURPOSE OF THIS MAP IS TO IDENTIFY THE APPROXIMATE
 LOCATION OF THE WATER RIGHT. IT IS NOT INTENDED TO PROVIDE
 INFORMATION RELATIVE TO THE LOCATION OF PROPERTY LINES.
 THE LOCATIONS OF IRRIGATION CANALS AND PIPELINES ARE
 APPROXIMATE.

Qualified Water Right Examiner
 #333 WRE
Dale G. VanSchoeck
 Dale G. VanSchoeck
 May 19, 1992
 9/29/16
 STATE OF OREGON
 Renewed 6/30/18

HBDIC POD AND LOCATION OF BPA FISH SCREEN
 1030' N AND 900' E FROM THE CENTER
 OF SEC 12, T5N, R35E, W.M., TL 300