

**T26S, R30NE,
SECTION 01, WM**

HARNEY COUNTY, OREGON

35

36

31

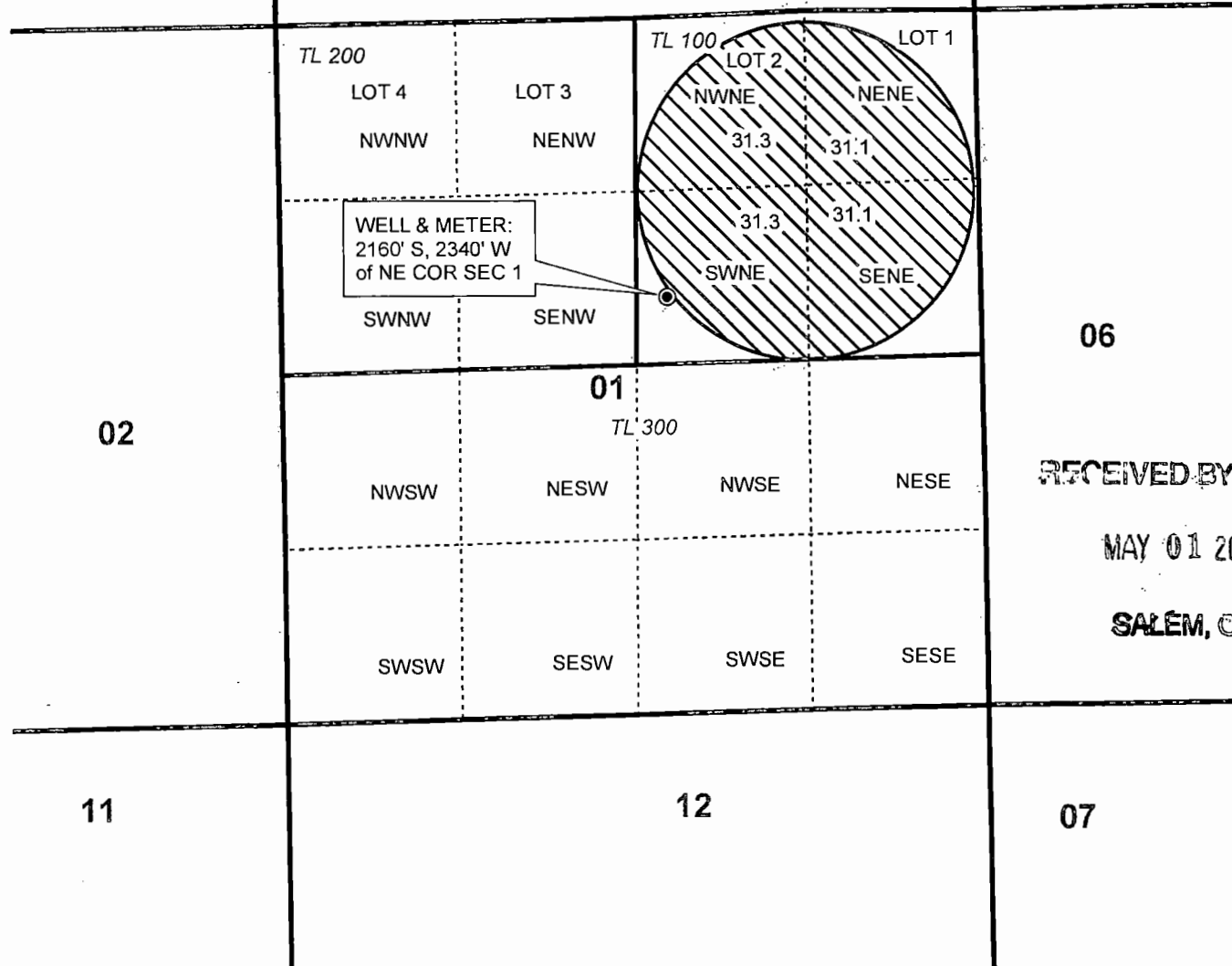

1 inch = 1,320 feet

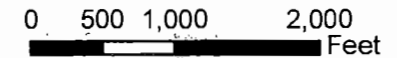

- Well
- POUIR
- Tax Lot
- Quarter Quarter

RECEIVED BY OWRD

MAY 01 2017

SALEM, OR

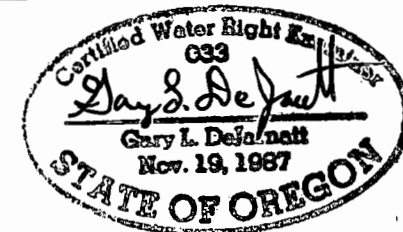

RENEWAL DATE 12/31/2017



Claim of Beneficial Use Map
Golden Rule Farms
Application Number: G-14852
Permit G-13639

NOTE: THIS MAP IS NOT INTENDED TO
 PROVIDE LEGAL DIMENSIONS OR LOCATIONS
 OF PROPERTY OWNERSHIP LINES.

JOB # 15108 APR 25, 2017

WATER RIGHT SERVICES, LLC
 PO BOX 1830, BEND, OR 97709
 CCB# 197121 www.oregonwater.us
 541-389-2837 JOHNSHORT@USA.COM