

# T.5S., R.1W., W.M.

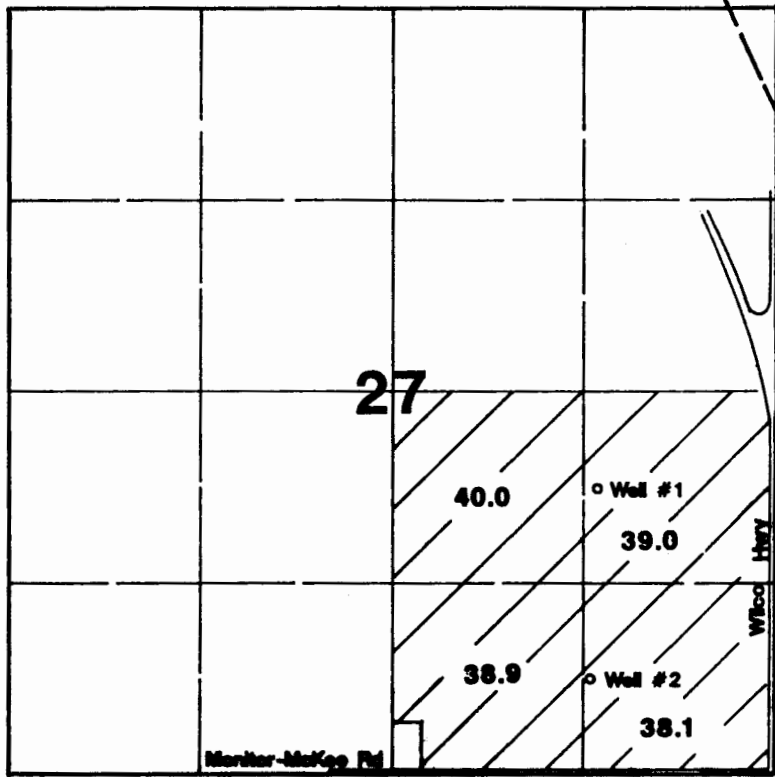

Well #1 located 1960'N & 1230'W from SE corner Section 27.  
Well #2 located 660'N & 1280'W from SE corner Section 27.

## Final Proof Survey

Application #: G-12513 Permit #: G-11893

In Name Of

### Paul J. & Alice E. Serres

Surveyed on July 10, 1996 By James Grimm

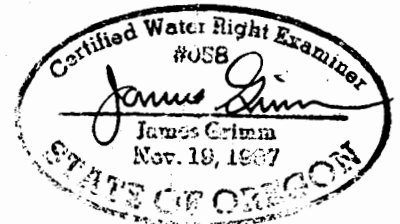

THIS MAP WAS PREPARED FOR THE PURPOSE OF IDENTIFYING THE LOCATION OF A WATER RIGHT ONLY AND IS NOT INTENDED TO PROVIDE LEGAL DIMENSIONS OR LOCATION OF PROPERTY OWNERSHIP LINES.