

0595

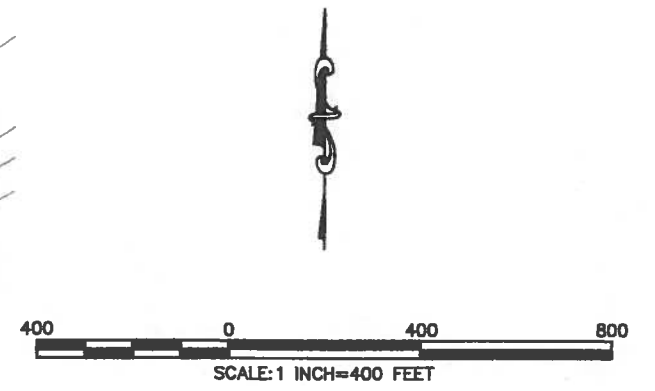
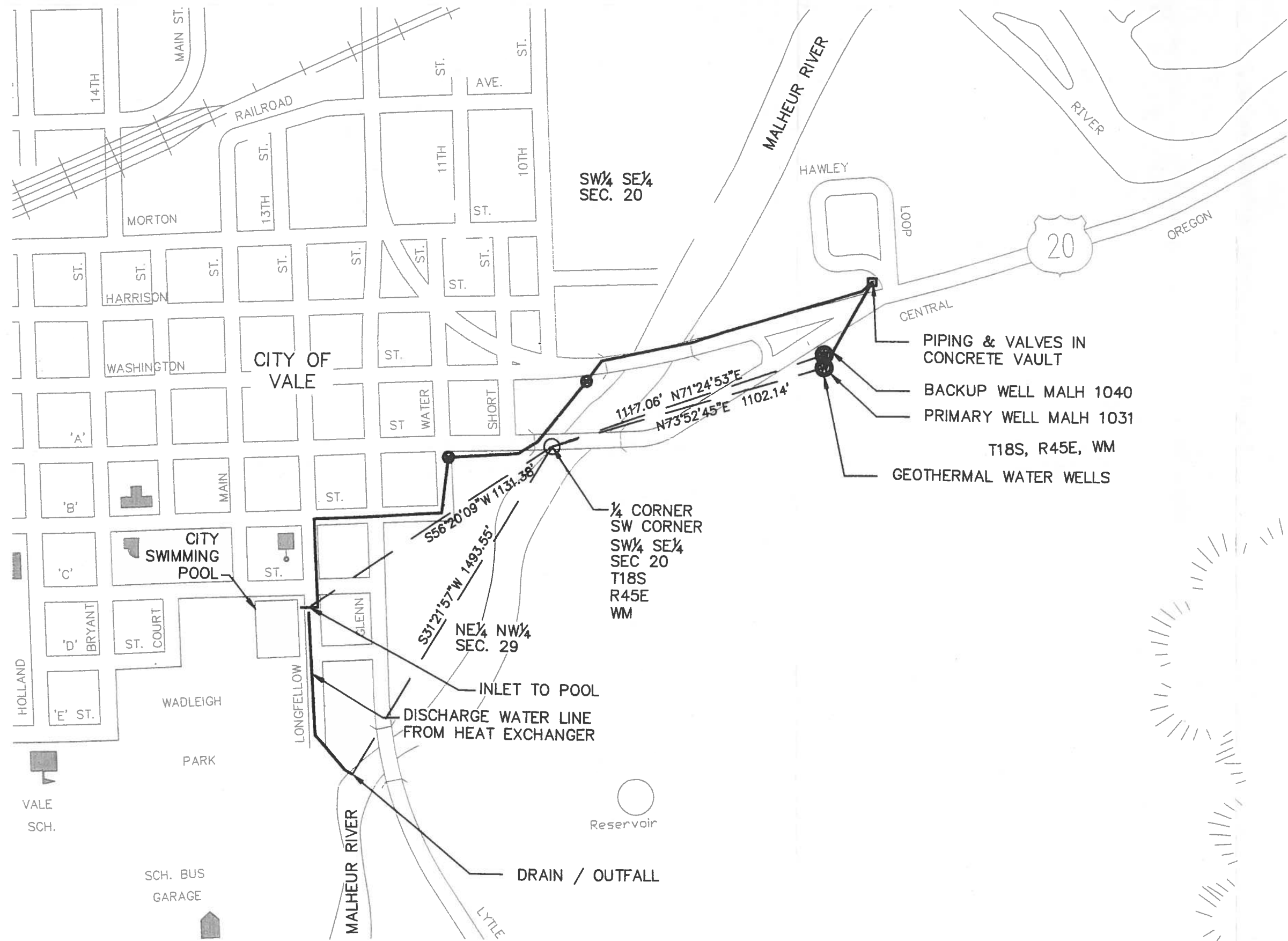

- NOTE:**
- A. THIS MAP IS FOR THE PURPOSE OF IDENTIFYING THE LOCATION OF WATER RIGHTS ONLY AND IS NOT INTENDED TO PROVIDE LEGAL DIMENSIONS OF LOCATIONS OF PROPERTY LINES.
  - B. GPS WAS USED TO LOCATE COORDINATES.
  - C. BASIS OF BEARINGS:  
OREGON COORDINATE SYSTEM OF 1983, SOUTH ZONE
  - D. APPLICATION S-73411
  - E. PERMIT S-52623

RECEIVED

JUL 01 2011  
WATER RESOURCES DEPT  
SALEM, OREGON

Certified Water Right Examiner  
#058  
*Michael E. Holladay*  
Michael E. Holladay  
Nov. 19, 1987  
6/28/11  
STATE OF OREGON  
6/30/11

COBU MAP # 0595  
folder U

**HOLLADAY ENGINEERING CO.**  
ENGINEERS • CONSULTANTS  
32 N Main • PO Box 235 • Payette ID 83661  
(208) 642-3304 • hec@holladayengineering.com

**GEOTHERMAL WELL WATER RIGHTS MAP  
CITY OF VALE, OREGON**

DRAWN BY: S. MCGHEE | DRAWING DATE: MARCH 2011 | G:\CLIENTS\VA\11-0313\DESIGN\OWS\11-0313\_WAT\_RT.dwg