

CLAIM OF BENEFICIAL USE

APPLICATION S-87595

PERMIT S-54700

SW 1/4, SECTION 27, TOWNSHIP 26 SOUTH, RANGE 6 WEST, W.M.
DOUGLAS COUNTY OREGON

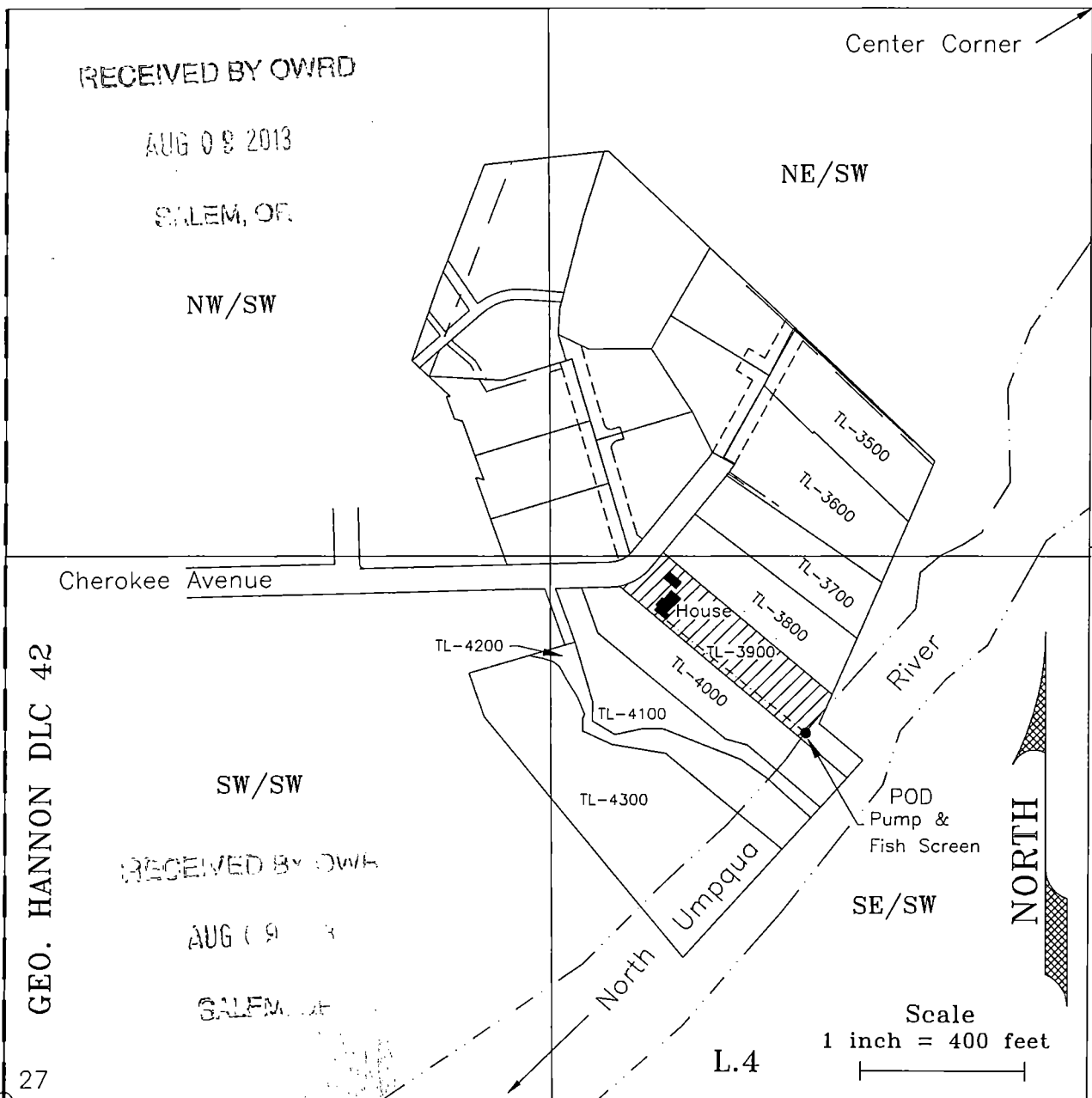

• POD - SE/SW, 1750 feet south and 685 feet west from the Center Corner of Section 27 & within DLC 42



Tax Lot 3900, Domestic Use Expanded
SE/SW, DLC 42, Section 27

Base Map: i.e.
Engineering Preliminary
Survey Map April 2007
Stanebrook Subdivision
with 2005 FSA and
Oregon Map aerial photo
overlays for assumed
best fit

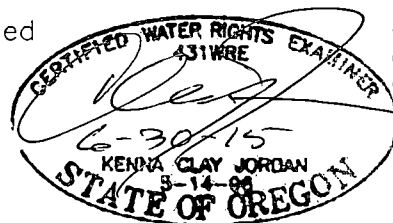

Revised 7/17/2013 k.c.j.

JORDAN ENGINEERING
460 JORDAN LANE
ROSEBURG, OR 97471
(541) 673-1931

Drawn 7/10/2013 n.e.d.

Revised 7/11/2013 n.e.d.

Permit in the name of:
Thomas Justin Lindbloom
603 Cherokee Ave.
Roseburg, OR 97471

This map is not intended to provide legal
dimensions or locations of property ownership lines