

CITY OF IRRIGON
CLAIM OF BENEFICIAL USE MAP
 APPLICATION T-10470

PROJECTION:
 State Plane North, NAD '83

POINTS OF APPROPRIATION:
 Well #3 - 5N 26E W.M. Sec 23, Gov. Lot 1 (SE/NE): 700' N and 545' W from the E 1/4 Corner of Section 23.
 Well #4 - 5N 26E W.M. 23 Sec. Gov. Lot 2 (SW/NE): 870' N and 1990' W from the E 1/4 Corner of Section 23.

AUTHORIZED PLACE OF USE:

- 5N 26E WM 24 NE SE
- 5N 26E WM 24 NW SE
- 5N 26E WM 24 SW SE
- 5N 26E WM 24 SE SE
- 5N 26E WM 25 NE NE
- 5N 26E WM 25 NW NE
- 5N 27E WM 19 NE SW
- 5N 27E WM 19 NW SW
- 5N 27E WM 19 SW SW
- 5N 27E WM 19 SE SW
- 5N 27E WM 19 NE SE
- 5N 27E WM 19 NW SE
- 5N 27E WM 19 SW SE
- 5N 27E WM 19 SE SE
- 5N 27E WM 30 NE NE
- 5N 27E WM 30 NW NE
- 5N 27E WM 30 NE NW
- 5N 27E WM 30 NW NW

RECEIVED

JUN 28 2013

WATER RESOURCES DEPT

NOTE: "This map is not intended to provide legal dimensions or locations of property ownership lines."

0 1,000 2,000 Feet
 1 inch = 2,000 feet



JUB ENGINEERS, INC.



Date: 6/27/2013

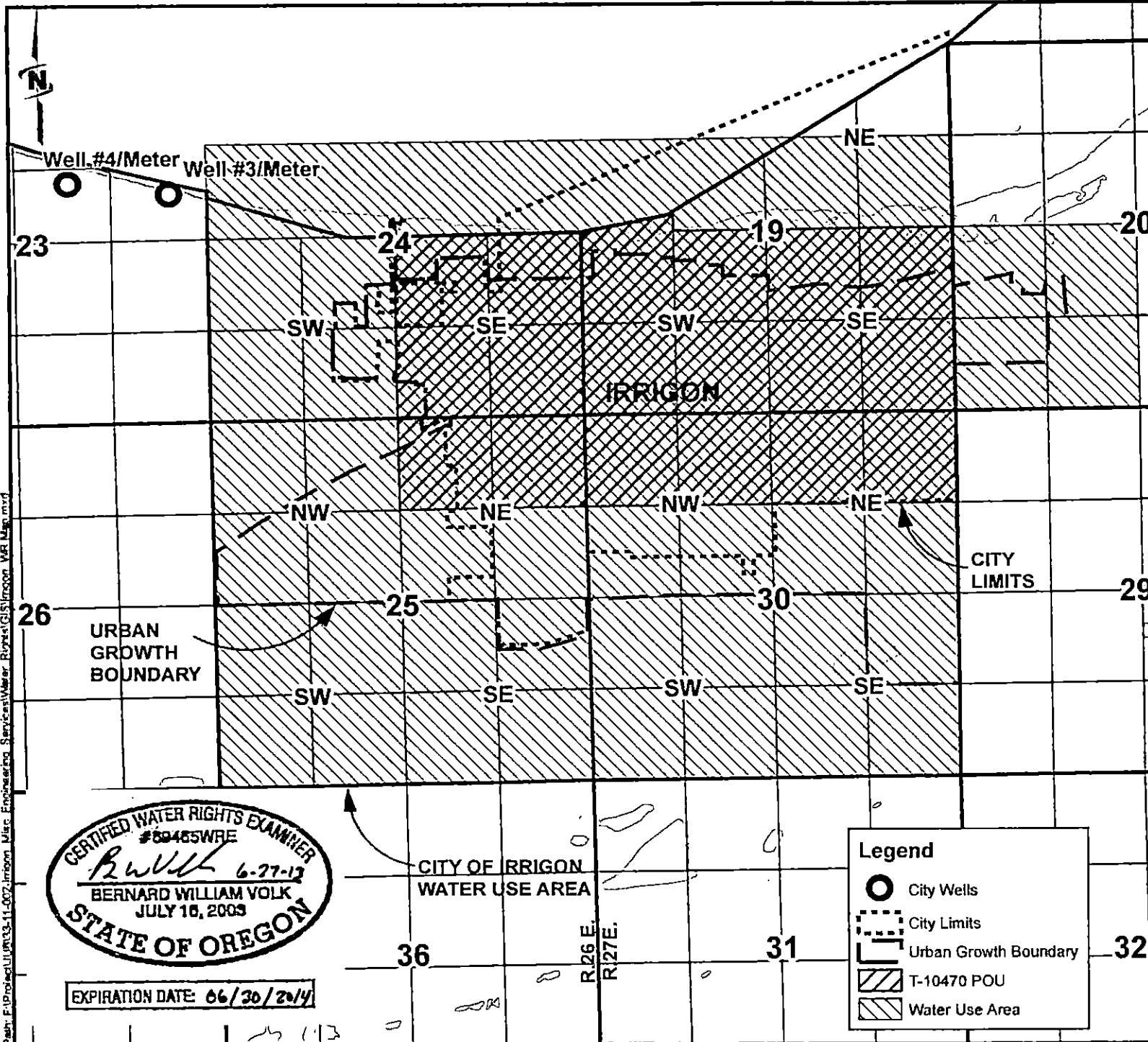

Legend

- City Wells
- City Limits
- Urban Growth Boundary
- T-10470 POU
- Water Use Area

CERTIFIED WATER RIGHTS EXAMINER
 #89485WRE
B. Volk 6-27-13
 BERNARD WILLIAM VOLK
 JULY 16, 2003
 STATE OF OREGON

EXPIRATION DATE: 06/30/2014

Path: F:\Protected\U:\03-11-007-irrigon Misc. Engineering Services\Water Rights\GIS\Irrigon_WRI_Maps.mxd