

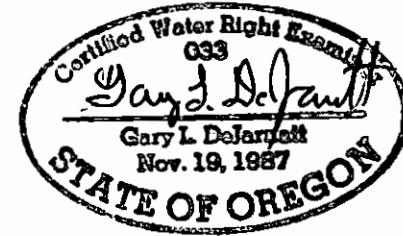







T24S, R07E,  
SECTION 7, WM  
KLAMATH COUNTY, OREGON

MAP 1 OF 2



RENEWAL DATE 12/31/2017

-  POU Quasi-Municipal Use
-  Section
-  Quarter Quarter
-  Tax Lot
-  Pipeline
-  POA
-  Water Tank

RECEIVED BY CWRD

MAY 04 2017

SALEM, OR

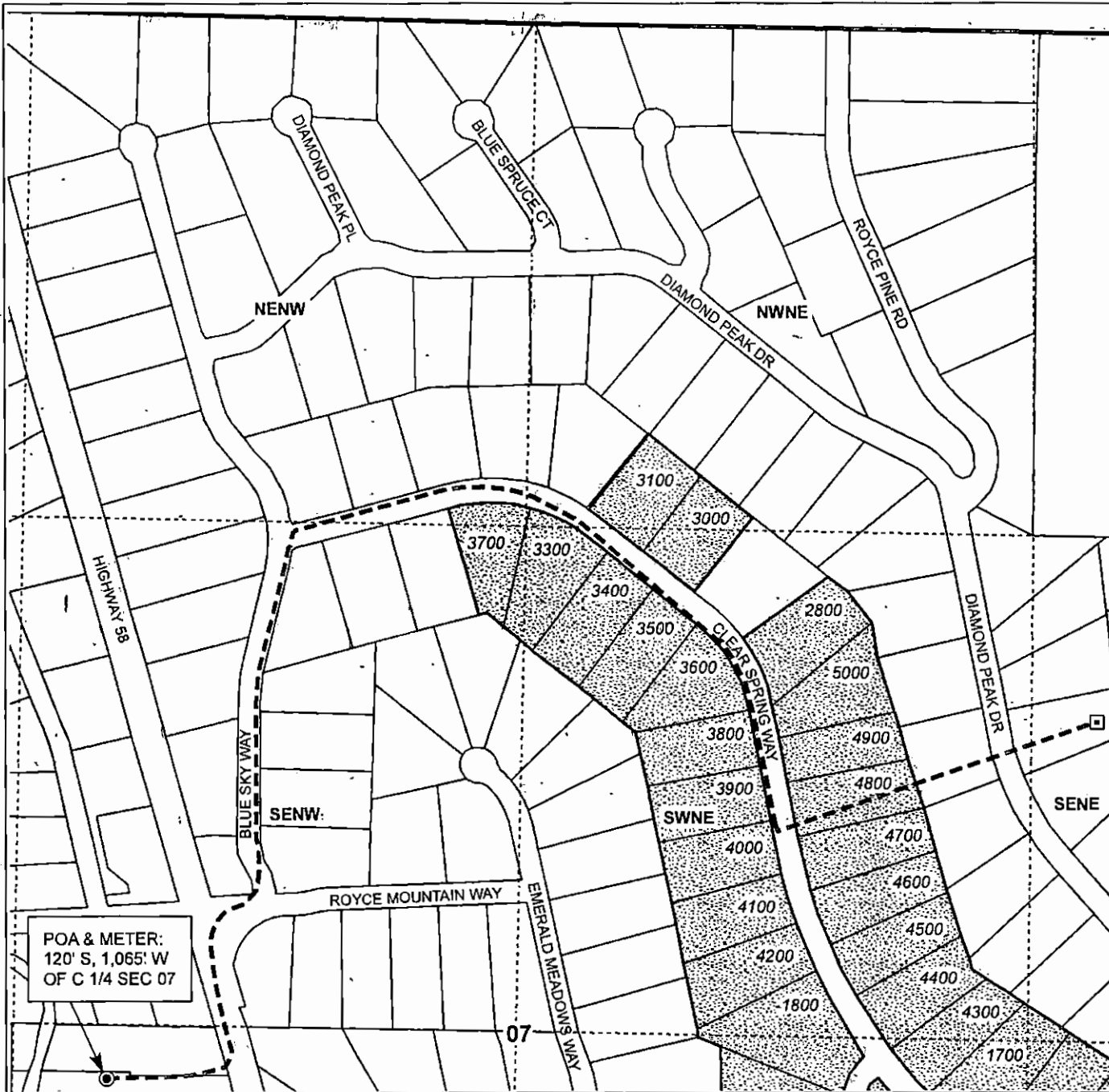
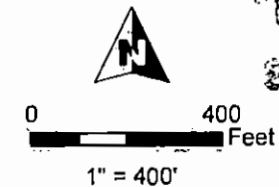

POA & METER:  
120' S, 1,065' W  
OF C 1/4 SEC 07

**CLAIM OF BENEFICIAL USE**  
Diamond Peaks HOA

NOTE: THIS MAP IS NOT INTENDED TO  
PROVIDE LEGAL DIMENSIONS OR LOCATIONS  
OF PROPERTY OWNERSHIP LINES.

**WATER RIGHT SERVICES, LLC**  
PO BOX 1830, BEND, OR 97709  
CCB# 197121 [www.oregonwater.us](http://www.oregonwater.us)  
541-389-2837 [JOHNSHORT@USA.COM](mailto:JOHNSHORT@USA.COM)

AP G-17445 PERMIT G-17618

JOB # 16064 DECEMBER 8, 2016

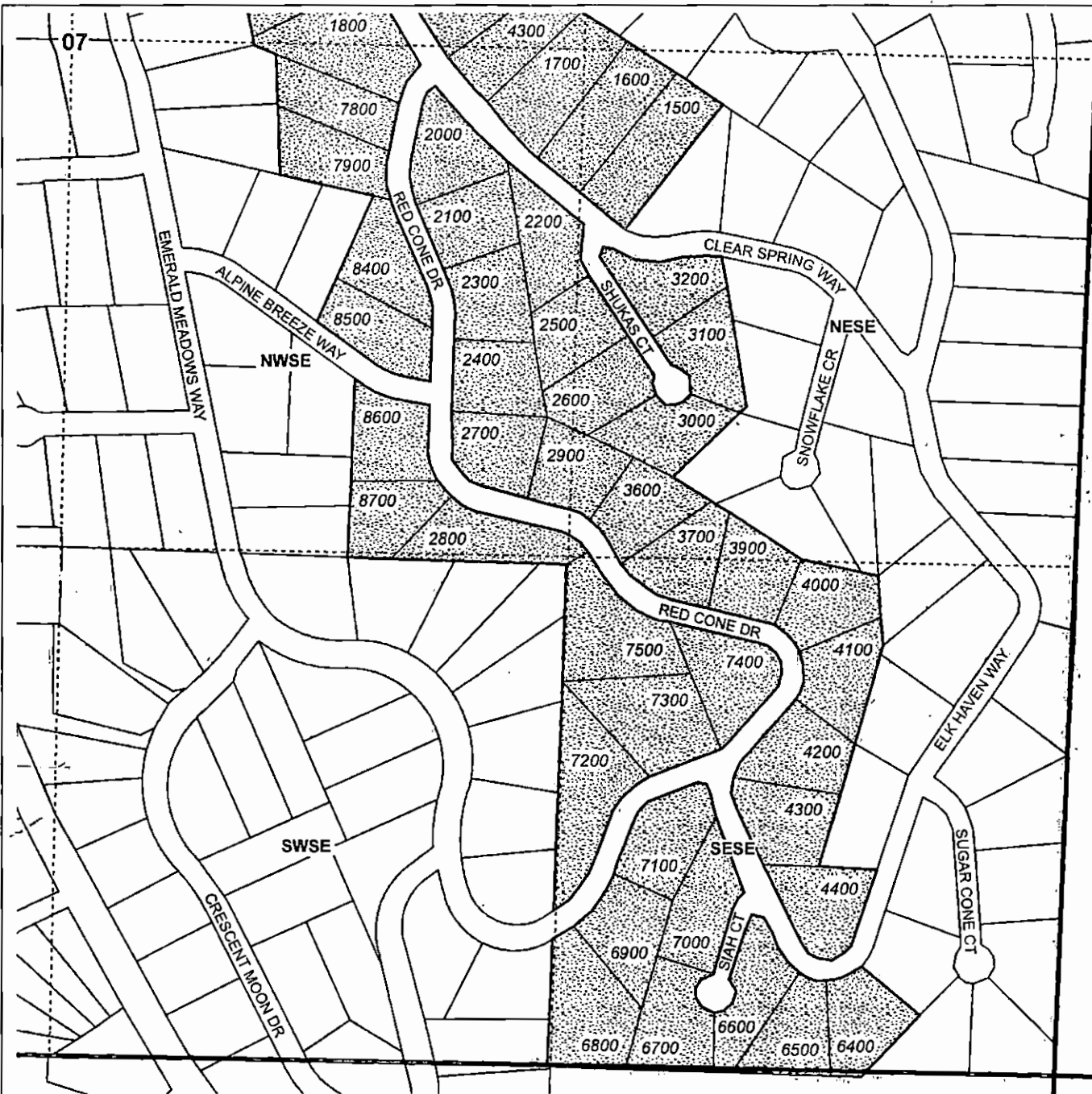



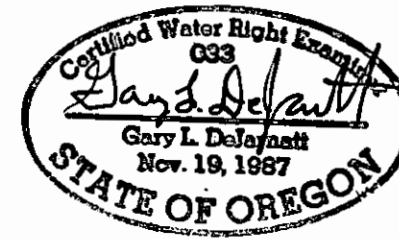

T24S, R07E,  
SECTION 7, WM  
KLAMATH COUNTY, OREGON

MAP 2 OF 2



RENEWAL DATE 12/31/2017

-  POU Quasi-Municipal Use
-  Section
-  Quarter Quarter
-  Tax Lot

RECEIVED BY CWRD

MAY 04 2017

CALLI, OR

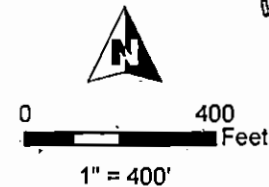

**CLAIM OF BENEFICIAL USE**  
Diamond Peaks HOA

AP G-17445 PERMIT G-17618

NOTE: THIS MAP IS NOT INTENDED TO  
PROVIDE LEGAL DIMENSIONS OR LOCATIONS  
OF PROPERTY OWNERSHIP LINES.

JOB # 16064 DECEMBER 8, 2016

**WATER RIGHT SERVICES, LLC**  
PO BOX 1830, BEND, OR 97709  
CCB# 197121 [www.oregonwater.us](http://www.oregonwater.us)  
541-389-2837 [JOHNSHORT@USA.COM](mailto:JOHNSHORT@USA.COM)