

T.7S., R.2W., W.M.

RECEIVED

MAR 31 2014

OWRD

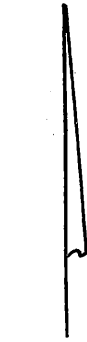
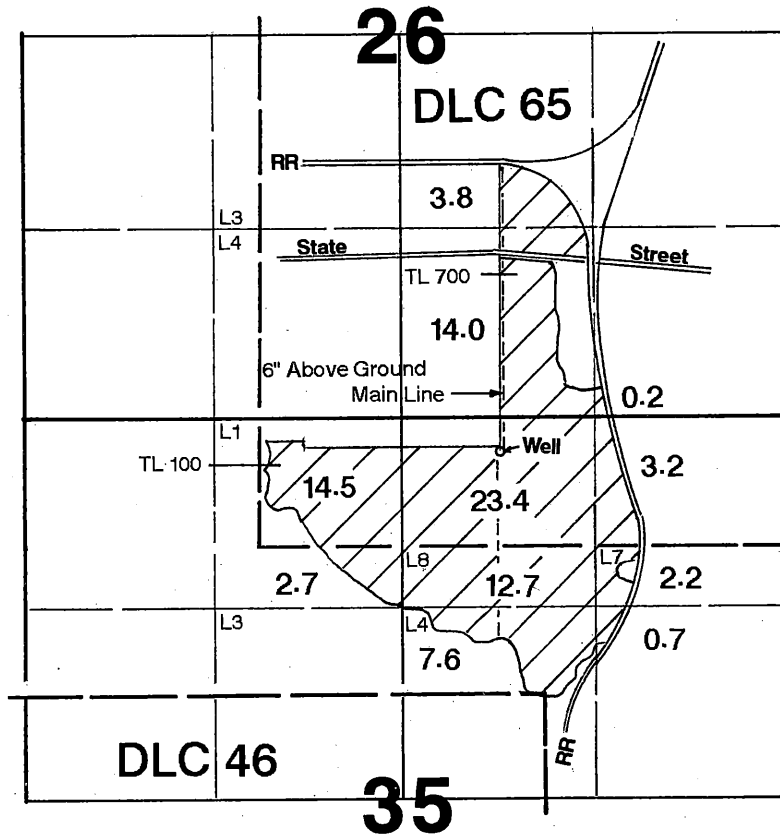

1" = 1320'

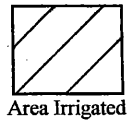

Well is located 230' S and 1980' W from the NE corner Section 35.

Final Proof Survey

In the Name of

Mike Thompson

Application #: G-12242 Permit #: G-11448

Surveyed on March 4, 2014 by JM Schuette

This Map was Prepared for the Purpose of Identifying the Location of a Water Right Only and is Not Intended to Provide Legal Dimensions or Location of Property Ownership Lines.

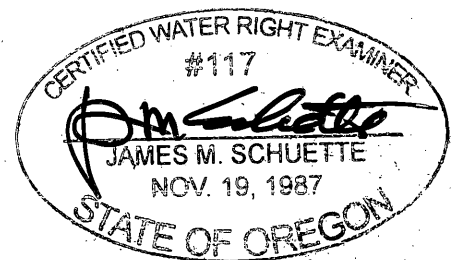

EXPIRES: 6/30/2014