

Township 4 North, Range 29 East, W.M.
 SE1/4 NE1/4 of SECTION 7
 UMATILLA COUNTY

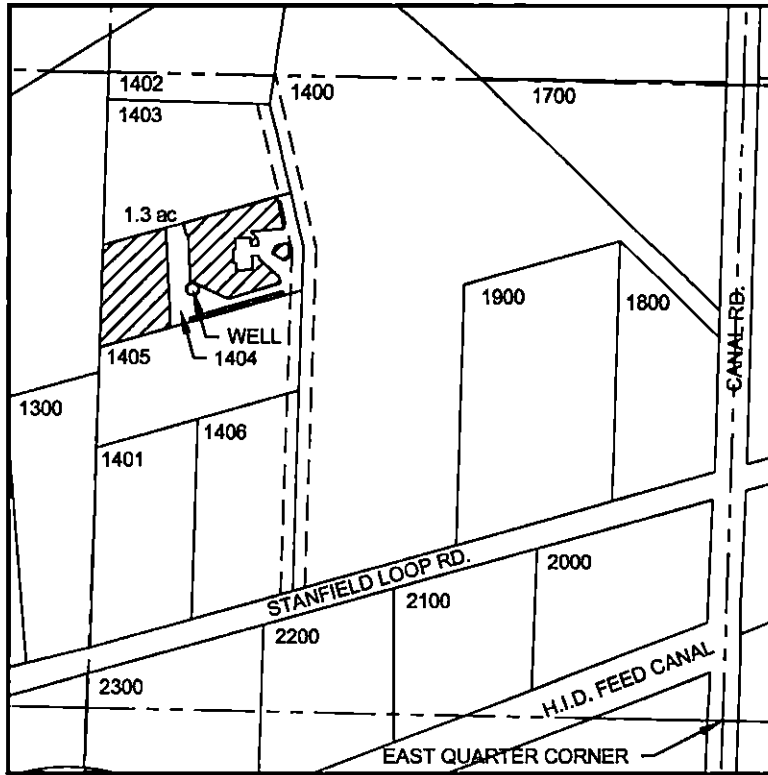

WELL LOCATED 890' NORTH & 1110' WEST OF EAST QUARTER CORNER OF SECTION 7.

LEGEND

- SECTION LINES
- TAX LOTS
- 1.3 ACRES OF IRRIGATED GROUND.
- 1404 TAX LOT NUMBERS

RECEIVED BY OWRD

DEC 10 2013

SALEM, OR

FINAL PROOF SURVEY
 Permit G-16041
 in the name of
JASON KNUTZ
 October 24, 2013

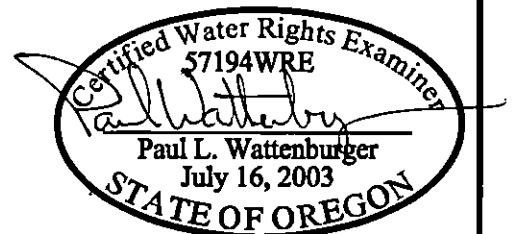

THIS MAP WAS PREPARED FOR THE PURPOSE OF IDENTIFYING THE LOCATION OF A WATER RIGHT ONLY AND IS NOT INTENDED TO PROVIDE LEGAL DIMENSIONS OR LOCATION OF PROPERTY OWNERSHIP LINES.

EXPIRES: 6/30/14