

T25S, R31E,
SECTIONS 29 AND 32, WM

HARNEY COUNTY, OREGON

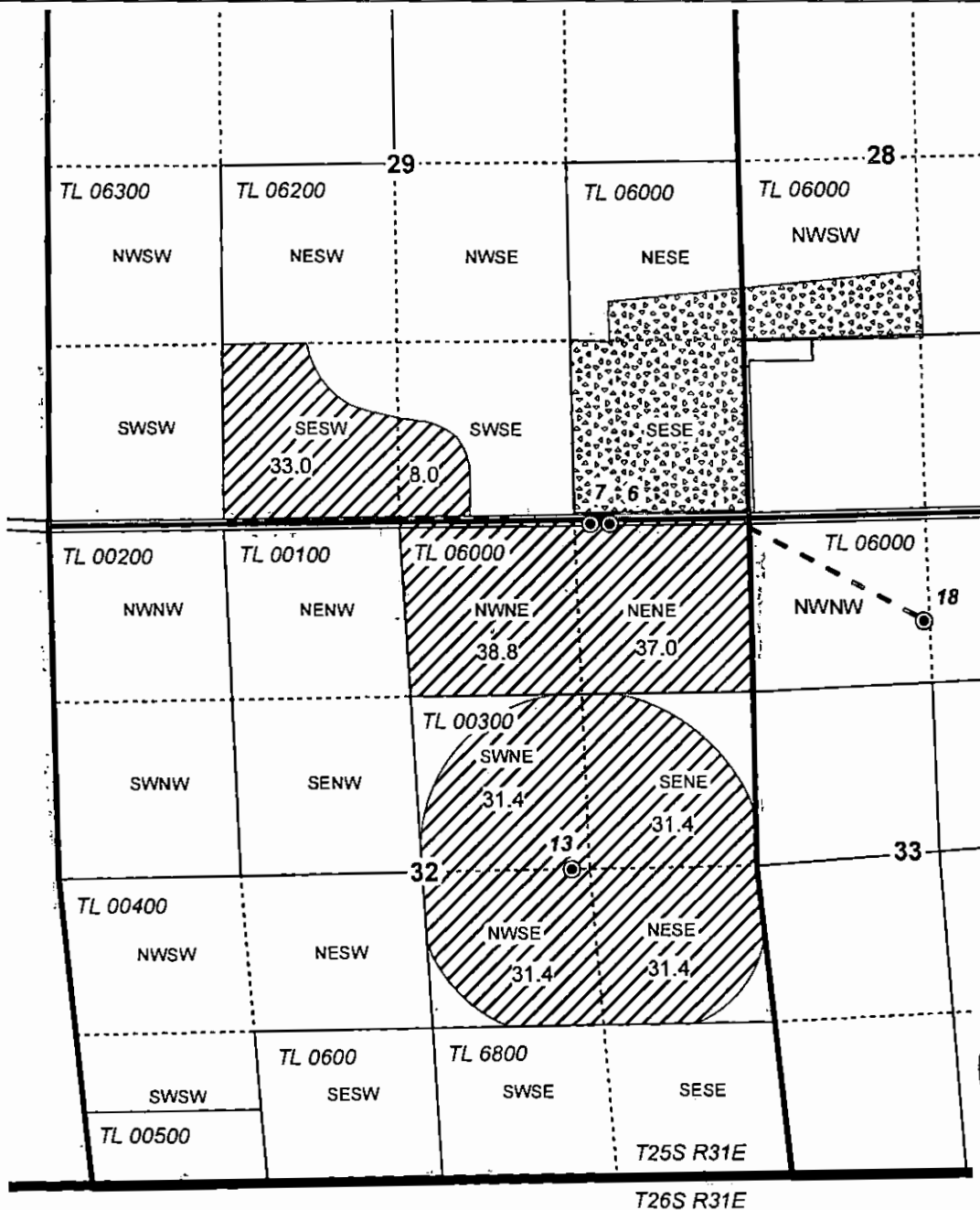

WELL:
 #6:
 40' S AND 1,055' W
 OF NE COR SEC 32
 #7 & METER FOR 6 & 7:
 40' S AND 1,200' W
 OF NE COR SEC 32
 #13 & METER:
 2,630' S AND 1,340' W
 OF NE COR SEC 32
 #18 & METER:
 770' S AND 1,320' E
 OF NW COR SEC 33

0 1,320 Feet
1" = 1,320'

- POU AG
- POU IR
- Township
- Section
- Quarter Quarter
- Tax Lot
- Well
- Buried Pipeline

RECEIVED BY OWRD
 MAR '06 2017

SALEM, OR



RENEWAL DATE: 12/31/2017

CLAIM OF BENEFICIAL USE MAP
 Golden Rule Farms, Inc.
 AP G-14923 PERMIT G-17544

NOTE: THIS MAP IS NOT INTENDED TO
 PROVIDE LEGAL DIMENSIONS OR LOCATIONS
 OF PROPERTY OWNERSHIP LINES.
 PROJECT #16066 DECEMBER 15, 2016

WATER RIGHT SERVICES, LLC
 PO BOX 1830, BEND, OR 97709
 CCB# 197121 www.oregonwater.us
 541-389-2837 JOHNSHORT@USA.COM