

# T.10S. R.3W. Sec. 30 & 31, W.M.

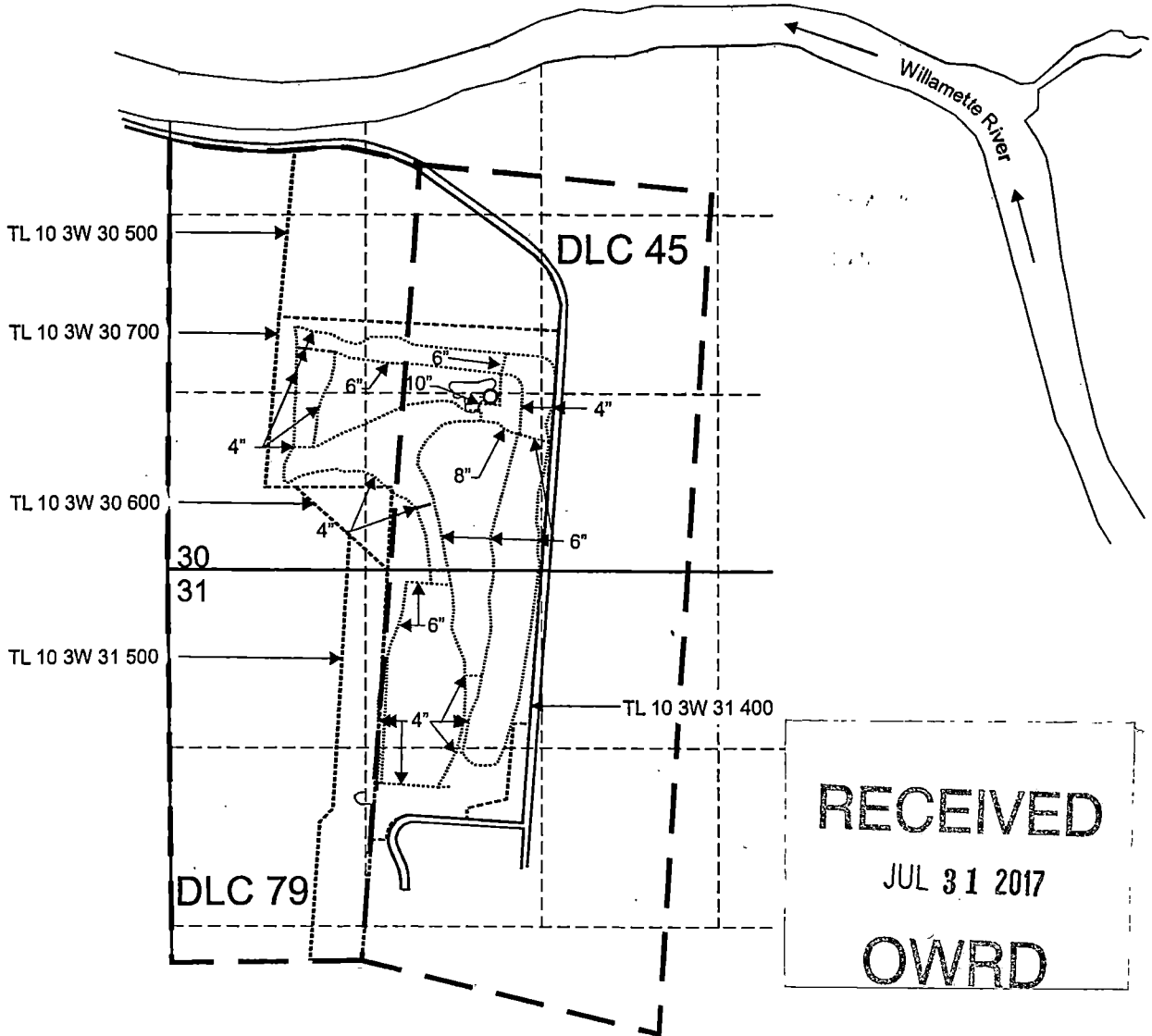

RECEIVED  
 JUL 31 2017  
 OWRD

..... 4", 6", 8" and 10" Mainline

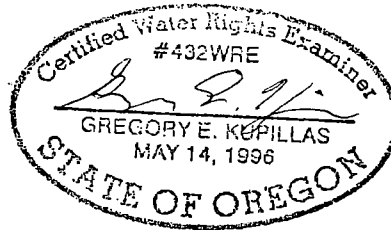

EXPIRATION DATE: 6/30/2019

Scale: 1" = 1,320'

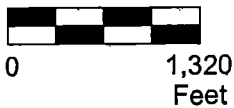

This map was prepared for the purpose of identifying the location of a water right only and is not intended to provide legal dimensions or location of property ownership lines.



Claim of Beneficial Use Map - Mainlines  
 Application S-83845, Permit S-53535

Spring Hill Country Club  
 T.10S. R.3W. Sec. 30 & 31, W.M.

Pacific Hydro-Geology Inc.

Bgp-07/2017-Rvsd

# T.10S. R.3W. Sec. 30 & 31, W.M.

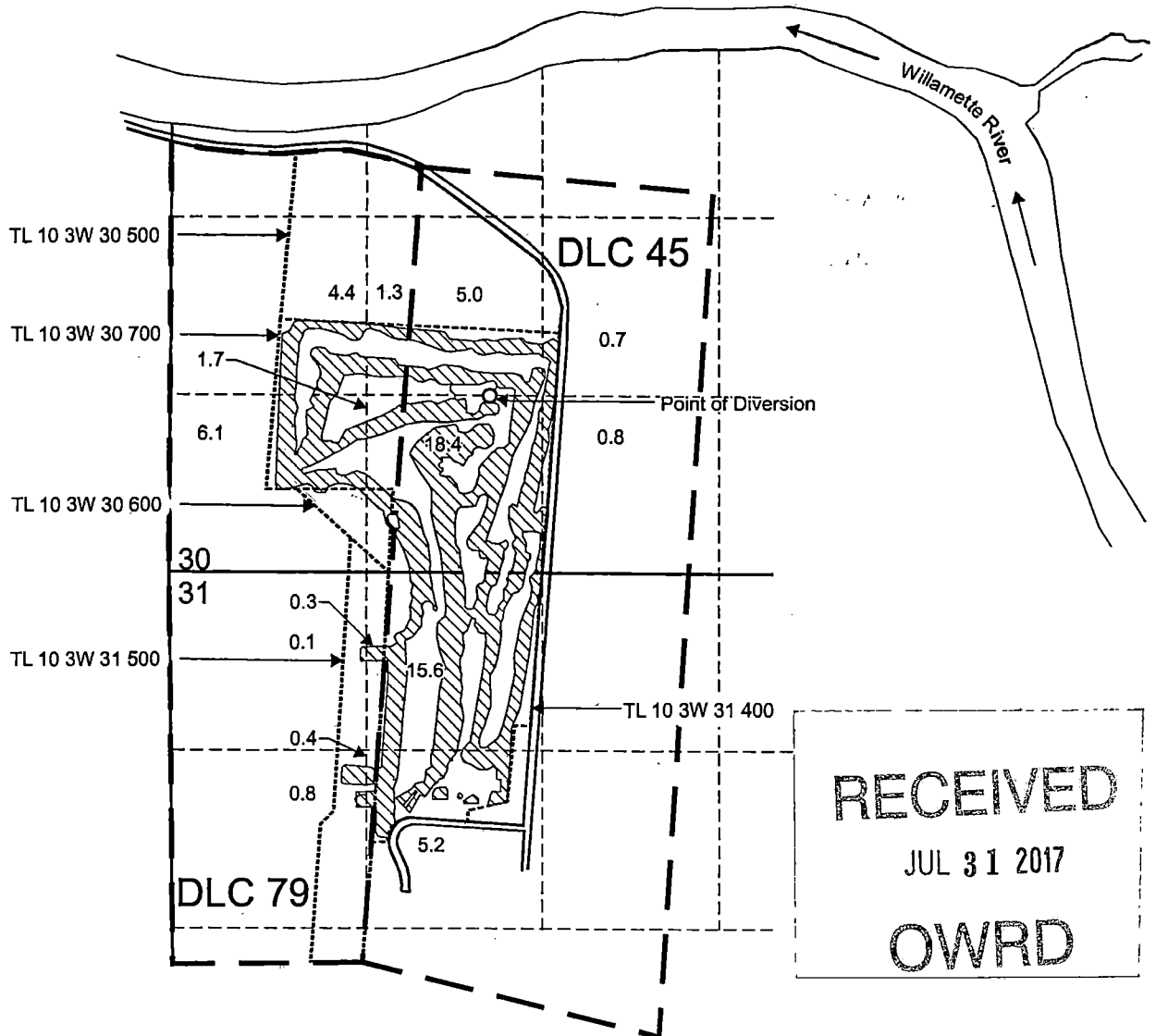

**RECEIVED**  
 JUL 31 2017  
**OWRD**

Point of Diversion is located 1330 feet north and 2370 feet east from the SW corner, Section 30.

Area (60.8 Acres) irrigated under Application S-83845; Permit S-53535

Tax lot boundary

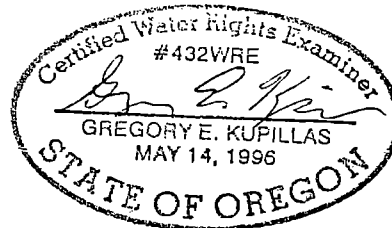

EXPIRATION DATE: 6/30/2019

Scale: 1" = 1,320'

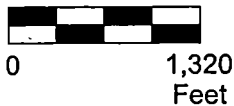

This map was prepared for the purpose of identifying the location of a water right only and is not intended to provide legal dimensions or location of property ownership lines.



**Claim of Beneficial Use Map**  
 Application S-83845, Permit S-53535

Spring Hill Country Club  
 T.10S. R.3W. Sec. 30 & 31, W.M.

Pacific Hydro-Geology Inc.

Bgp-07/2017-Rvsd