

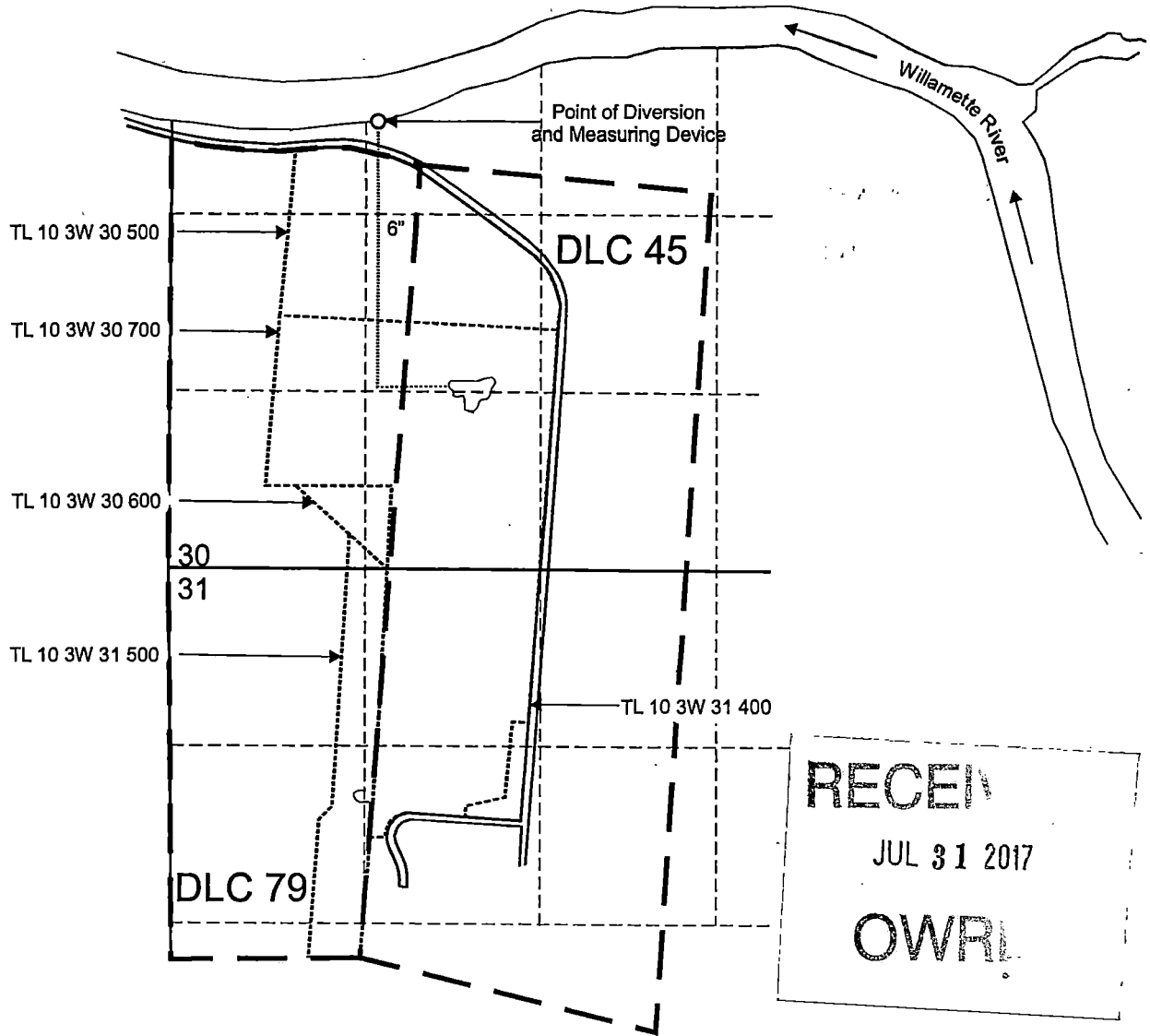



# T.10S. R.3W. Sec. 30 & 31, W.M.



RECEIVED  
 JUL 31 2017  
 OWRI

-  Reservoir constructed under Application R-83398; Permit R-12627
-  POD 1 is located 3350 feet north and 1530 feet east from the SW corner, Section 30.
-  6 inch Mainline

Certified Water Rights Examiner  
 #432WRE  
*Gregory E. Kupillas*  
 GREGORY E. KUPILLAS  
 MAY 14, 1998  
 STATE OF OREGON

EXPIRATION DATE: 6/30/2019

This map was prepared for the purpose of identifying the location of a water right only and is not intended to provide legal dimensions or location of property ownership lines.

Scale: 1" = 1,320'  
  
 0 1,320 Feet



Claim of Beneficial Use Map  
 Application R-83398, Permit R-12627

Spring Hill Country Club  
 T.10S. R.3W. Sec. 30 & 31, W.M.

Pacific Hydro-Geology Inc.

Bgp-07/2017-Rvsd

Spring Hill COBU\_Map.cdr