

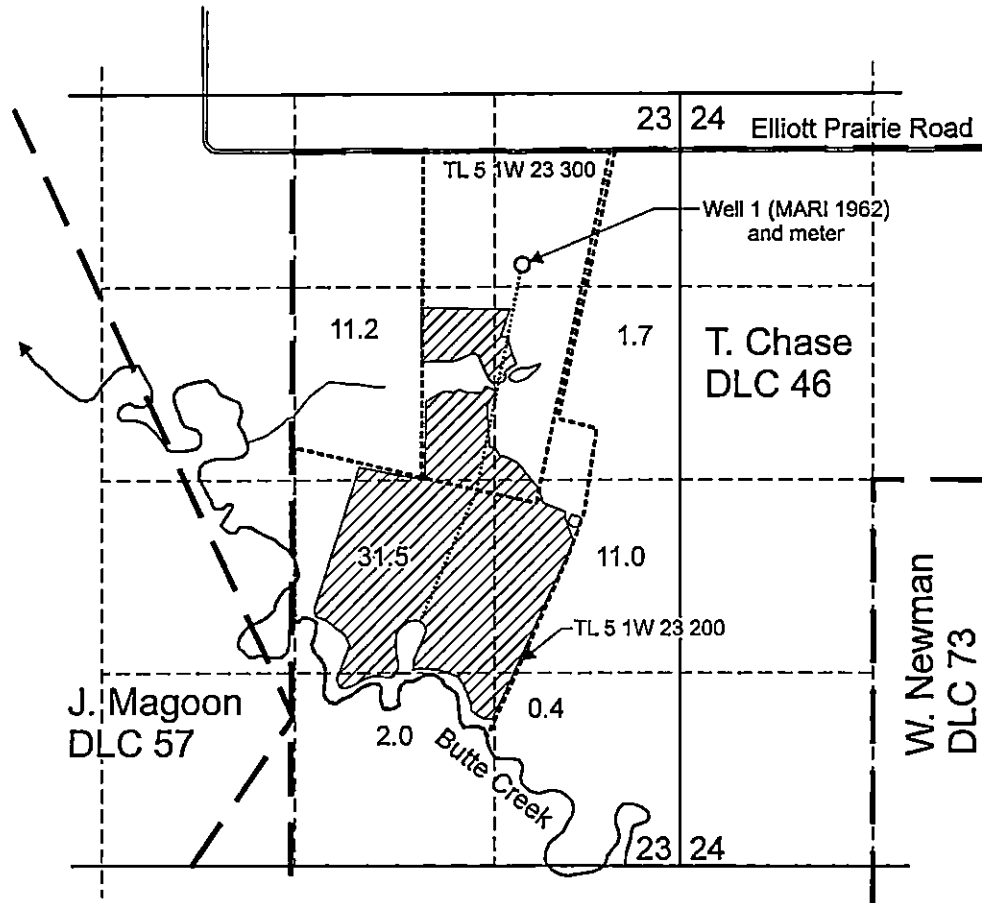



T.5S. R.1W. Sec. 23, W.M.



Well 1 (MARI 1962) is located 775 feet south and 1,560 feet east from the NW corner of DLC 46.

-  Area (57.8 Acres) covered for supplemental irrigation under Application G-12583, Permit G-13117.
-  Tax lot boundary
-  Donation Land Claim boundary
-  Water main line

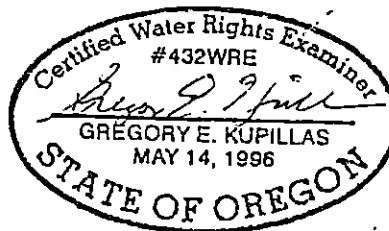

EXPIRATION DATE: 6/30/2015

RECEIVED
JUN 11 2012
STATE OF OREGON
DEPARTMENT OF GEOLOGY

Scale: 1" = 1,320'

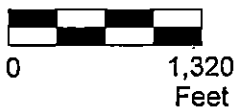

This map was prepared for the purpose of identifying the location of a water right only and is not intended to provide legal dimensions or location of property ownership lines.

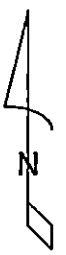

Claim of Beneficial Use Map
Application G-12583, Permit G-13117

Ruffing
T.5S. R.1W. Sec. 23, W.M.

Pacific Hydro-Geology Inc.

06/2012