

REGISTERED

# FINAL PROOF SURVEY MAP IN THE NAME OF TROY HICKOK

AUG 13 1997

WATER RESOURCES DEPT.  
SALEM, OREGON

SECTION 9, TOWNSHIP 26 SOUTH, RANGE 3 WEST, W.M.

APPLICATION 72275

PERMIT 51693

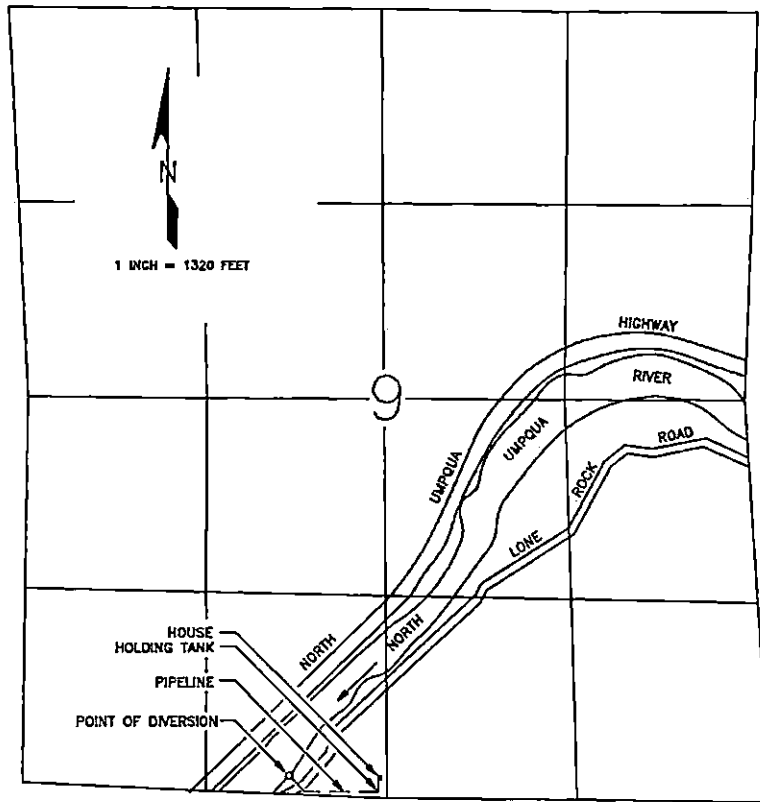

DRW. 97-31

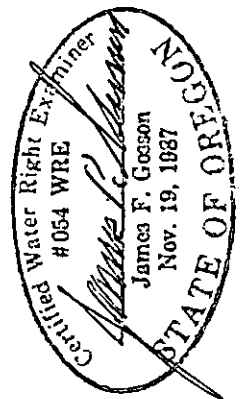

THE POINT OF DIVERSION IS LOCATED 120 FEET NORTH AND 3200 FEET WEST, FROM THE SOUTHEAST CORNER OF SECTION 9; BEING WITHIN THE SE1/4 SW1/4 OF SECTION 9, TOWNSHIP 26 SOUTH, RANGE 3 WEST, W.M., DOUGLAS COUNTY.

THE PURPOSE OF THIS MAP IS TO IDENTIFY THE LOCATION OF THE WATER RIGHT. IT IS NOT INTENDED TO PROVIDE INFORMATION RELATIVE TO PROPERTY OWNERSHIP BOUNDARY LINES.