

1108

1108

Claim of Beneficial Use - Place of Use Map
Application G-9583; Permit G-9866
Water Right in the Name of City of Troutdale
Multnomah County
Township 1 North, Range 3 and 4 East;
Township 1 South, Range 3 East (W.M.)

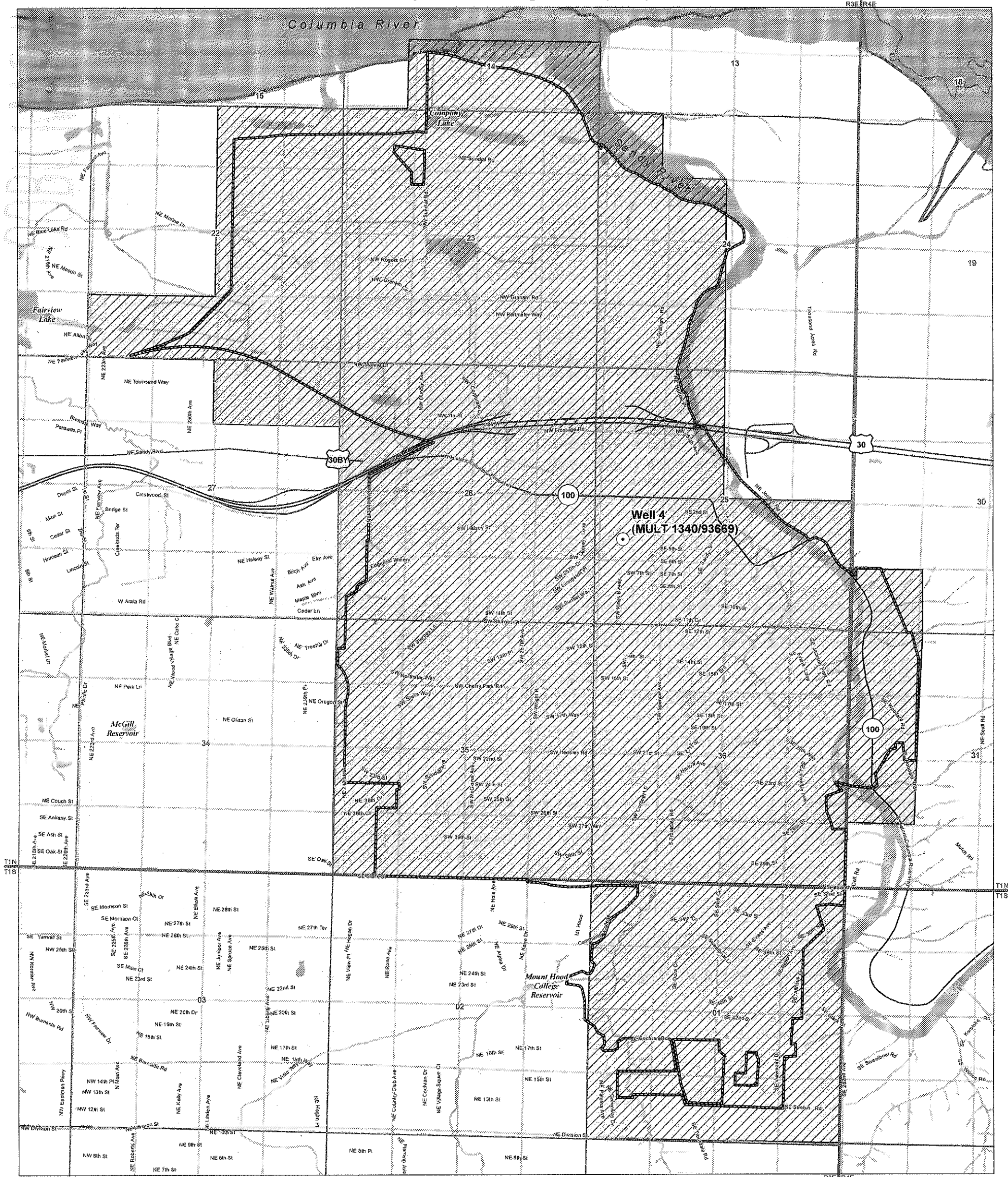

- LEGEND**
- Point of Appropriation (POA)
 - ▨ Place of Use (POU)
 - ▭ Troutdale City Limits
 - Street
 - ~ Watercourse, Perennial
 - - - Watercourse, Intermittent
 - Waterbody

Certified Water Rights Examiner Stamp

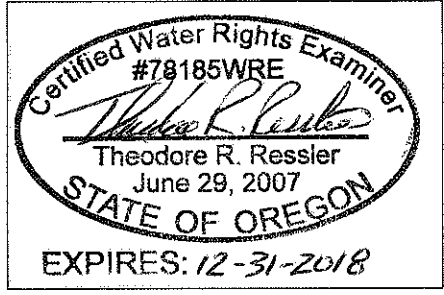

DISCLAIMER
 This map was prepared for the purpose of identifying the location of a water right only and it is not intended to provide legal dimensions or location of property ownership lines.

MAP NOTES
 Date: May 31, 2017
 Data Sources: OWRD, US BLM, USGS, OGIC, ESRI
 Prepared By: GSI Water Solutions, Inc.

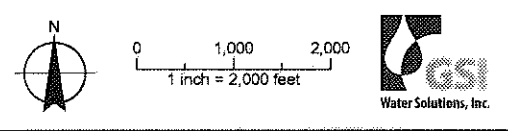

RECEIVED
 JUL 03 2017
 OWRD
 1108