

1109

1109

**Claim of Beneficial Use - Place of Use Map**  
**Application G-13565; Permit G-11761**  
**Water Right in the Name of City of Troutdale**  
**Multnomah County**  
**Township 1 North, Range 3 and 4 East;**  
**Township 1 South, Range 3 East (W.M.)**

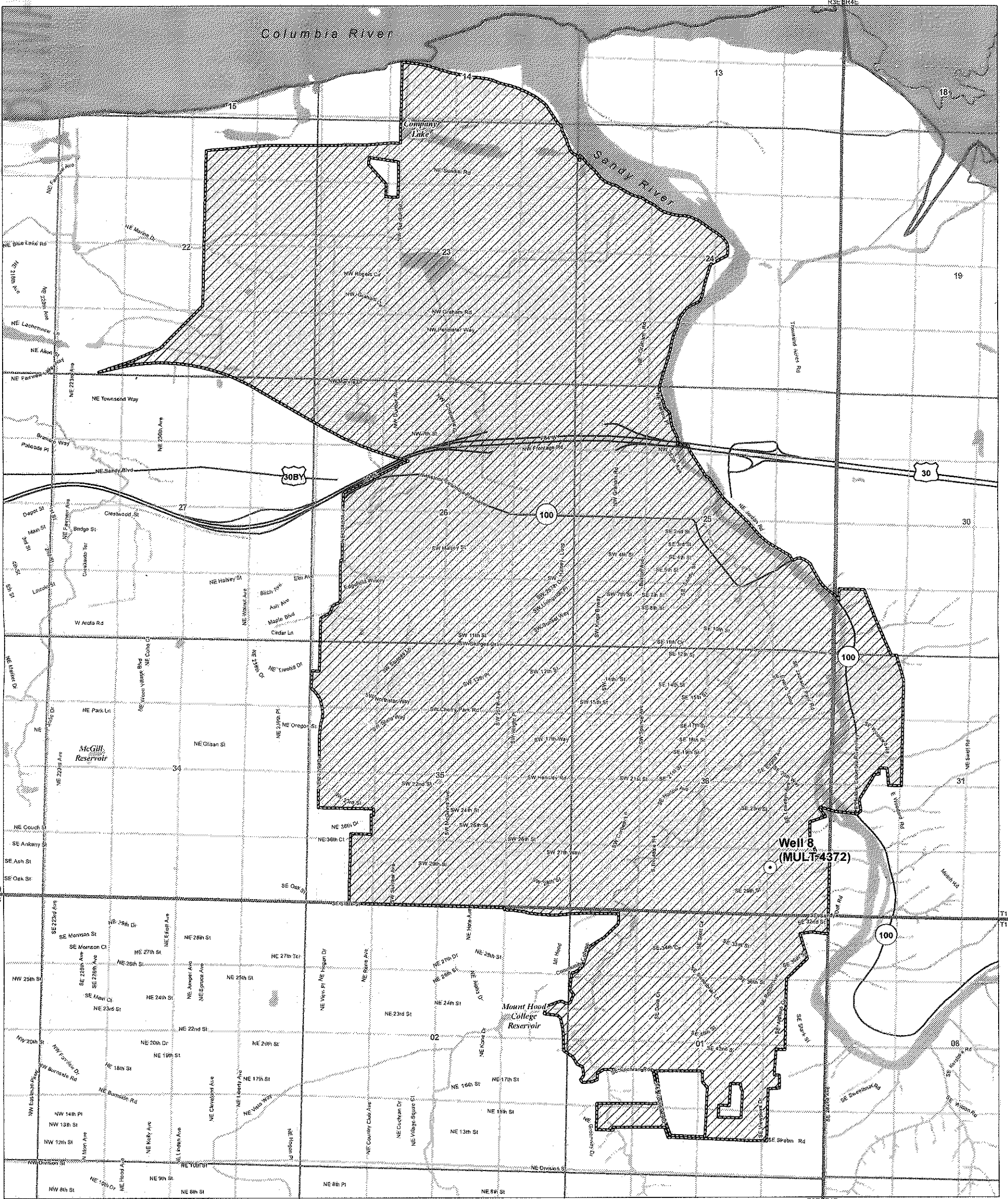

**LEGEND**

- Point of Appropriation (POA)
- ▨ Place of Use (POU)
- ▭ Troutdale City Limits
- Street
- ~ Watercourse, Perennial
- - - Watercourse, Intermittent
- Waterbody

**Certified Water Rights Examiner Stamp**

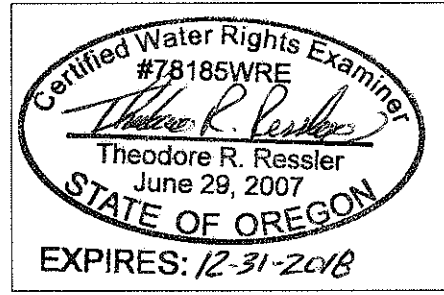

RECEIVED  
 JUL 03 2017  
 OWRD

**DISCLAIMER**  
 This map was prepared for the purpose of identifying the location of a water right only and it is not intended to provide legal dimensions or location of property ownership lines.

**MAP NOTES**  
 Date: May 31, 2017  
 Data Sources: OWRD, US BLM, USGS, OGIC, ESRI  
 Prepared By: GSI Water Solutions, Inc.

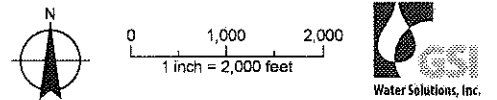

1109

# Claim of Beneficial Use - Point of Appropriation Map Application G-13565; Permit G-11761

Water Right in the Name of City of Troutdale  
Multnomah County  
Township 1 North, Range 3 East, Section 36 (W.M.)

RECEIVED  
JUL 03 2017  
OWRD



Document Path: P:\Portman\221 - Troutdale\008 - Water Rights Services\Project\_GIS\Project\_mxd\COBU\_POD\_G-11761.mxd

### LEGEND

- Point of Appropriation (POA)
- Watercourse, Perennial
- Watercourse, Intermittent
- Waterbody
- Tax Lot
- Donation Land Claim (DLC)

### POA LOCATION DESCRIPTION

**Well 8 (MULT 4372)**  
Located 950 feet North and 1,280 feet  
West from the Southeast corner of Section 36,  
Township 1 North, Range 3 East (W.M.)

### Certified Water Rights Examiner Stamp

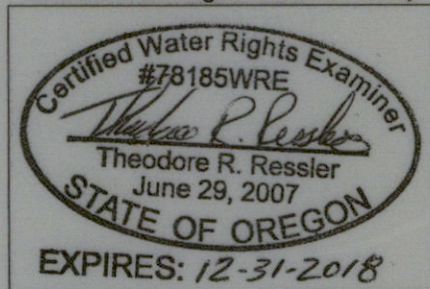

**DISCLAIMER**  
This map was prepared for the purpose of identifying the location of a water right only and it is not intended to provide legal dimensions or location of property ownership lines.

### MAP NOTES

Date: May 31, 2017  
Data Sources: BLM, OWRD, ESRI,  
Multnomah Co., USGS

