

TRANSFER APPLICATION MAP
Certificate 41697
Sections 29, 30, 31 & 32, T15S, R5W, W.M., and
Section 36, T15S, R5W, W.M., and
Sections 5, 6, 8, 17, 20, 21 & 29, T16S, R4W, W.M., Lane County
City of Junction City



EXPLANATION

<p>AUTHORIZED LANDS</p> <p> CERTIFICATE 41697 MUNICIPAL RIGHTS PRIORITY: 9/20/1968</p> <p> POINT OF DIVERSION (POD)</p>	<p>PROPOSED LANDS</p> <p> CERTIFICATE 41697 MUNICIPAL RIGHTS PRIORITY: 9/20/1968</p>
--	---

- NOTES:**
1. The Authorized Lands are based on the quarters and quarter-quarters listed in Certificate 41697 and may include lands outside the City service area boundary.
 2. The water system piping is shown on a separate map.



RECEIVED BY OW
 NOV 14 2016
 SALEM, OR

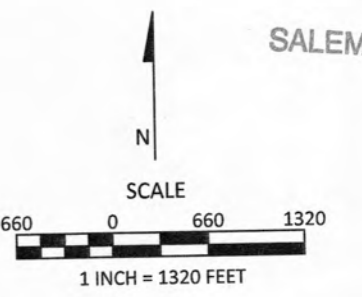

October 25, 2016

This map is not intended to provide legal dimensions or locations of property ownership lines

FIGURE 1

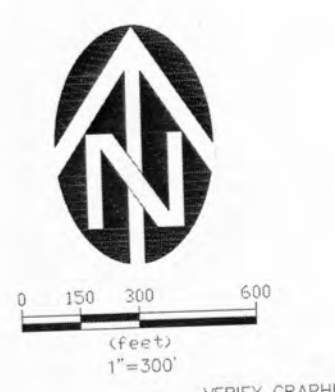
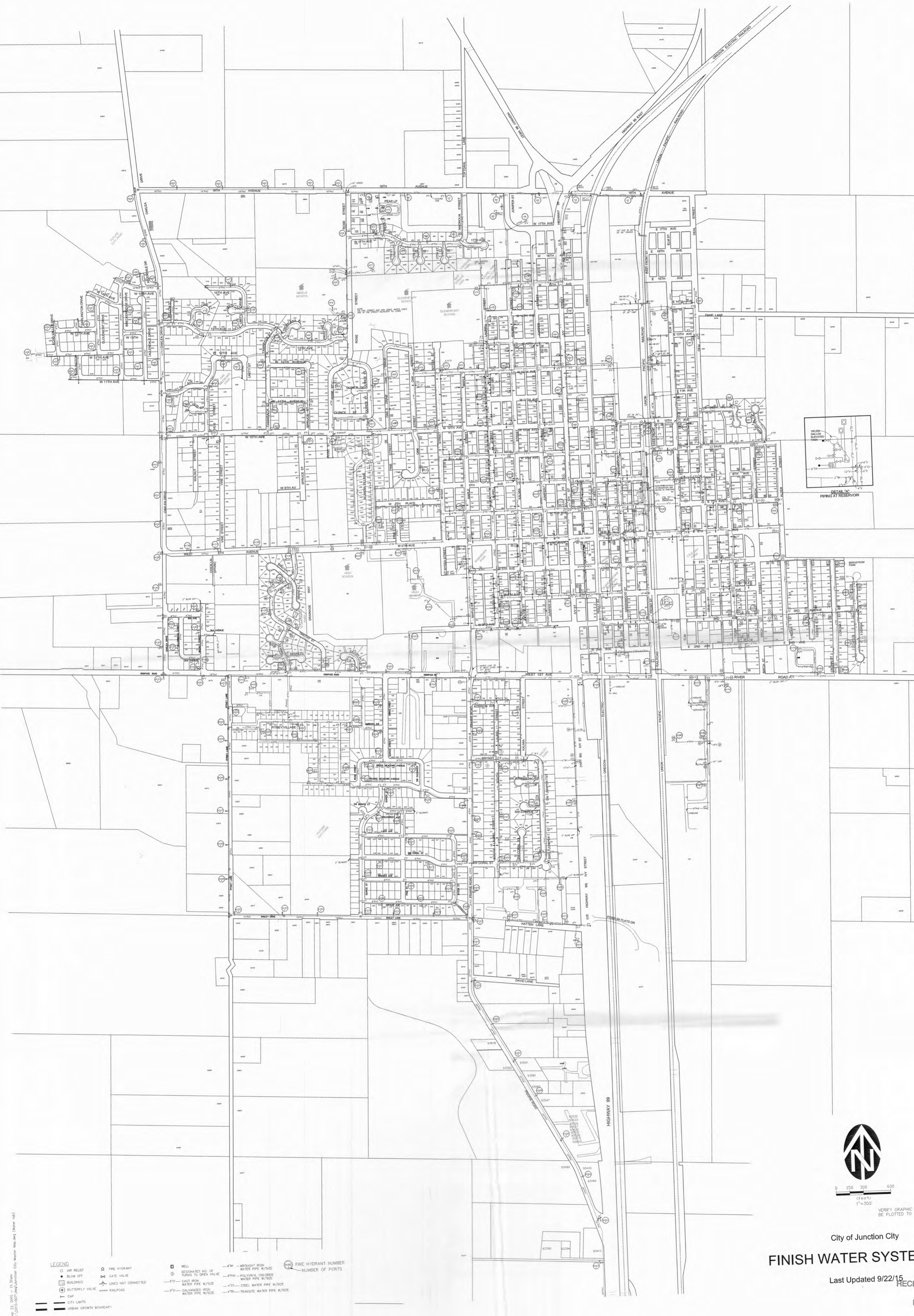

LEGEND

□ AIR RELIEF	● FIRE HYDRANT	□ WELL	— 4\"/>
● BLEND OFF	● GATE VALVE	○ DESIGNATES NO. OF PORTS TO OPEN VALVE	— 6\"/>
▢ BUILDINGS	— LINES NOT CONNECTED	— 8\"/>	
⊕ BUTTERFLY VALVE	— RAILROAD	— 10\"/>	
— CAP	— CITY LIMITS	— 12\"/>	
— URBAN GROWTH BOUNDARY		— 15\"/>	

FIRE HYDRANT NUMBER OF PORTS

Date: 11/13/2015 11:58 AM
 User: 2017-0071 (City of Junction City)

City of Junction City
FINISH WATER SYSTEM M

Last Updated 9/22/15 RECEIVED BY

NOV 14 2015
 SALEM, OR