

Well #1 located 1220' S. & 1760' W. from N.E. Corner Section 18

Well #2 located 80' N. & 350' E. from S. & E. Corner Section 6

Well #1 Primary  
 Well #1 Supplemental  
 Well #2 Primary  
 Well #2 Supplemental



## FINAL PROOF SURVEY

UNDER

Application No. G-3939 Permit No. G-3530

IN NAME OF,

STONE MACHINERY CO.

Surveyed April 14, 1973, by L. E. Gould

# T.3N. R.28E. W.M.

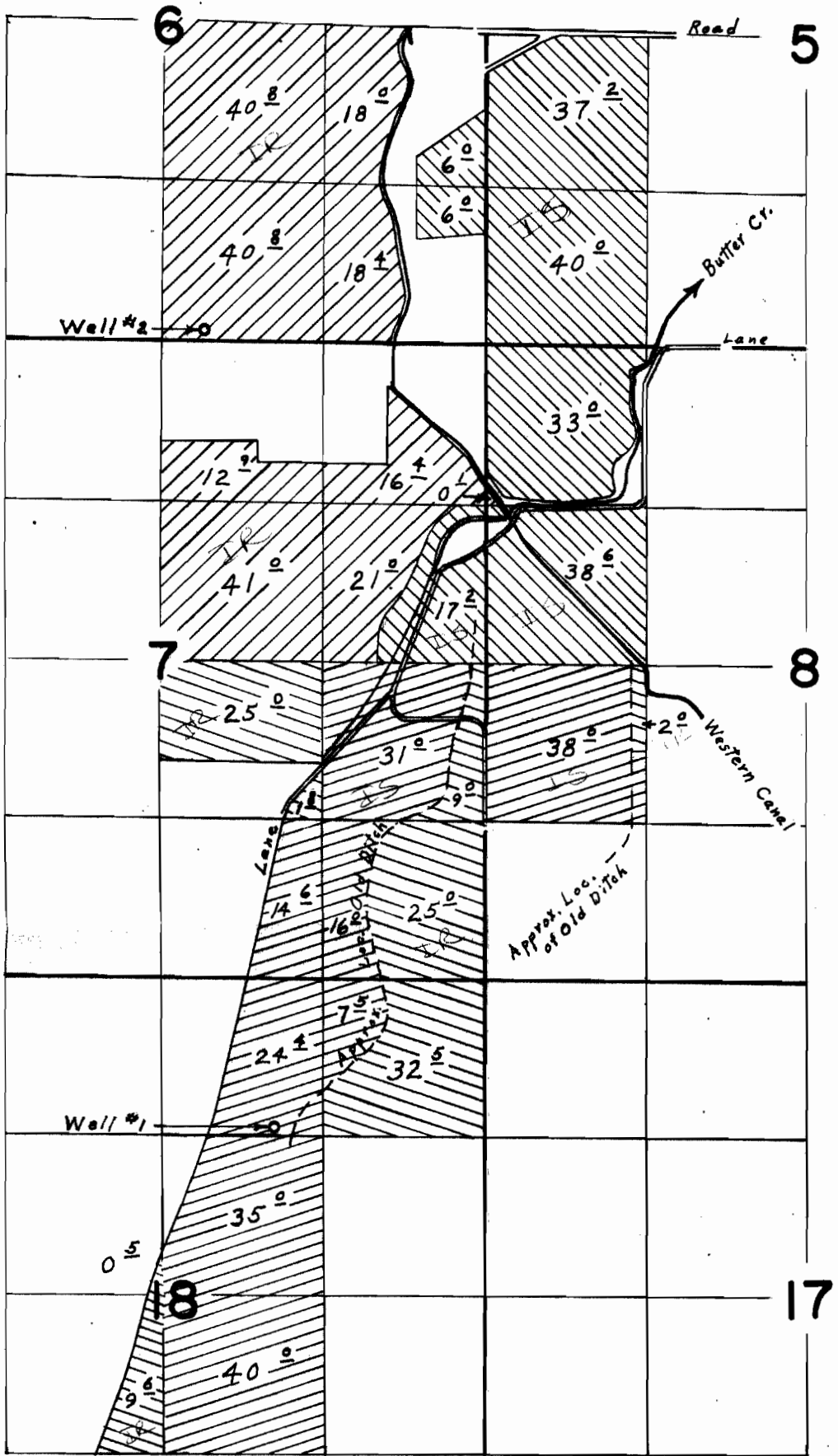

Well # 1 located 1220' S. & 1760' W. from N.E. Corner Section 18  
 Well # 2 located 80' N. & 330' E. from S. 1/4 Corner Section 6

- Well #1 Primary
- Well #1 Supplemental
- Well #2 Primary
- Well #2 Supplemental



## FINAL PROOF SURVEY

UNDER

Application No. G-3939 Permit No. G-3530

IN NAME OF

STONE MACHINERY CO.

Surveyed April 14, 1973, by L. E. Gould