

CLAIM OF BENEFICIAL USE
 FOR: ROBERT AND DEBORAH WALKER
 BY: DUANE W. KIRBY
 SEC 21, T26S, R5W, W.M.
 APPLICATION NO S-87752
 PERMIT NO S-54777
 LOT NO 700

4075 100
 VBB 2 308
 (13) 1000 100 20

FISH SCREEN IS LOCATED AT POD
 SCALE: 1" = 400'

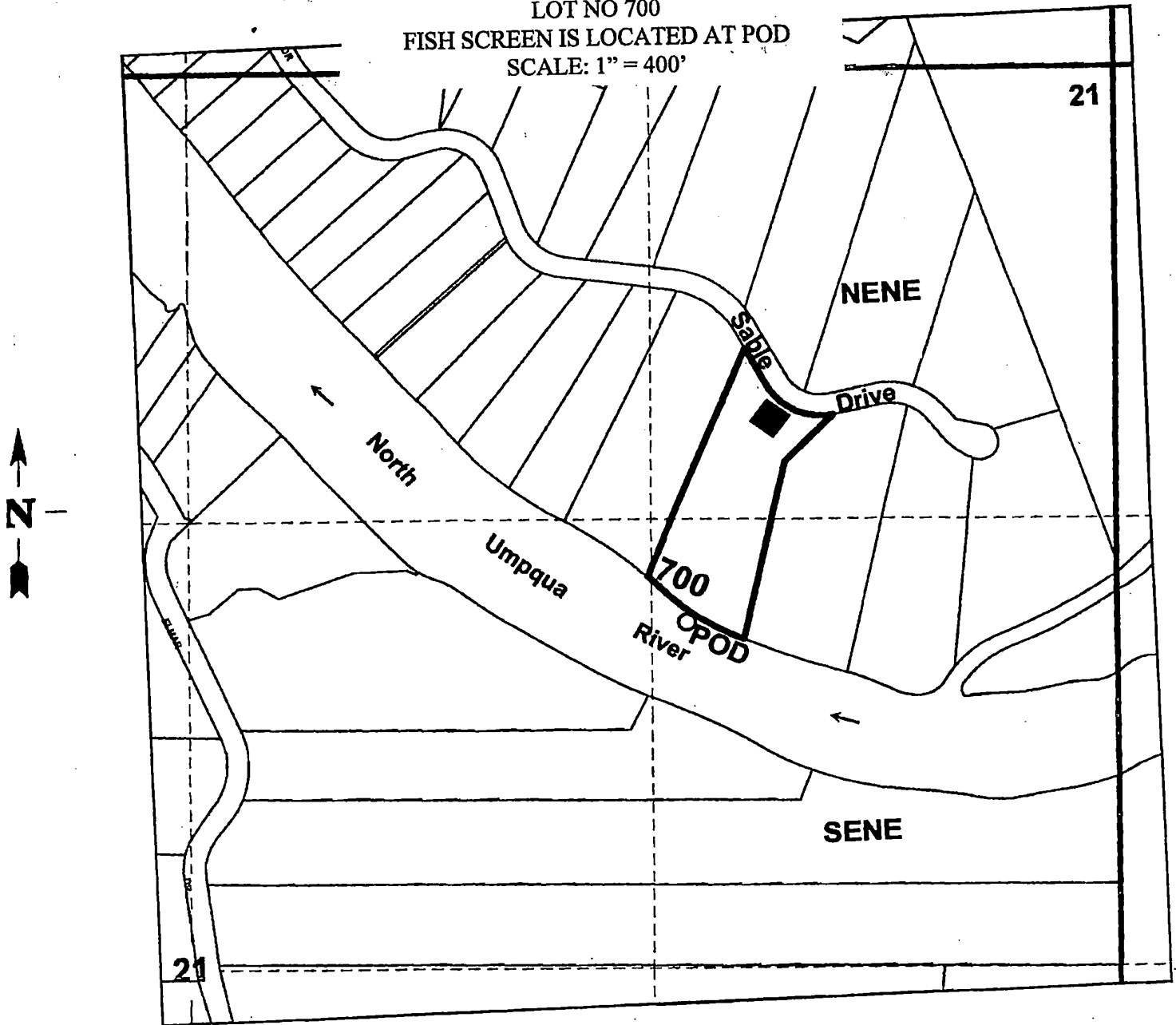

Point of Diversion is 1625 ft. south and 1220 ft. west from the NE corner of Section 21.

THE PURPOSE OF THIS MAP IS TO IDENTIFY THE LOCATION OF THE WATER RIGHT. IT IS NOT INTENDED TO PROVIDE INFORMATION RELATIVE TO THE LOCATION OF PROPERTY OWNERSHIP BOUNDARY LINES.

Certified Water Right Examiner
 2214 WRE
Duane W. Kirby
 Duane W. Kirby
 May 30, 1989
 STATE OF OREGON