

**T15S R16E SECTION 31 &  
T16S R15E SECTION 1, WM**

CROOK COUNTY, OREGON

RECEIVED BY



AUG 11 2017

0 1,320 Feet

1" = 1,320'



POU IR



POD # 9

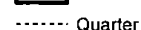

Township

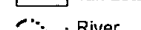

Section

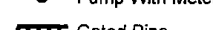

Quarter Quarter

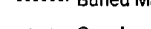

Tax Lots



River



Pump With Meter

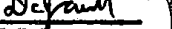

Gated Pipe



Buried Mainlines

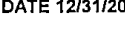

Canal

POD LOCATION:

#9 60' N 1,940' W OF SE COR SEC 36

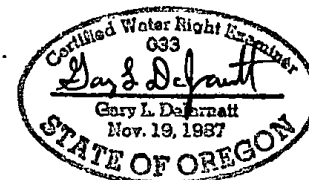

RENEWAL DATE 12/31/2017

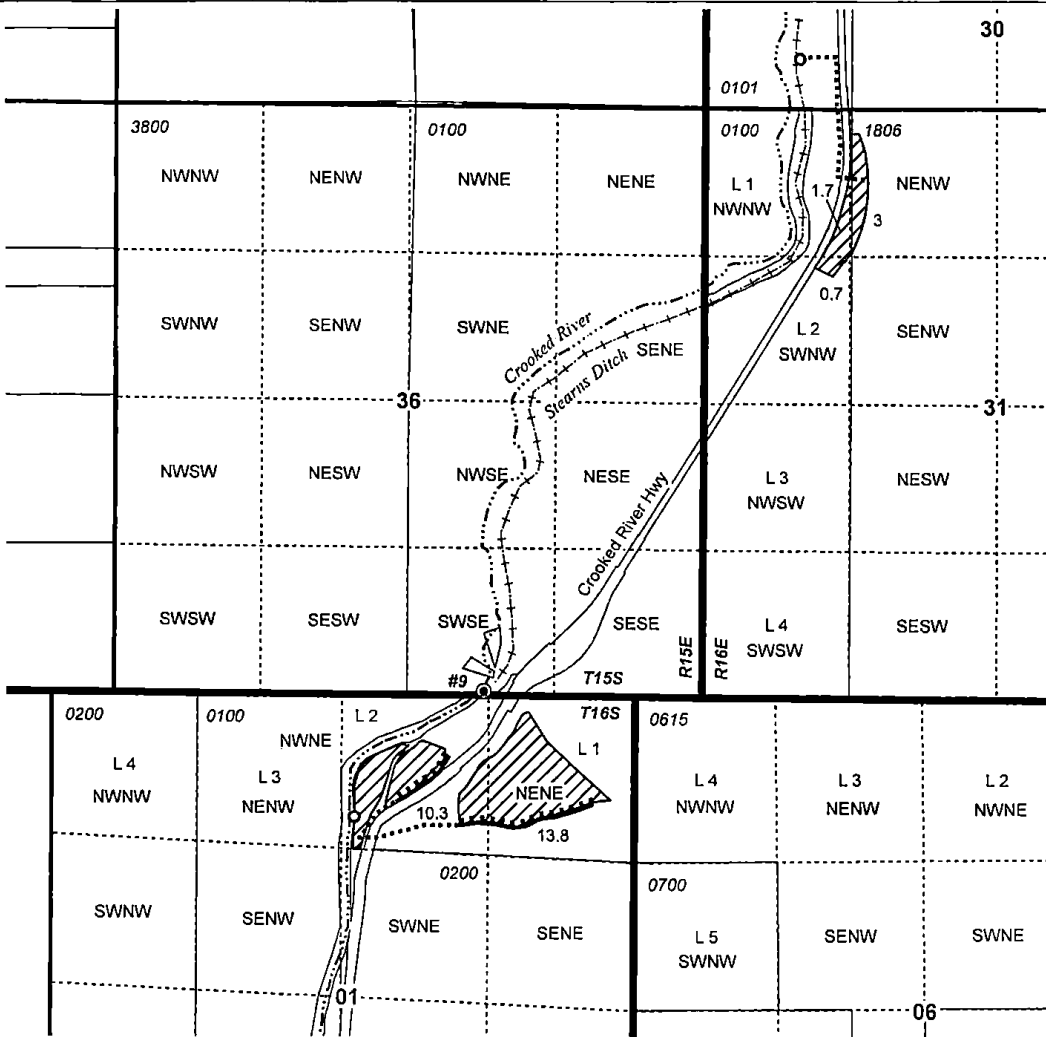

**CLAIM OF BENEFICIAL USE**  
Quail Valley Ranch, LLC

TRANSFER T-9171

NOTE: THIS MAP IS NOT INTENDED TO  
PROVIDE LEGAL DIMENSIONS OR LOCATIONS  
OF PROPERTY OWNERSHIP LINES.

JOB # 17044

**WATER RIGHT SERVICES, LLC**

PO BOX 1830, BEND, OR 97709

CCB# 197121 [www.oregonwater.us](http://www.oregonwater.us)

541-389-2837 [JOHNSHORT@USA.COM](mailto:JOHNSHORT@USA.COM)

JUNE 26, 2017