

DESCHUTES COUNTY, OREGON

1" = 400'

**T 20 S, R 10 E, WM**

SECTION 23 NESE  
SWSE  
SESE

SECTION 24 NWSW  
SWSW

APP G-14268 PERMIT G-13239 T-10182

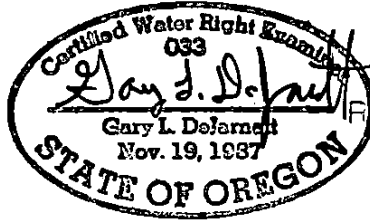

RECEIVED E

MAR 24

RENEWAL DATE: 12-31-2013

SALEM

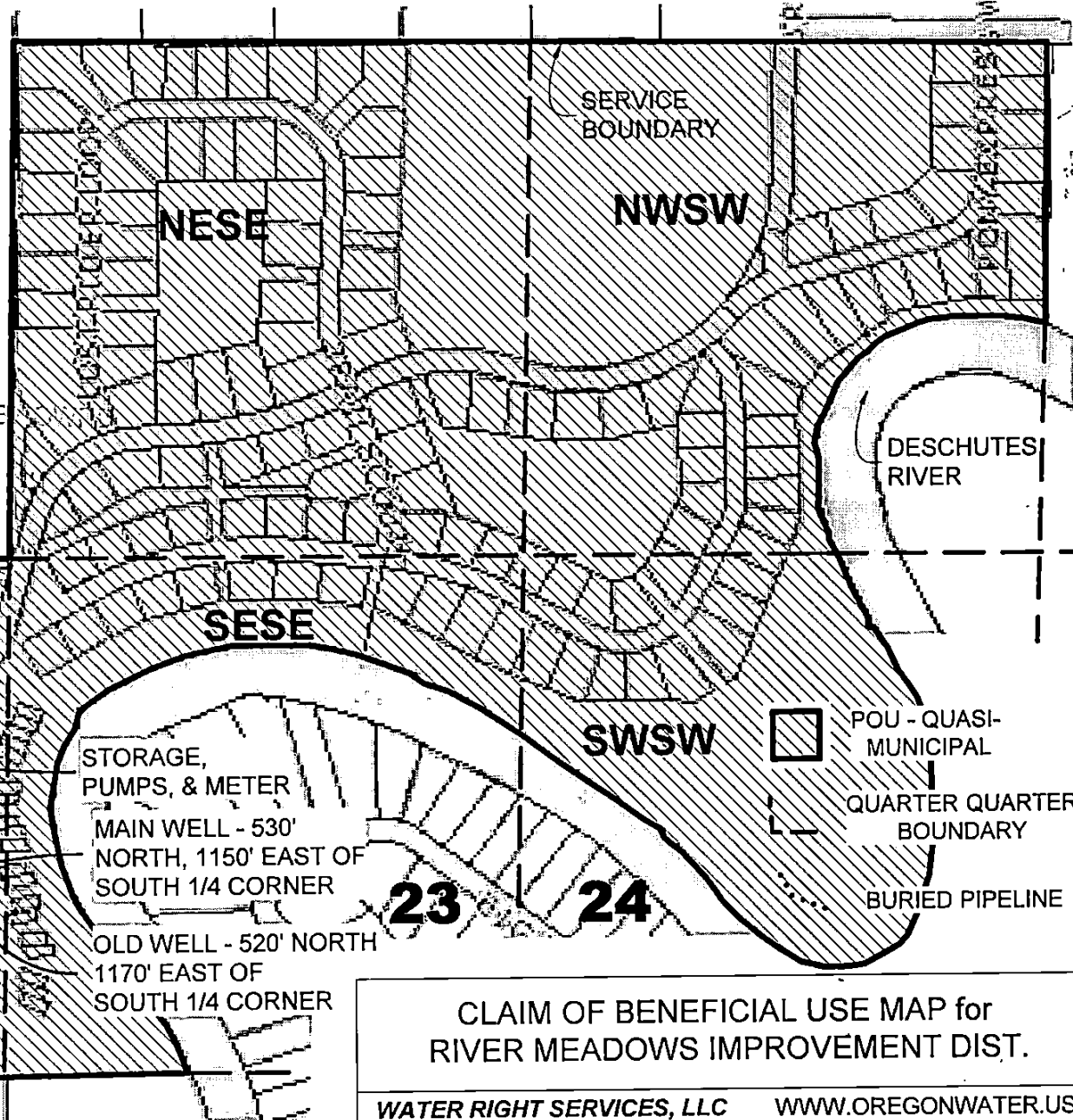

SWSE

SESE

SWSW

NESE

NWSW

DESCHUTES RIVER

STORAGE,  
PUMPS, & METER  
MAIN WELL - 530'  
NORTH, 1150' EAST OF  
SOUTH 1/4 CORNER

OLD WELL - 520' NORTH  
1170' EAST OF  
SOUTH 1/4 CORNER

POU - QUASI-MUNICIPAL

QUARTER QUARTER BOUNDARY

BURIED PIPELINE

**23 24**

S 1/4 CORNER

**CLAIM OF BENEFICIAL USE MAP for  
RIVER MEADOWS IMPROVEMENT DIST.**

**WATER RIGHT SERVICES, LLC**  
P.O. BOX 1830, BEND OR 97709

**WWW.OREGONWATER.US**  
(541) 389-2837 CCB# 197121

DATE  
FEB 26, 2013

JOHNSHORT@USA.COM

JOB#  
13016

NOTE: THIS MAP IS NOT INTENDED TO PROVIDE LEGAL DIMENSIONS OR LOCATIONS OF PROPERTY OWNERSHIP LINES.