

NOV 25 2014

RECEIVED

# T.2N. R.1W. Sec. 2, 3, 4, 9, 10 & 11, W.M.

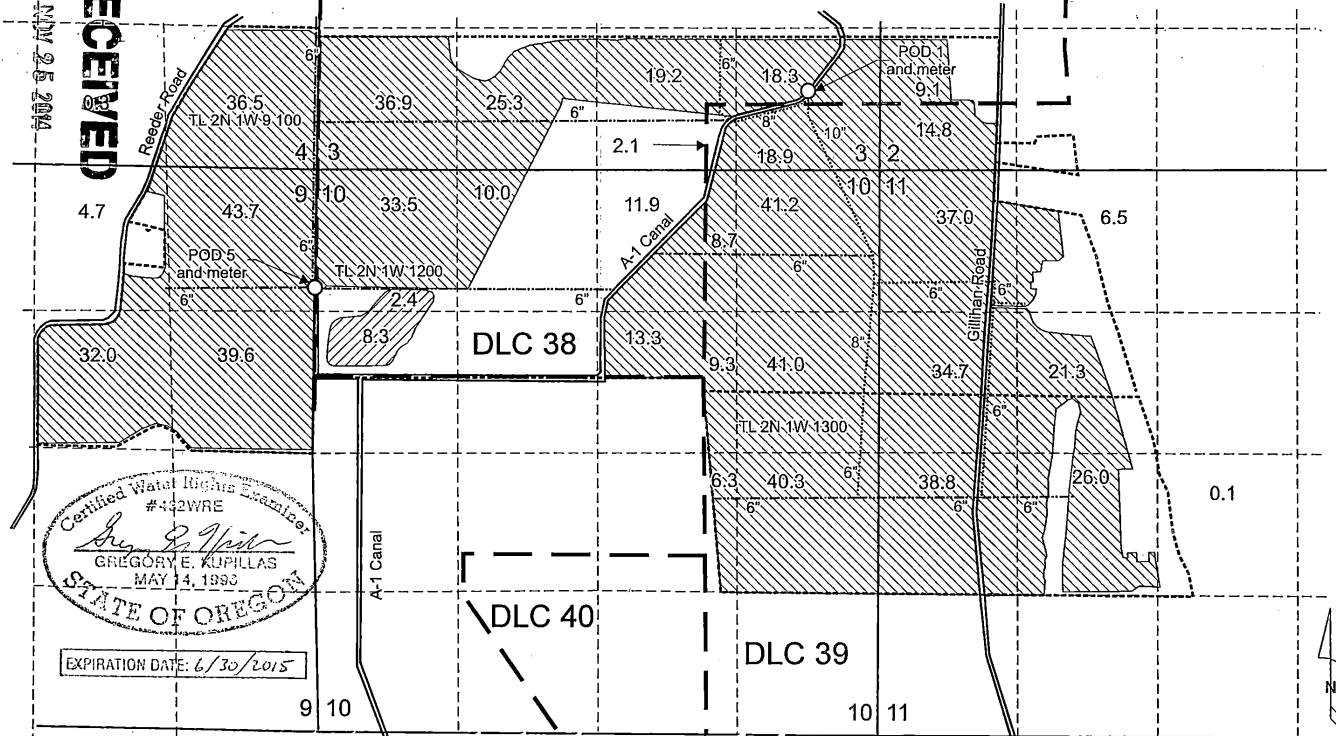

Certified Water Rights Examiner  
#442WRE  
*Gregory E. Kupillas*  
GREGORY E. KUPILLAS  
MAY 14, 1993  
STATE OF OREGON

EXPIRATION DATE: 6/30/2015

Point of diversion 1 is located 740 feet north and 670 feet west from the NE corner, Section 10.  
Point of diversion 5 is located 1,110 feet south and 30 feet east from the NW corner, Section 10.

- Area (681.3 Acres) irrigated under Application S-84823, Permit S-53838.
- Area (10.7 Acres) for wildlife use under Application S-84823, Permit S-53838.
- Buried 6, 8, and 10-inch PVC Mainline
- Above-ground 6-inch Aluminum Mainline
- Tax lot boundary

Scale: 1" = 1,320'



0 1,320 Feet

This map was prepared for the purpose of identifying the location of a water right only and is not intended to provide legal dimensions or location of property ownership lines.

**Claim of Beneficial Use Map**  
Application S-84823, Permit S-53838

Jacobson Family Properties LP  
T.2N. R.1W. Sec. 2, 3, 4, 9, 10 & 11, W.M.

2014 - bgp

Pacific Hydro-Geology Inc.