

RECEIVED

APR 14 2017

OWRD

T39S, R36E
SECTIONS 28 AND 29

HARNEY COUNTY, OREGON

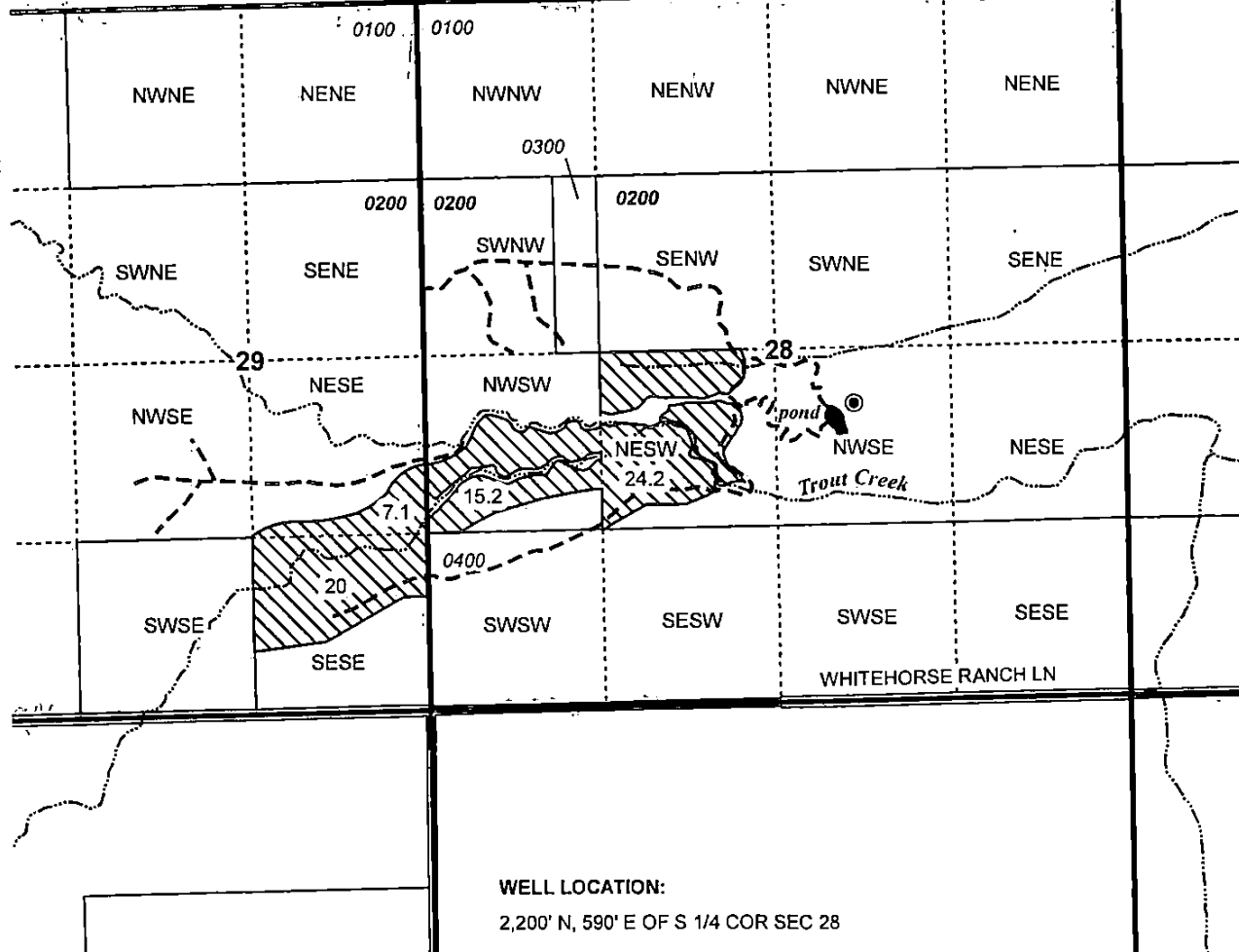

WELL LOCATION:
2,200' N, 590' E OF S 1/4 COR SEC 28

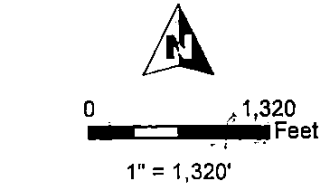

- POU IS
- Section
- Quarter Quarter Section
- Taxlot
- Stream
- Canal
- Well
- Pond

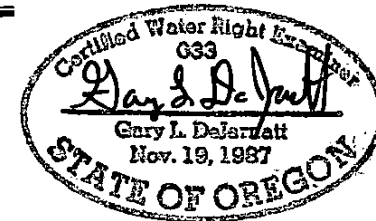

RENEWAL DATE 12/31/2017.

CLAIM OF BENEFICIAL USE
Wrench Ranch, LLC

NOTE: THIS MAP IS NOT INTENDED TO
PROVIDE LEGAL DIMENSIONS OR LOCATIONS
OF PROPERTY OWNERSHIP LINES.

WATER RIGHT SERVICES, LLC

PO BOX 1830, BEND, OR 97709

CCB# 197121 www.oregonwater.us

AP G-15804

PERMIT G-15337

PROJECT #15106

JANUARY 4, 2017

541-389-2837 JOHNSHORT@USA.COM