

Partial Cancellation of Silvies River Decree (1926) Silvies Valley Ranch

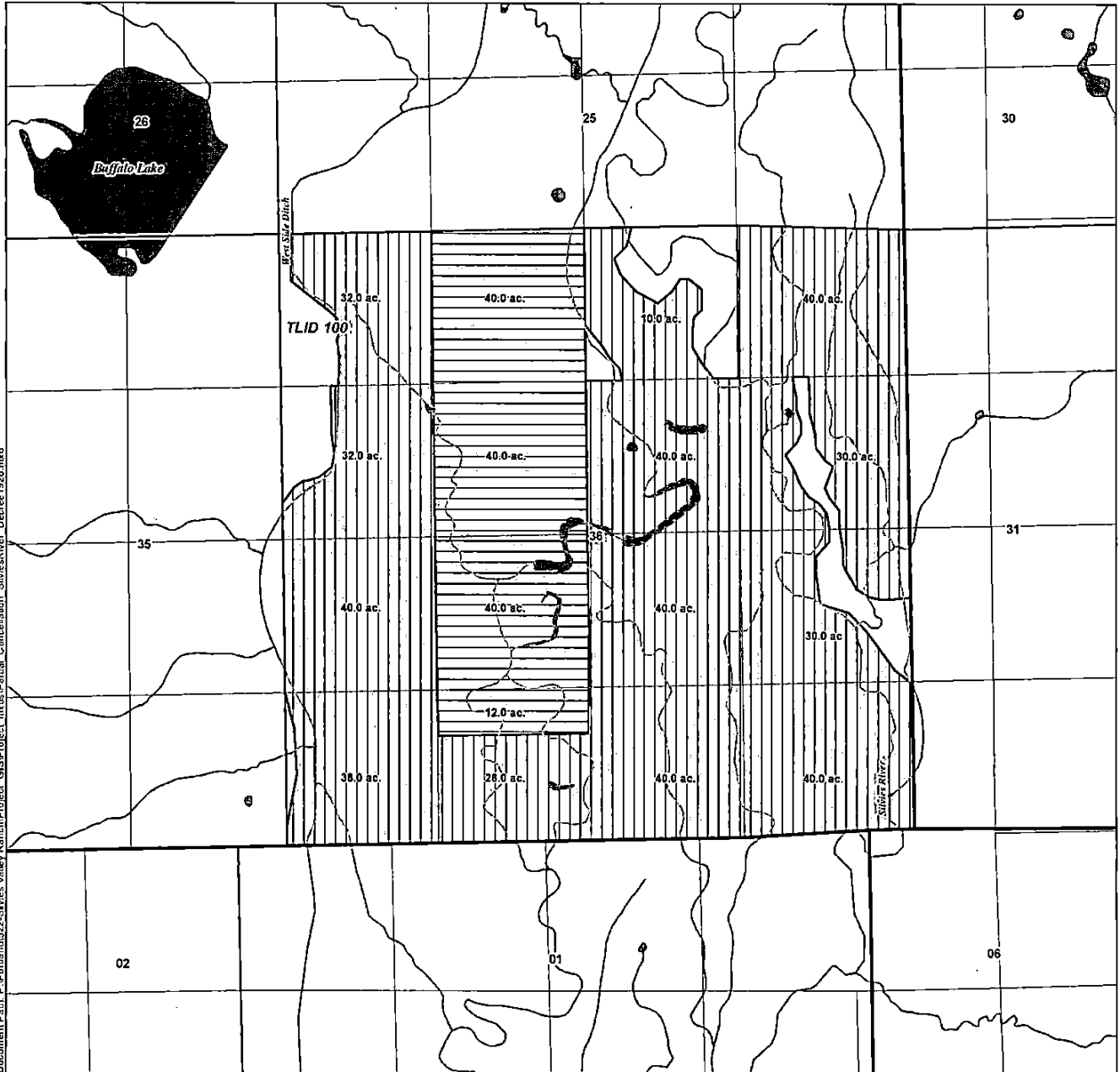

Grant County

Township 18 South, Range 31 East, Section 36 (W.M.)





LEGEND

Silvies River Decree (1926), POU*

-  Acreage Remaining
-  Acreage to be Cancelled

All Other Features

-  Watercourse
-  Waterbody

RECEIVED BY OWRD

DEC 22 2017

SALEM, OR

DISCLAIMER

This map was prepared for the purpose of identifying the location of a water right only and it is not intended to provide legal dimensions or location of property ownership lines.

MAP NOTES

Date: December 11, 2017
Data Sources: BLM, USGS, OWRD

*Place of use shown is only the portion of the water right within Section(s) containing the acreage to be cancelled.

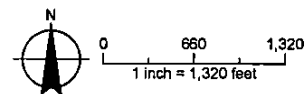

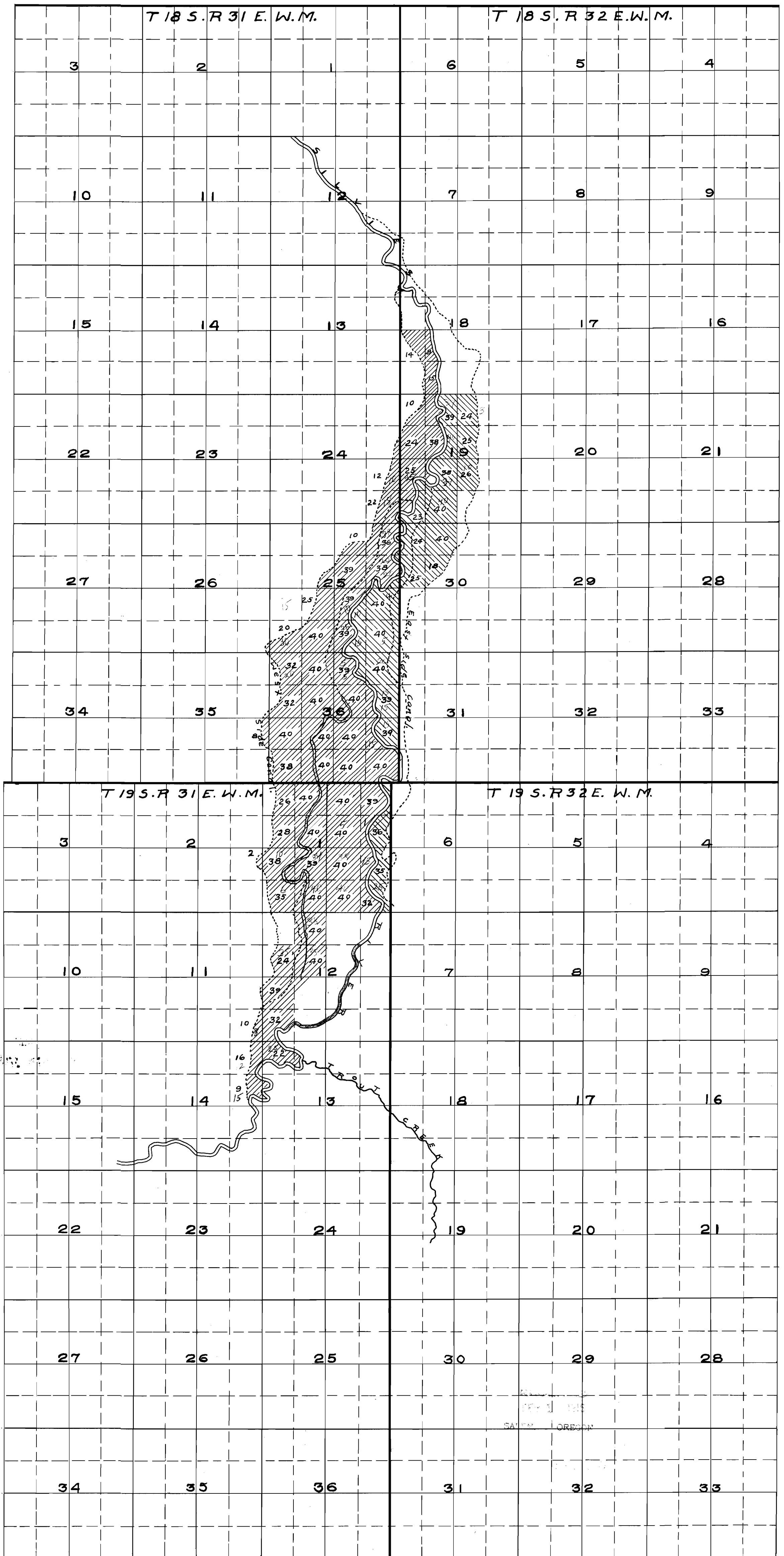

Map No. 4089
 Section No. 3366

MAP
 of
 Pacific Live Stock Co's.
 Silvies Valley East
 and
 West Side Canals.
 and
 Land Irrigated under each.

I, *W. A. Griffing*, of San Francisco, Calif., do hereby certify that this map was made from notes taken during an actual survey made by me during October & November, 1914, and that it correctly represents the works described in the accompanying application, together with the location of streams and other ditches in the immediate vicinity and has written thereon the area in each smallest legal subdivision which it is proposed to irrigate.

W. A. Griffing
 Civil Engr.

4089

Partial Cancellation of Silvies River Decree (1926) Point of Diversion Map

Silvies Valley Ranch

Grant County

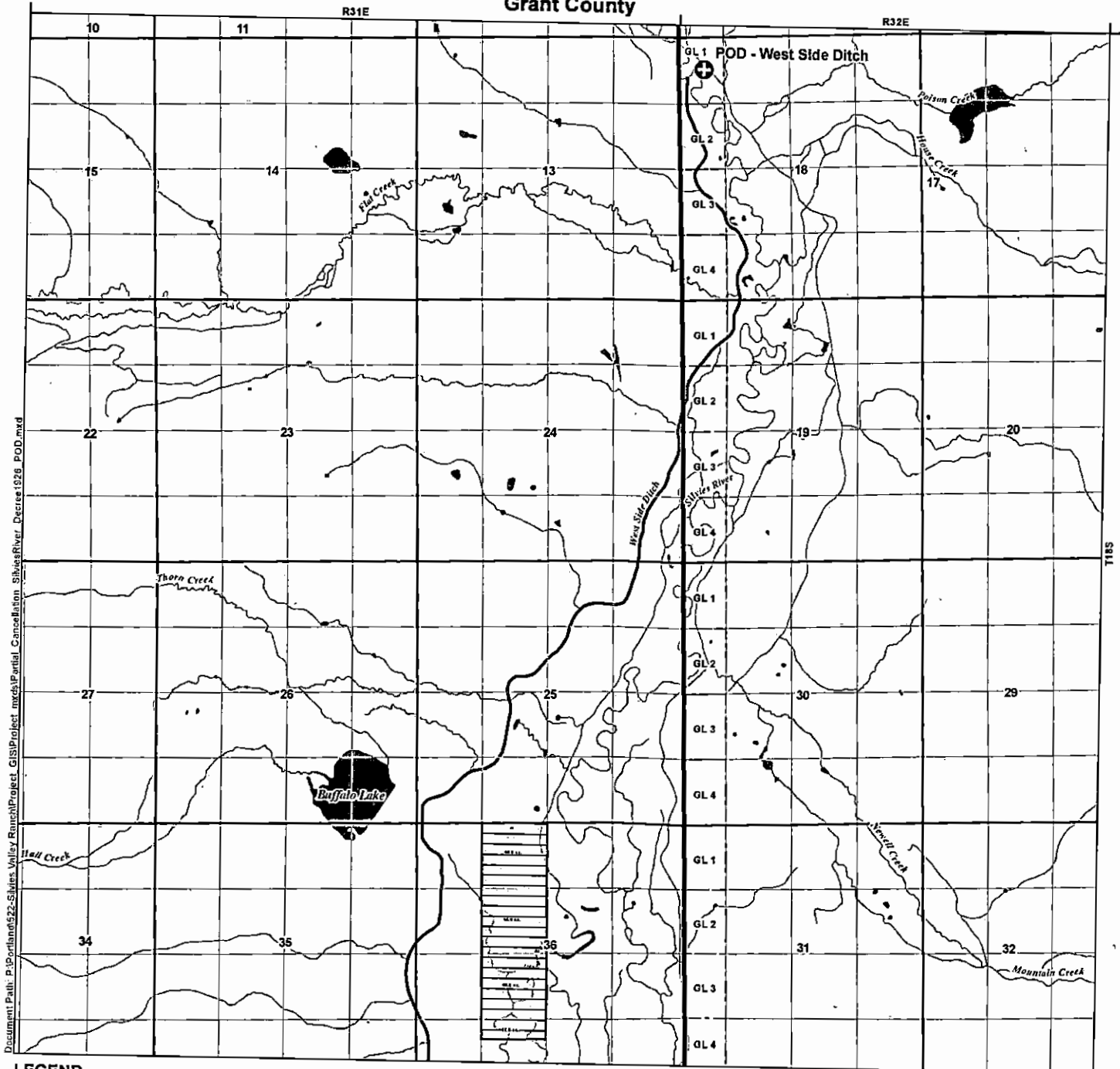

Document Path: P:\gortlan022\Silvies Valley Ranch\Project_GIS\Project_mxd\Partial_Cancellation_SilviesRiver_Decree1926_POD.mxd

LEGEND

- Authorized Point of Diversion (POD)
- Silvies River Decree (1926), POU***
- Acreage to be Cancelled
- All Other Features**
- West Side Ditch
- Watercourse
- Waterbody

POD LOCATION DESCRIPTION

Authorized Point of Diversion
Located 650 feet South and 510 feet East from the NW corner of Section 18, Township 18 South, Range 32 East (W.M.)

*Place of use shown is only the portion of the water right to be cancelled.

RECEIVED BY OWRD

DEC 22 2017

SALEM, OR

DISCLAIMER
This map was prepared for the purpose of identifying the location of a water right only and it is not intended to provide legal dimensions or location of property ownership lines.

MAP NOTES
Date: December 11, 2017
Data Sources: BLM, USGS, OWRD

