

Section 15, T9S, R1W, W.M.,
Linn County, Oregon

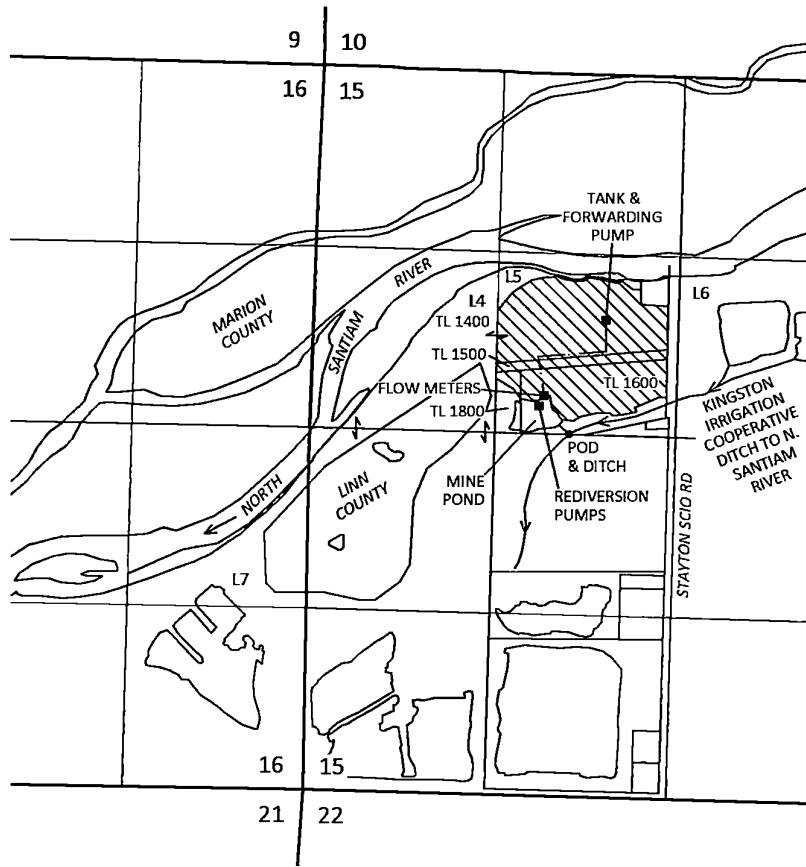



RECEIVED BY OWRD

Application S-70469, Permit S-53479
CLAIM OF BENEFICIAL USE MAP
Knife River Corporation dba Morse Brothers Inc.

AUG 19 2014
SALEM, OR

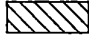

EXPLANATION

-  PLACE OF USE
PRIORITY DATE: JULY 9, 1990
-  POD
-  PUMPS / FLOW METERS
-  PIPELINE

KNIFE RIVER POD LOCATED 770 FT W FROM THE CENTER 1/4 CORNER OF SECTION 15

Site inspection conducted
July 17, 2014

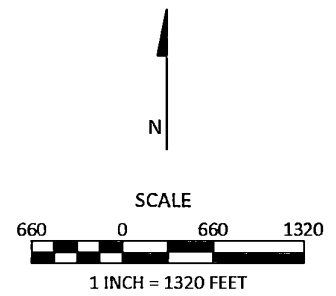

KINGSTON IRRIGATION COOPERATIVE POD
LOCATED 2,630 FT N AND 1,190 FT W FROM
THE S 1/4 CORNER OF SECTION 14

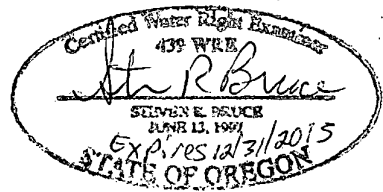
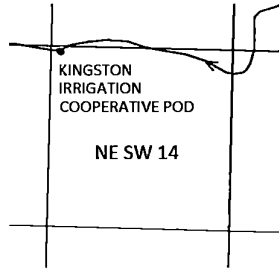

August 4, 2014

This map is not intended to provide legal
dimensions or locations of property
ownership lines

Figure 1

SKOOKUM
WATER ASSOCIATES INC
P.O. BOX 80174
PORTLAND, OR 97280
(503) 319-8926