

**CLAIM OF BENEFICIAL USE MAP TO ADD  
ADDITIONAL POINT OF DIVERSION ON MILL  
CREEK IN SECTION 15, T.14S., R.17E., W.M.,  
CROOK COUNTY, OREGON**

**W.O. 17-4957 TAX LOT 1701-14-17**

**PREPARED FOR**

ML BELLA RANCH LLC  
SKIDMORE LP  
C/O MIKE HASHEM  
PO BOX 707  
BEAVERCREEK, OR 97004  
503-593-9870

**PREPARED BY**

DAVID B. ARMSTRONG, CWRE 145  
ARMSTRONG SURVEYING  
& ENGINEERING, INC.  
267 NE SECOND ST. STE. 100  
PRINEVILLE, OR 97754  
(541) 447-7791

T-11135  
KRR/WRD

**LEGEND**

- ◆ 2-1/2" ALUMINUM CAP - CORNER FORM  
APRIL 29, 1998
- ① ADDITIONAL POINT OF DIVERSION
- ⊗ CERTIFICATE 75205 - ADDITIONAL POD LANDS  
ALONG WITH DITCH POD
- ▨ CERTIFICATE 75205 - NO ADDITIONAL POD LANDS  
DITCH POD ONLY
- M WATER METER LOCATION
- S FISH SCREEN LOCATION

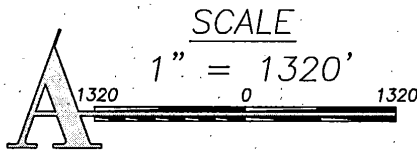

AUGUST 3, 2017  
REVISED SEPTEMBER 19, 2017

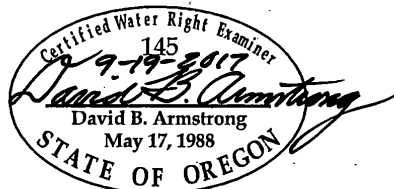

Renews December 31, 2017

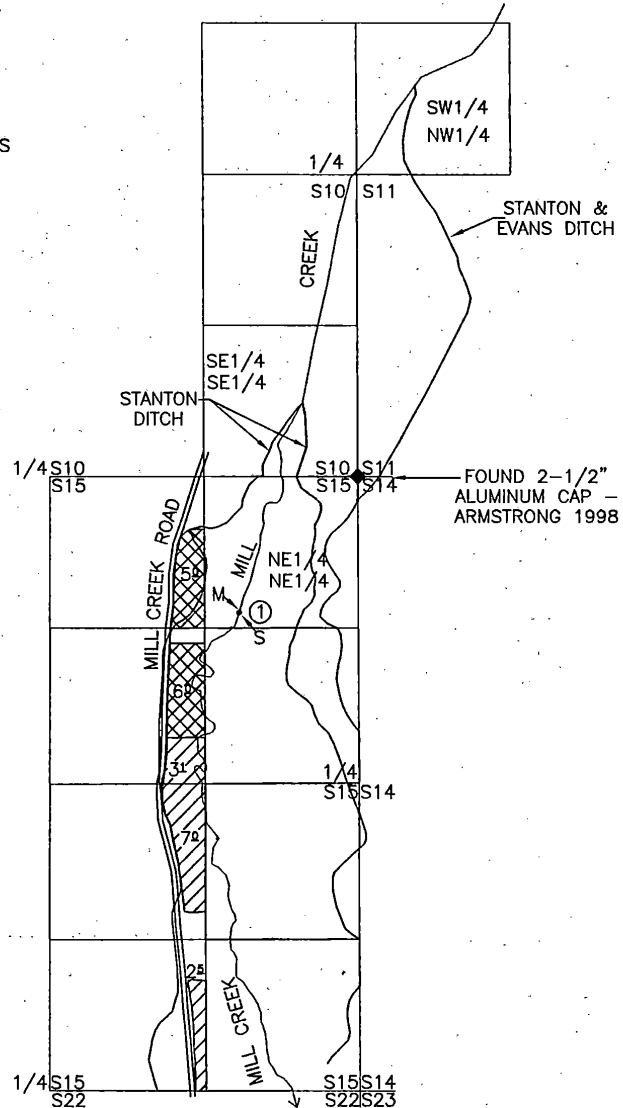

**ADDITIONAL POINTS OF DIVERSION**

- NO. 1 - NE1/4 OF THE NE1/4; 1190 FT. SOUTH & 1040 FT. WEST OF NE  
CORNER SEC. 15, T.14S., R.17E., W.M.  
HANDHELD GPS TIES  
(N) 44.358778' (W) 120.669833' 1190 FT. SOUTH & 1040 FT. WEST  
NE SECTION 15  
(N) 44.362028' (W) 120.665861' 2-1/2" ALUMINUM CAP - BASE  
STANTON DITCH  
(N) 44.363806' (W) 120.667611' 660 FT. NORTH & 460 FT. WEST

OCT 2 2017

SALEM, OR



**SURVEY NOTE**

THE PREPARATION OF THIS MAP IS FOR THE PURPOSE OF  
IDENTIFYING THE LOCATION OF THE WATER RIGHT ONLY AND  
HAS NO INTENT TO PROVIDE DIMENSIONS OR LOCATIONS OF  
PROPERTY OWNERSHIP LINES.

SHEET 1 OF 3  
DRG. NO. 07-3683.DWG  
W.O. 17-4957