

T-4529

RECEIVED

JUN 2 1980

WATER RESOURCES DEPT
SALEM, OREGON

SEC
11

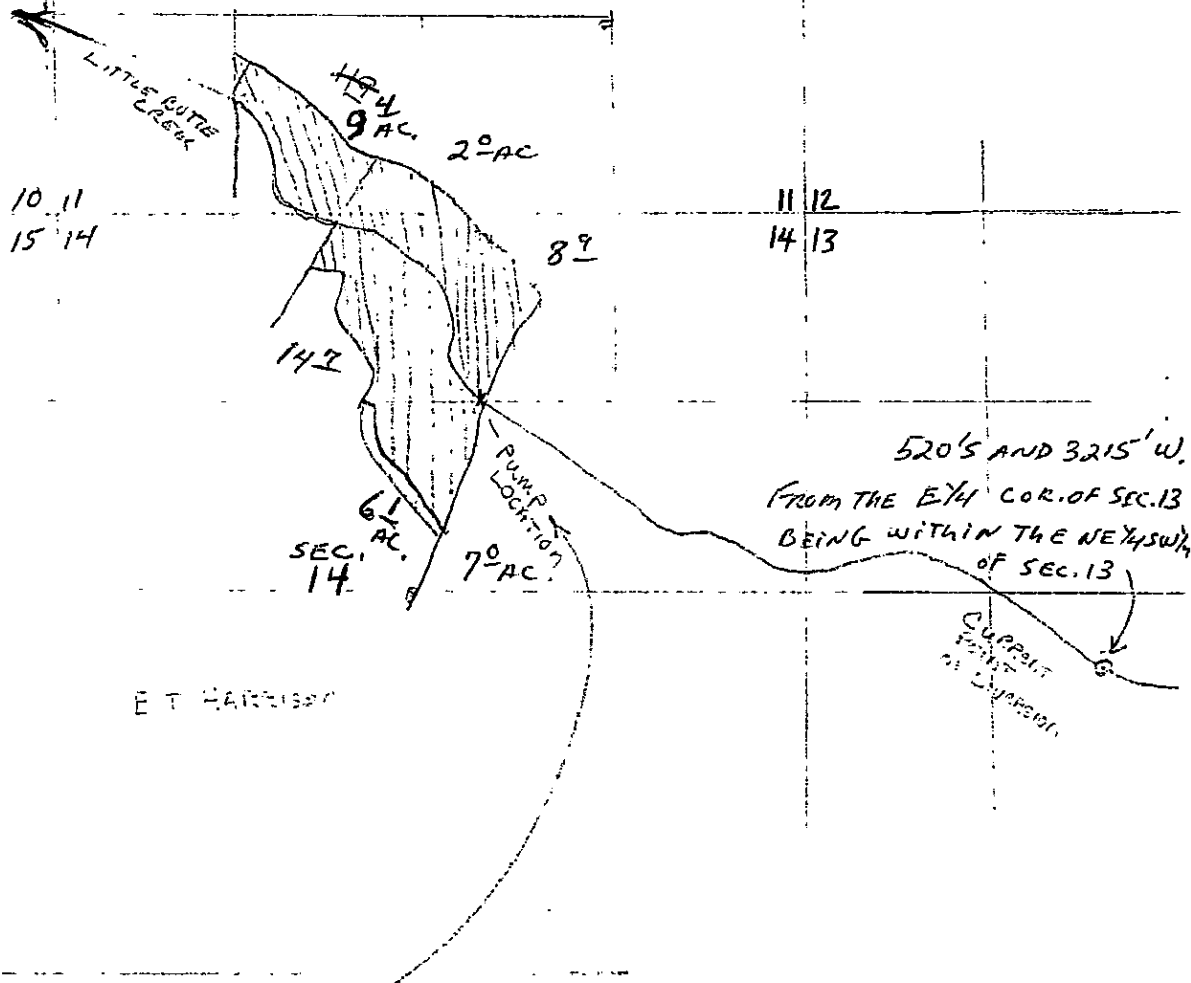

SEC.
15

E T HARRISON

PROPOSED $\frac{1}{2}$
 DIV. PT. 1150'S AND 440'E. FROM N $\frac{1}{4}$ COR. OF
 SEC. 14
 TOWNSHIP 36 S RANGE 1 E WM
 JACKSON COUNTY, OREGON

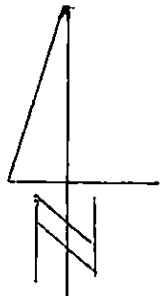

5-30-80



T. 36 S., R. 1 E., W.M.

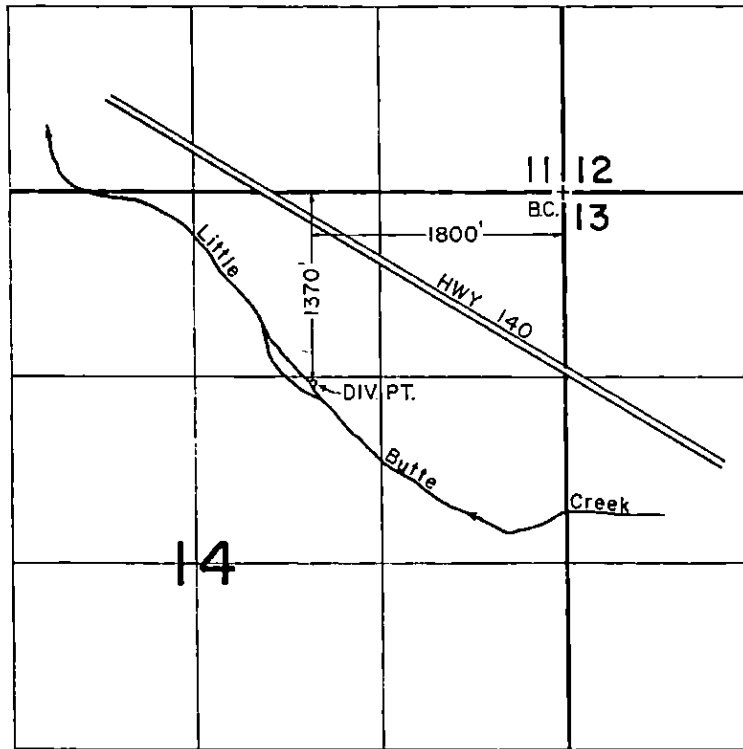

SCALE: 1" = 1320'

FINAL PROOF SURVEY

UNDER

TRANSFER NO. 4529

Application No. Permit No.

IN NAME OF

..... EDWARD T. HARRISON, JR.

Surveyed MAY 31, 1989, by B. S. JAMES

This map identifies the new POD WRD/MFB
3-9-18

12-11-89
41029-279-172 L