

Sections 2, 3, 4, 8, 9, 10, 11, 16, 17, 20, & 21, T4N, R25E,
 Sections 6, 7 & 8, T4N, R26E, W.M.
 Morrow County, Oregon

Application S-53657, Permit S-40336
 SECOND PARTIAL-PERFECTION CLAIM OF BENEFICIAL USE MAP
 City of Boardman

RECEIVED BY OWRD

OCT 17 2017

SALEM, OR

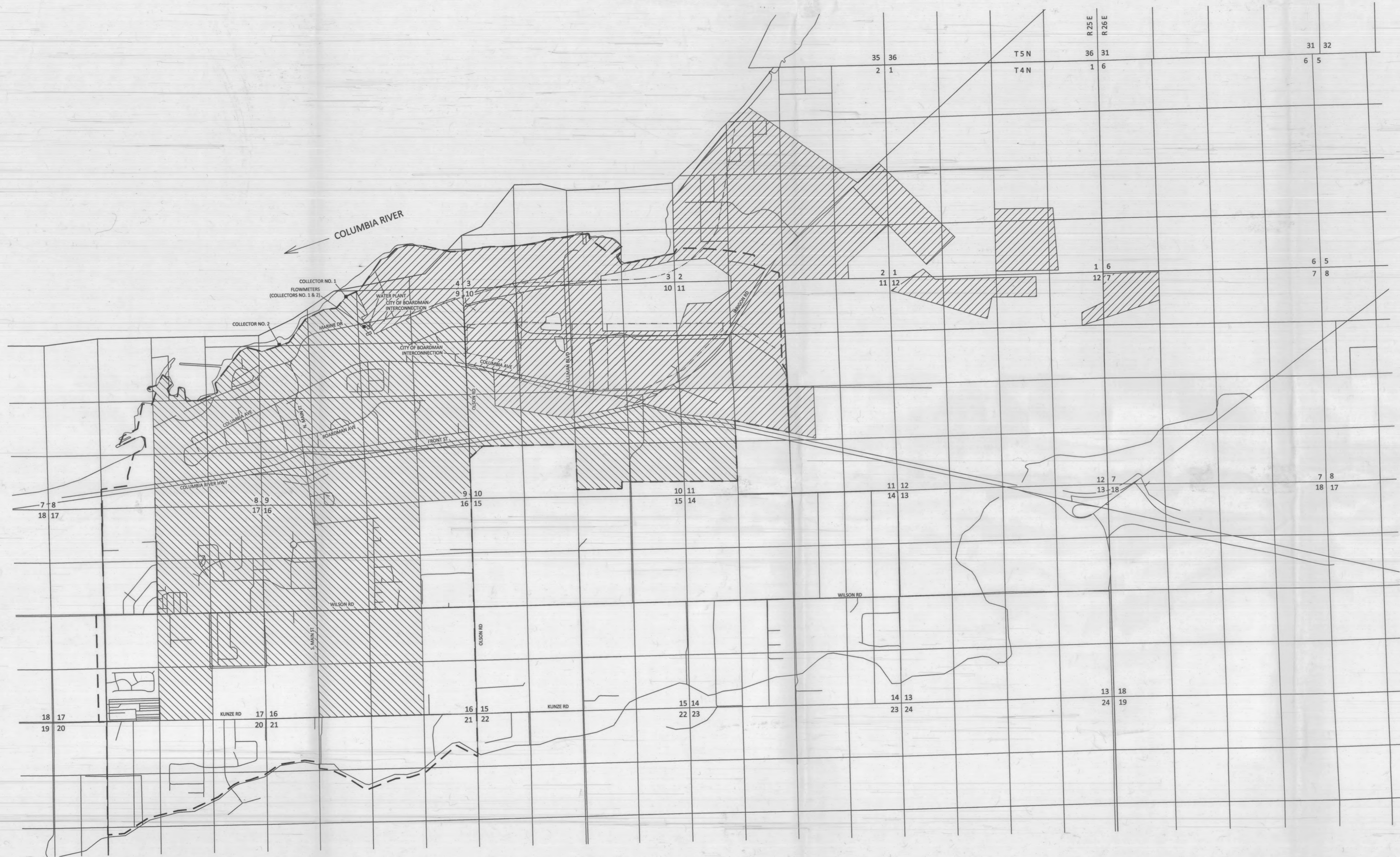

- EXPLANATION**
- CITY OF BOARDMAN PLACE OF USE
PRIORITY: 8/22/1975
 - PORT OF MORROW PLACE OF USE
PRIORITY: 8/22/1975
 - URBAN GROWTH BOUNDARY
 - COLLECTOR / FLOWMETER
 - PIPELINE (APPROX.)
- COLLECTOR NO. 1 LOCATION: 2900 FT W AND 170 FT S FROM THE NE CORNER OF SECTION 9
 COLLECTOR NO. 2 LOCATION: 4580 FT W AND 1340 FT S FROM THE NE CORNER OF SECTION 9
 FLOWMETER LOCATION: 2460 FT W AND 520 FT S FROM THE NE CORNER OF SECTION 9

Site inspection conducted
 July 20, 2017

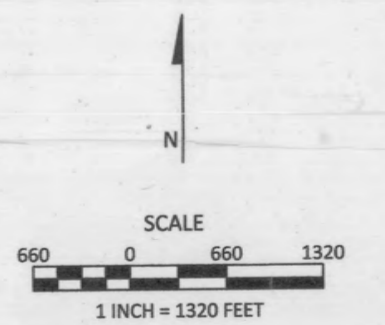

COBU MAP# 1103

COBU MAP# 1103

COBU MAP# 1103

September 22, 2017
 This map is not intended to provide legal dimensions or locations of property ownership lines

FIGURE 1