

RECEIVED

APR 17 2018

OWRD

# revised CLAIM OF BENEFICIAL USE MAP

FOR: RIVER BEND WEST IRRIGATION ASSOCIATION

BY: NATHAN R. REED, CWRE

T26S, R6&7W, W.M.

TRANSFER NO. T11202

DATE SURVEYED: JULY 8, 2014

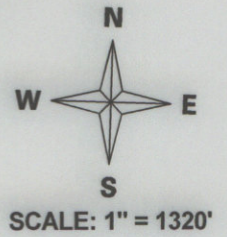

POD#B IS LOCATED 416 FEET NORTH AND 468 FEET EAST FROM THE SW CORNER OF SECTION 7  
 POD#A IS LOCATED 605 FEET NORTH AND 469 FEET EAST FROM THE SW CORNER OF SECTION 7

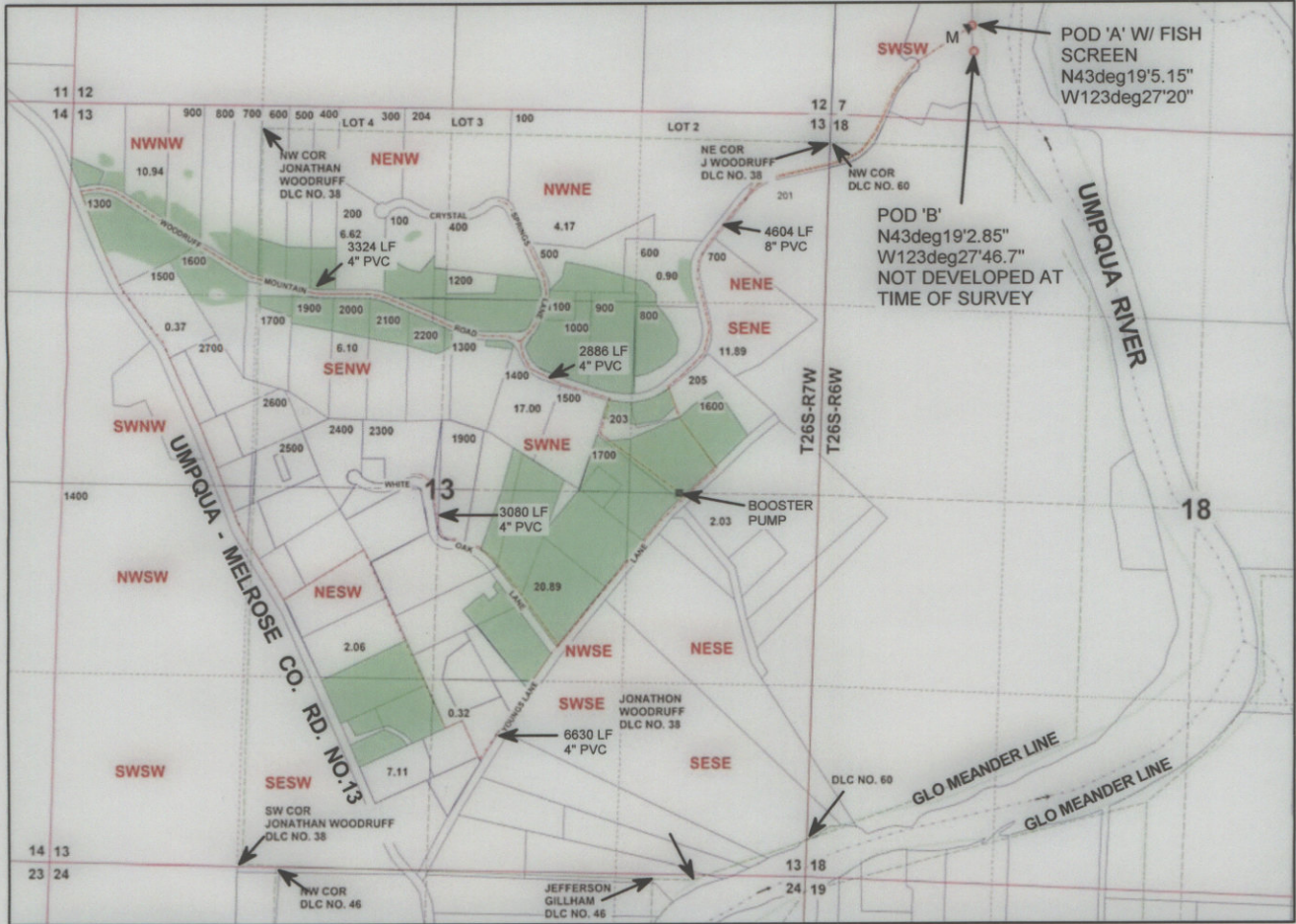

### Legend

- |  |            |  |                 |  |           |
|--|------------|--|-----------------|--|-----------|
|  | River      |  | Irrigation Area |  | DLC       |
|  | POD        |  | Water_Tank      |  | Section   |
|  | PUMP       |  | Roads           |  | Quarter   |
|  | Meter      |  | Meander         |  | Sixteenth |
|  | Pipeline   |  | Gov_Lot         |  | Parcels   |
|  | Pump House |  | Township        |  |           |

MAP PREPARED FOR:  
 RIVER BEND WEST IRRIG. ASSOC.  
 PO BOX 1304  
 ROSEBURG, OR 97470

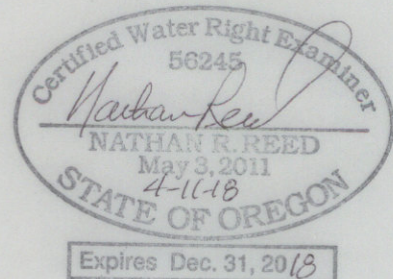

THE PURPOSE OF THIS MAP IS TO IDENTIFY THE LOCATION OF THE WATER RIGHT. IT IS NOT INTENDED TO PROVIDE INFORMATION RELATIVE TO THE LOCATION OF PROPERTY OWNERSHIP BOUNDARY LINES.

MAP PREPARED BY:  
 NATHAN R. REED, P.E., CWRE  
 1113 SE CASS AV  
 ROSEBURG, OR 97470

