

T8S, R40E, Section 10, W.M.

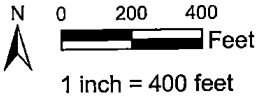
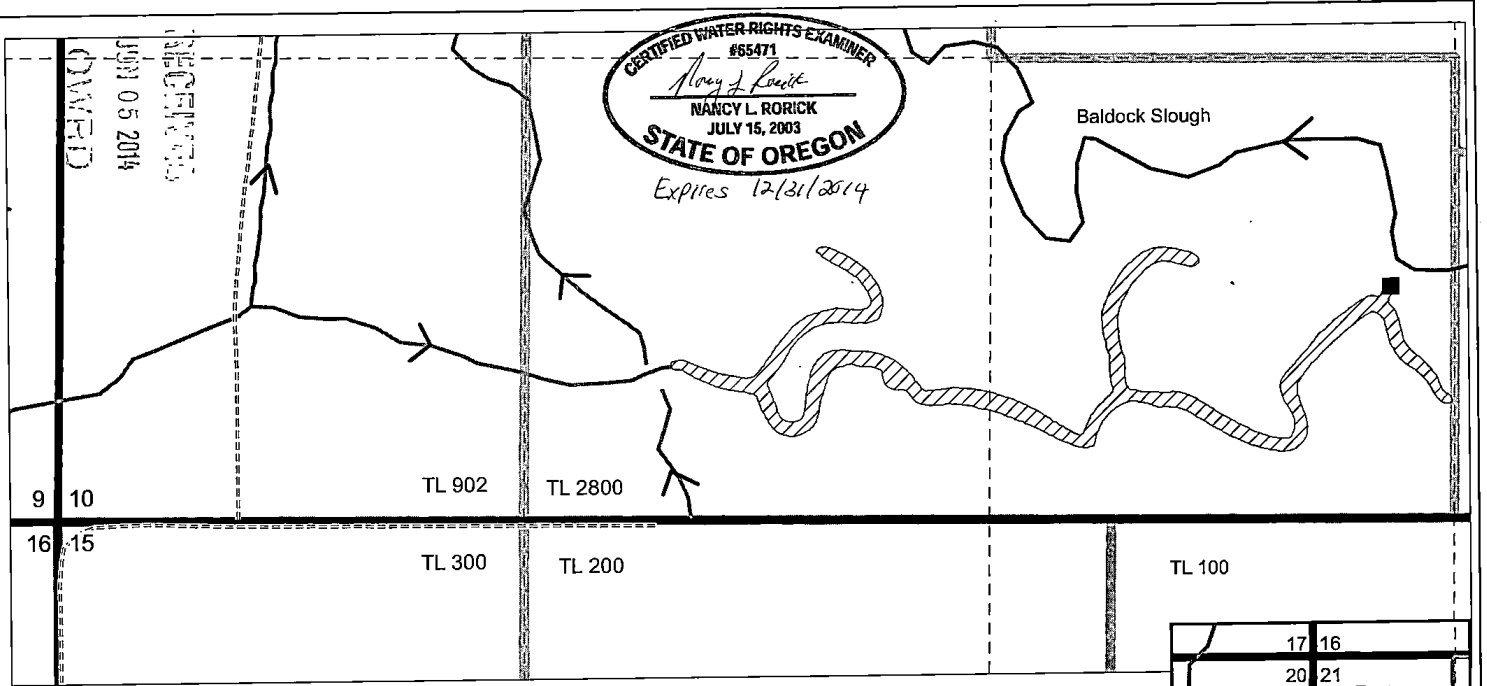

- Pond E
- POD
- Weir and measuring point
- Tax lot line
- Quarter quarter line
- Section line
- River
- Dirt road
- Ditch / Constructed waterway

Claim of Beneficial Use, Pond E  
Permit R13083 and Application R84547  
Tax Lot 2800  
Baldock Slough, LLC  
map prepared by  
Nancy Rorick Consulting

This map is not intended to provide legal dimensions or locations of property ownership lines.

The Perkins Ditch POD on the Powder River is located 2660 feet south and 140 feet west of the NE corner of Section 20, T8S, R40E.

The dam for pond E is located 1500 feet west and 680 feet north of the southeast corner of Section 10, T8S, R40E.

