

**Claim of Beneficial Use
Transfer T-11481 (Permit R-5964)**
Water Right in the Name of Port of Portland
Multnomah County
Township 1 North, Range 3 East (W.M.)

Cert 45429
store SW in reservoir

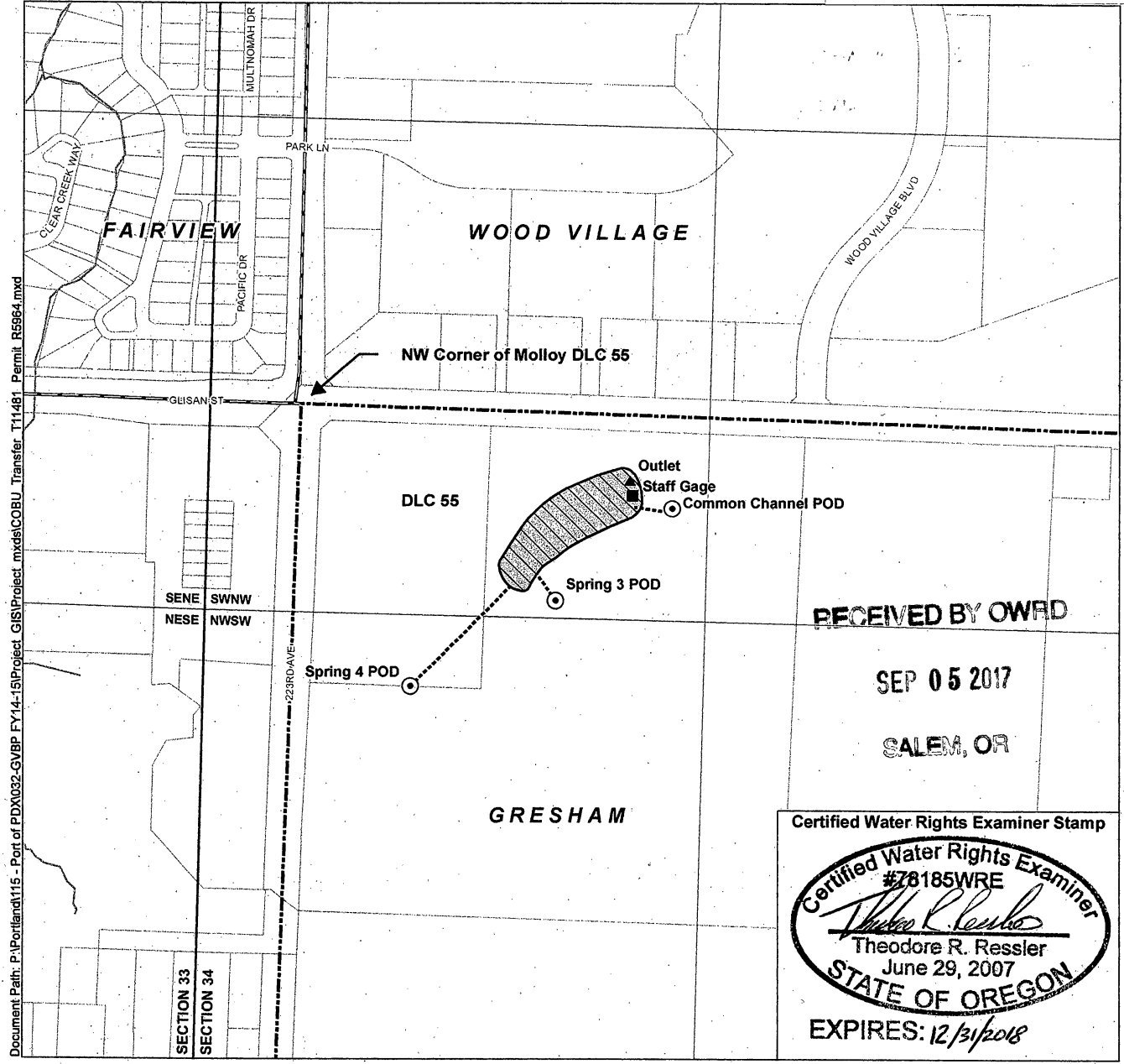

Document Path: P:\Portland\115 - Port of PDX\032-GVBP FY14-15\Project_GIS\Project.mxd\COBU_Transfer_T11481_Permit_R5964.mxd

RECEIVED BY OWRD

SEP 05 2017

SALEM, OR

Certified Water Rights Examiner Stamp

Certified Water Rights Examiner
 #78185WRE
Theodore R. Ressler
 Theodore R. Ressler
 June 29, 2007
STATE OF OREGON
 EXPIRES: 12/31/2018

LEGEND

- Point of Diversion (POD)
- Place of Use (POU)
- System Mainline
- City Limit
- Tax Lot
- Donation Land Claim (DLC)
- Watercourse

POD Location Descriptions

Common Channel POD
240 feet South and 1,000 feet East from the NW corner of Molloy DLC 55, Section 34, Township 1 North, Range 3 East (W.M.)

Spring 3 POD
500 feet South and 700 feet East from the NW corner of Molloy DLC 55, Section 34, Township 1 North, Range 3 East (W.M.)

Spring 4 POD
750 feet South and 330 feet East from the NW corner of Molloy DLC 55, Section 34, Township 1 North, Range 3 East (W.M.)

Disclaimer

This map was prepared for the purpose of identifying the location of a water right only and it is not intended to provide legal dimensions or location of property ownership lines.

Map Notes

Date: June 23, 2015
Data Sources: OWRD, METRO RLIS, OGIC
Prepared By: GSI Water Solutions, Inc.

0 200 400
 Feet

GSI
 Water Solutions, Inc.