

COBU 1 of 3
 cert 87783

Claim of Beneficial Use Transfer T-11481 (Permit G-15170)

Water Right in the Name of Port of Portland
 Multnomah County
 Township 1 North, Range 3 East (W.M.)

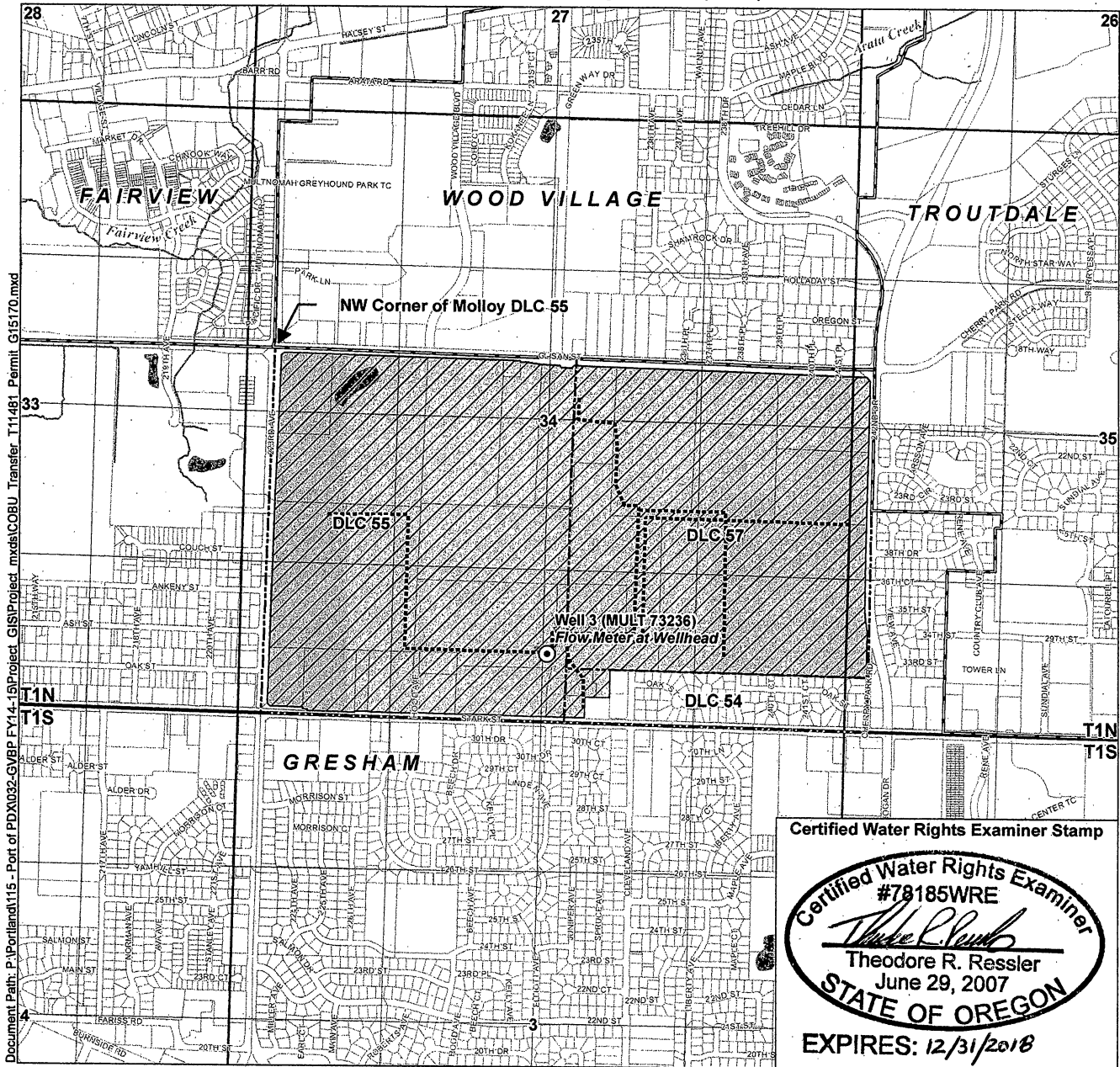

Document Path: P:\Portland\115 - Port of PDX\032_GVBP_FY14-15\Project_GIS\Project_mxd\COBU_Transfer_T11481_Permit_G15170.mxd

- LEGEND**
- Point of Appropriation (POA)
 - Place of Use (POU)
- Gresham Vista Business Park
 - System Mainline
 - City Limit
 - Tax Lot
 - Donation Land Claim (DLC)
 - Waterbody
 - Watercourse

POA Location Descriptions

Well 3
 Located 585 feet North and 50 feet East from the South 1/4 corner of Section 34, Township 1 North, Range 3 East (W.M.).

Certified Water Rights Examiner Stamp

Certified Water Rights Examiner
 #78185WRE

 Theodore R. Ressler
 June 29, 2007
 STATE OF OREGON
 EXPIRES: 12/31/2018

Disclaimer
 This map was prepared for the purpose of identifying the location of a water right only and it is not intended to provide legal dimensions or location of property ownership lines.

RECEIVED BY OWRD

SEP 05 2017
 SALEM, OR

Map Notes
 Date: June 29, 2015
 Data Sources: OWRD, METRO RLIS, OGIC
 Prepared By: GSI Water Solutions, Inc.

